

PHO 675113

UNITED STATES DEPARTMENT OF THE INTERIOR  
NATIONAL PARK SERVICE

FOR NPS USE ONLY	
RECEIVED	APR 11 1979
DATE ENTERED	MAY 18

**NATIONAL REGISTER OF HISTORIC PLACES  
INVENTORY -- NOMINATION FORM**

SEE INSTRUCTIONS IN *HOW TO COMPLETE NATIONAL REGISTER FORMS*  
TYPE ALL ENTRIES -- COMPLETE APPLICABLE SECTIONS

**1 NAME**

HISTORIC  
Smart-Griffin House

AND/OR COMMON  
Angeletty House

**2 LOCATION**

STREET & NUMBER  
180 St. Catherine Street

NOT FOR PUBLICATION  
CONGRESSIONAL DISTRICT  
Fourth

CITY, TOWN  
Natchez

VICINITY OF

STATE  
Mississippi

CODE  
28

COUNTY  
Adams

CODE  
1

**3 CLASSIFICATION**

CATEGORY	OWNERSHIP	STATUS	PRESENT USE	
<input type="checkbox"/> DISTRICT	<input checked="" type="checkbox"/> PUBLIC	<input type="checkbox"/> OCCUPIED	<input type="checkbox"/> AGRICULTURE	<input type="checkbox"/> MUSEUM
<input checked="" type="checkbox"/> BUILDING(S)	<input type="checkbox"/> PRIVATE	<input type="checkbox"/> UNOCCUPIED	<input type="checkbox"/> COMMERCIAL	<input type="checkbox"/> PARK
<input type="checkbox"/> STRUCTURE	<input type="checkbox"/> BOTH	<input checked="" type="checkbox"/> WORK IN PROGRESS	<input type="checkbox"/> EDUCATIONAL	<input type="checkbox"/> PRIVATE RESIDENCE
<input type="checkbox"/> SITE	<b>PUBLIC ACQUISITION</b>	<b>ACCESSIBLE</b>	<input type="checkbox"/> ENTERTAINMENT	<input type="checkbox"/> RELIGIOUS
<input type="checkbox"/> OBJECT	<input type="checkbox"/> IN PROCESS	<input checked="" type="checkbox"/> YES: RESTRICTED	<input type="checkbox"/> GOVERNMENT	<input type="checkbox"/> SCIENTIFIC
	<input type="checkbox"/> BEING CONSIDERED	<input type="checkbox"/> YES: UNRESTRICTED	<input type="checkbox"/> INDUSTRIAL	<input type="checkbox"/> TRANSPORTATION
		<input type="checkbox"/> NO	<input type="checkbox"/> MILITARY	<input checked="" type="checkbox"/> OTHER: None

**4 OWNER OF PROPERTY**

NAME  
City of Natchez

STREET & NUMBER  
110 South Wall Street

CITY, TOWN  
Natchez

VICINITY OF

STATE  
Mississippi 39120

**5 LOCATION OF LEGAL DESCRIPTION**

COURTHOUSE, OFFICE OF THE CHANCERY CLERK  
REGISTRY OF DEEDS, ETC. Adams County Courthouse

STREET & NUMBER  
Courthouse Square

CITY, TOWN  
Natchez

STATE  
Mississippi 39120

**6 REPRESENTATION IN EXISTING SURVEYS**

TITLE  
Adams County Landmarks Inventory

DATE  
1974-1977  
 FEDERAL  STATE  COUNTY  LOCAL

DEPOSITORY FOR SURVEY RECORDS  
Natchez Metropolitan Planning Commission

CITY, TOWN  
Natchez

STATE  
Mississippi 39120

# 7 DESCRIPTION

CONDITION		CHECK ONE	CHECK ONE
<input type="checkbox"/> EXCELLENT	<input checked="" type="checkbox"/> DETERIORATED	<input type="checkbox"/> UNALTERED	<input checked="" type="checkbox"/> ORIGINAL SITE
<input type="checkbox"/> GOOD	<input type="checkbox"/> RUINS	<input checked="" type="checkbox"/> ALTERED	<input type="checkbox"/> MOVED      DATE _____
<input type="checkbox"/> FAIR	<input type="checkbox"/> UNEXPOSED		

---

## DESCRIBE THE PRESENT AND ORIGINAL (IF KNOWN) PHYSICAL APPEARANCE

The Smart-Griffin House in Natchez is a well-proportioned one-and-a-half story brick house with double chimneys and gable ends. Its original symmetrical facade has been mutilated and obscured by a nondescript one-story flat-roofed concrete-block store building that was constructed some time after 1910. The recessed central-entrance doorway was originally flanked by two large double-hung windows on each side. The only one remaining is to the left of the doorway, the other one on the left having been converted to a door and the front wall on the right having been entirely removed. The remaining front window, like those on the sides and rear of the house, has a brick jack arch above it, a heavy wood sill, and sash divided by slender muntins into six lights above and below. Prior to the construction of the store building, the house may have had a small entrance porch. The size and exact location of the porch and the character of the front cornice of the house will probably be revealed upon removal of the store. The entrance door is flanked by tall narrow side lights separated from the door by slender mullions. Above the door is a simple rectangular three-light transom. The door itself has been removed but was probably similar to the four-panel doors on the interior. There are indications that the doorway recess may have had a battered eared casing like those of the interior openings.

The two chimneys on each of the parapeted gable-end walls are spaced rather close together and the attic opening between them is slightly off center. The door in the attic opening in each gable has been changed and reduced in size, but the beaded door frame that extends to the attic floor appears to be original. These doors opened onto small balconies, of which only ruinous fragments now remain. Each gable end has two double-hung windows on the first floor, unrelated to the attic opening above.

The rear or south facade of the house, like the front, has a central doorway but with only one window to each side. The doorway is unusual, having a single wide side light on one side of the door rather than two narrow ones as at the front entrance. Its transom has two lights. At the southeast corner of the house, and separated from it by a narrow passageway with steps leading to the ground, is a rather small rectangular room with brick-veneered walls, a chimney, and a nearly flat shed roof. The room was probably built as a kitchen after 1910, since a map of Natchez for that year shows the house with a rather narrow open gallery across the entire rear facade. Several outbuildings are also shown, one of which may have been the original kitchen. The shed roof, like the front and rear slopes of the main roof, is covered with corrugated metal roofing and extends across the entire rear facade of the house, covering a weatherboarded bathroom at the southeast corner. The bathroom has a tile floor and plastered walls and ceiling and may have been added at the same time as the kitchen or possibly a few years later. The gallery between these two rooms and between the bathroom and the house has been crudely enclosed. The land on which the house is built slopes sharply downward to the rear, resulting in a nearly full basement story across the back. The brick veneer of the walls of the kitchen room extend to the ground as eight-inch brick walls while brick piers support the gallery and bathroom.

Perhaps the most distinctive exterior features of the house are the two large dormers centered one in the front roof slope and one in the rear. The front dormer, an exceptionally fine example of the Gothic Revival style, has wide overhanging eaves supported on elaborate wood jigsaw brackets with cut-out trefoil designs along the sides and large curved brackets on the front. The jigsaw vergeboard is scalloped and carved with rosettes and crockets terminating in a pendant that may once have extended above the roof as a finial. The center lancet window with Gothic tracery is flanked by narrower side lancet sash divided by heavy

UNITED STATES DEPARTMENT OF THE INTERIOR  
NATIONAL PARK SERVICE

**NATIONAL REGISTER OF HISTORIC PLACES  
INVENTORY -- NOMINATION FORM**

FOR NPS USE ONLY	
RECEIVED	APR 11 1979
DATE ENTERED	MAY 18 1979

CONTINUATION SHEET

ITEM NUMBER 6 & 7 PAGE 1

6 - REPRESENTATION IN EXISTING SURVEYS

Title: Statewide Survey of Historic Sites   X   State  
Date: May 12, 1978  
Depository for Survey Records: Mississippi Department of Archives and History  
City: Jackson State: Mississippi 39205

7 - DESCRIPTION

muntins. The lower part of the center window consists of a pair of paneled shutters in Gothic design. A similar large triple-sash dormer is centered on the rear slope of the roof, but its wide overhanging eaves are without the elaborate jigsaw ornamentation found on the front, and its double-hung center and side windows are divided into conventional rectangular lights by narrow muntins.

In plan, the house has a rather narrow central hall with two rooms to each side. On the left side of the hall, the stairway with turned newel and balusters extends in a single flight to the attic story, where the handrail curves gracefully around the stairwell. Although the handrail has been broken down by vandals, enough parts remain to reconstruct it. There is a single room to each side of the center hall of the attic, each room having a single opening in the gable-end wall. The wall of the attic hall splays slightly and its ceiling slopes up towards the front to accommodate the large dormer windows. The front rooms on the first floor are nearly square; the rear rooms are slightly smaller. Each room has a fireplace with a projecting chimney breast on the outer wall and a window on one side towards the rear. Wood mantels are of simple Greek Revival design. Those in the front rooms have a heavy broad entablature supported on slightly tapered pilasters. The mantels in the two rear rooms have typical Greek Revival eared or crossett trim. Door and window casings are battered, eared, and molded, the window casings extending to the floor, with a panel below the sash. The doors have four vertical panels, two tall ones above and two smaller ones below a wide lock rail. The door to one of the attic rooms has two full-length vertical panels and may have come from an earlier building.

# 8 SIGNIFICANCE

PERIOD	AREAS OF SIGNIFICANCE -- CHECK AND JUSTIFY BELOW			
<input type="checkbox"/> PREHISTORIC	<input type="checkbox"/> ARCHEOLOGY-PREHISTORIC	<input type="checkbox"/> COMMUNITY PLANNING	<input type="checkbox"/> LANDSCAPE ARCHITECTURE	<input type="checkbox"/> RELIGION
<input type="checkbox"/> 1400-1499	<input type="checkbox"/> ARCHEOLOGY-HISTORIC	<input type="checkbox"/> CONSERVATION	<input type="checkbox"/> LAW	<input type="checkbox"/> SCIENCE
<input type="checkbox"/> 1500-1599	<input type="checkbox"/> AGRICULTURE	<input type="checkbox"/> ECONOMICS	<input type="checkbox"/> LITERATURE	<input type="checkbox"/> SCULPTURE
<input type="checkbox"/> 1600-1699	<input checked="" type="checkbox"/> ARCHITECTURE	<input type="checkbox"/> EDUCATION	<input type="checkbox"/> MILITARY	<input type="checkbox"/> SOCIAL/HUMANITARIAN
<input type="checkbox"/> 1700-1799	<input type="checkbox"/> ART	<input type="checkbox"/> ENGINEERING	<input type="checkbox"/> MUSIC	<input type="checkbox"/> THEATER
<input checked="" type="checkbox"/> 1800-1899	<input type="checkbox"/> COMMERCE	<input type="checkbox"/> EXPLORATION/SETTLEMENT	<input type="checkbox"/> PHILOSOPHY	<input type="checkbox"/> TRANSPORTATION
<input type="checkbox"/> 1900-	<input type="checkbox"/> COMMUNICATIONS	<input type="checkbox"/> INDUSTRY	<input type="checkbox"/> POLITICS/GOVERNMENT	<input type="checkbox"/> OTHER (SPECIFY)
		<input type="checkbox"/> INVENTION		

SPECIFIC DATES *1833-1850; 1910* BUILDER/ARCHITECT

## STATEMENT OF SIGNIFICANCE

The Smart-Griffin House is a notable Natchez Greek Revival residence, its Gothic Revival dormer giving it a unique character. It is one of the few remaining early buildings in its vicinity, and when restored to its original appearance and landscaped, it will be of undoubted significance in establishing the quality of the renewed St. Catherine Street neighborhood. The design of the Smart-Griffin House appears influenced by similar houses erected in Natchez by Gemmell and Neibert, a prominent firm of architect-builders practicing in the 1830s. Its architectural significance is in its good proportions, mass and form, and the quality of its Greek Revival detailing. The curious juxtaposition of the Gothic Revival dormer above the Greek Revival house adds a singular element of interest. Although the large dormer is out of scale and its Gothicism at variance with the simple Greek Revival character of the house, the excellence of its whimsical design and detail distinguish it as perhaps the best expression of the Gothic to be found in Natchez.

The site upon which the house stands has had an interesting succession of owners. It is part of a Spanish grant of 242 Spanish acres made on September 10, 1794, to the Spanish governor of Natchez, Manuel Gayoso de Lemos, and confirmed by the United States in September, 1805, to Job Routh under Certificate No. 569. Lewis Evans acquired 200.7 acres from Jeremiah Routh on January 1, 1806 (Deed Book D, folio 183) and sold a portion of it to Peter Paul on April 8, 1814 (Deed Book H, folio 80). Peter Paul also acquired other land in the area. On December 12, 1836, his heir, Nancy Paul, had part of the land surveyed and divided into ten lots (Deed Book Y, folio 169). The property, with its house, was purchased for \$2000 on January 11, 1919, by E. C. Angeletty from L. T. Griffin, who had inherited it from his mother, Mrs. Mary Ellen Griffin (Mary Ellen Smart), by will dated May 20, 1882. It was then described as the lot and premises adjoining the property of someone named Stead. William Stead had acquired the adjacent lot (Lot 9 of the Nancy Paul lots) in two parts in 1847 and 1849. Thus, the Smart-Griffin House was built on what was Lot 10 of the ten Nancy Paul lots that had been sold by her in 1836. The purchaser of Lot 10 was Ann Paul, wife of Frederick S. Phelps. An 1840 survey showed the property occupied by "Phelp's Store"; it was described in the sale of the adjacent property in 1841 as belonging to C. L. Phelps (husband of Pascalina Paul). It has been impossible, so far, to trace the chain of title to determine when the property passed from the Phelps ownership or when it was acquired by the Smart and Griffin families. George Smart, grandfather of L. T. Griffin, had purchased another of the Nancy Paul lots on June 30, 1842 (Deed Book D, folio 331). It is in this uncertain period that the present house was probably built, for its character and details suggest a construction date in the late 1840s or early 1850s, with the unusual Gothic Revival dormer being added before or soon after construction was completed. The house may have been built by Phelps or by George Smart (father of Mary Ellen Griffin) or by an unknown interim owner of the property. Its restoration as part of the local Community Development Program is currently underway.

# 9 MAJOR BIBLIOGRAPHICAL REFERENCES

Adams County, Miss. Chancery Clerk. Deed Books D, H, Y.

# 10 GEOGRAPHICAL DATA

ACREAGE OF NOMINATED PROPERTY less than one acre

QUADRANGLE NAME Natchez, Miss.-La.

QUADRANGLE SCALE 1:24000

UTM REFERENCES

A 1,5 6,5,3,0,6,0 3,4,9,2,1,7,0

ZONE EASTING NORTHING

C         

E         

G         

B         

ZONE EASTING NORTHING

D         

F         

H         

## VERBAL BOUNDARY DESCRIPTION

See attached Natchez tax map 30; encircled in red is Parcel 1, Block 4 on which the Smart-Griffin House is located.

## LIST ALL STATES AND COUNTIES FOR PROPERTIES OVERLAPPING STATE OR COUNTY BOUNDARIES

STATE	CODE	COUNTY	CODE
STATE	CODE	COUNTY	CODE

STATE	CODE	COUNTY	CODE
STATE	CODE	COUNTY	CODE

# 11 FORM PREPARED BY

NAME / TITLE

Samuel Wilson, Jr., F.A.I.A., Architect

ORGANIZATION

Koch and Wilson Architects

DATE

March, 1978

STREET & NUMBER

1100 Jackson Avenue

TELEPHONE

504-581-7023

CITY OR TOWN

New Orleans

STATE

Louisiana 70130

# 12 STATE HISTORIC PRESERVATION OFFICER CERTIFICATION

THE EVALUATED SIGNIFICANCE OF THIS PROPERTY WITHIN THE STATE IS:

NATIONAL   

STATE   

LOCAL X

As the designated State Historic Preservation Officer for the National Historic Preservation Act of 1966 (Public Law 89-665), I hereby nominate this property for inclusion in the National Register and certify that it has been evaluated according to the criteria and procedures set forth by the National Park Service.

STATE HISTORIC PRESERVATION OFFICER SIGNATURE

*Edward R. Hilliard*

TITLE State Historic Preservation Officer

DATE April 6, 1979

FOR NPS USE ONLY

I HEREBY CERTIFY THAT THIS PROPERTY IS INCLUDED IN THE NATIONAL REGISTER

ATTEST: *[Signature]*  
CHIEF OF REGISTRATION

*[Signature]*

DATE 3/15/79

DATE 5/17/79

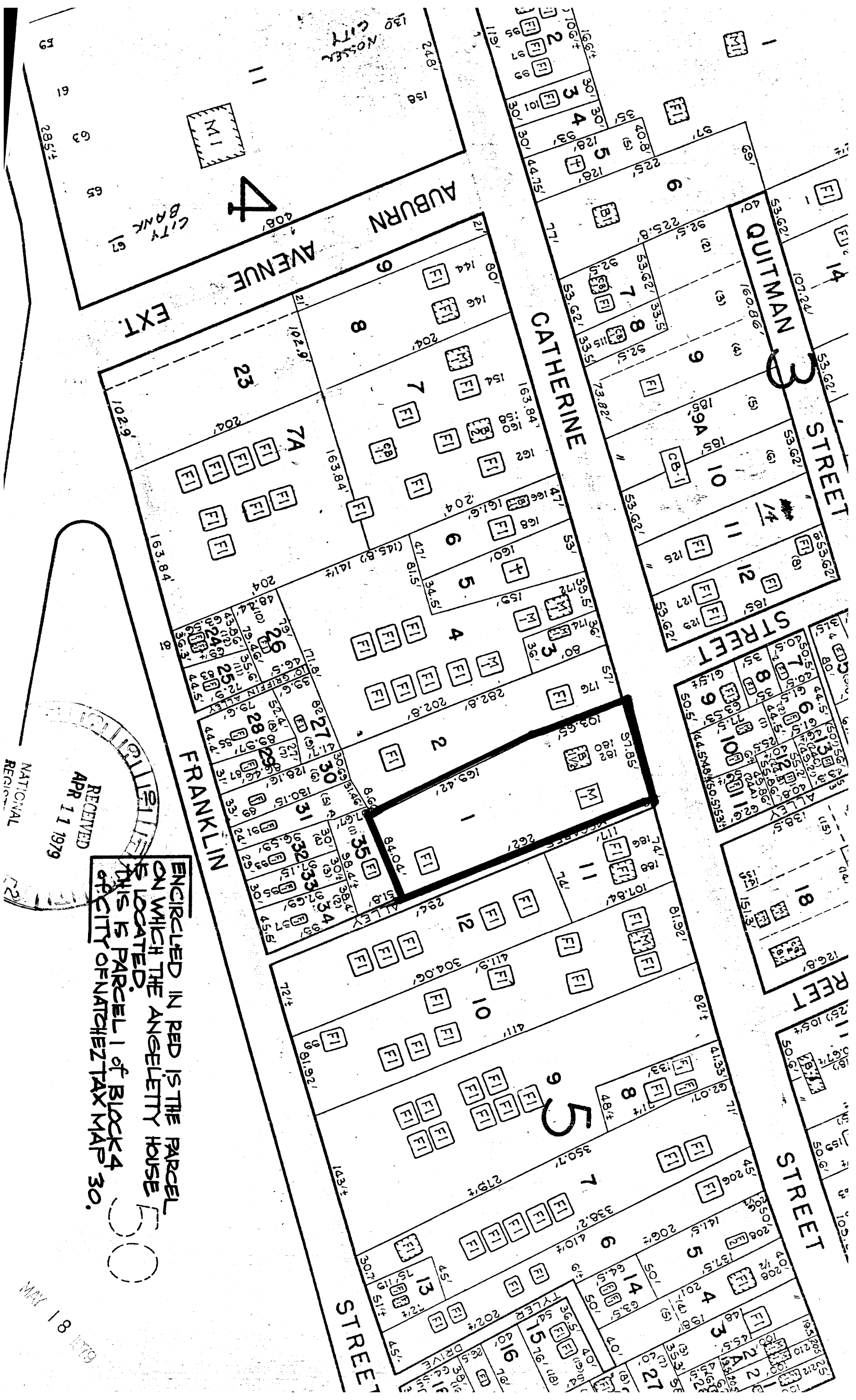

ENCIRCLED IN RED IS THE PARCEL ON WHICH THE ANGELETTY HOUSE IS LOCATED. THIS IS PARCEL 1 of BLOCK 4 OF CITY OF NATCHEZ TAX MAP 30.

RECEIVED  
APR 11 1979  
NATIONAL RECEIVED

MAY 18 1979





ONE  
WAY  
→

SMART-GRIFFIN HOUSE

Natchez, Adams County, Mississippi

Tod Williams

1977

Natchez Metropolitan Planning Commission

North front and west side, looking southeast.

Photo 1 of 8

APR 11 1979

MAY 18 1979





SMART-GRIFFIN HOUSE

Natchez, Adams County, Mississippi

Tod Williams

1977

Natchez Metropolitan Planning Commission

North front and east side, looking southwest.

Photo 2 of 8

APR 11 1979 MAY 18 1979



SMART-GRIFFIN HOUSE

Natchez, Adams County, Mississippi

Tod Williams

1977

Natchez Metropolitan Planning Commission

East side and rear or south facade, looking  
northwest.

Photo 3 of 8

APR 11 1979

MAY 18 1979





SMART-GRIFFIN HOUSE

Natchez, Adams County, Mississippi

Tod Williams

1977

Natchez Metropolitan Planning Commission

Rear or south facade, looking north.

Photo 4 of 8

APR 11 1979

MAY 18 1979





SMART-GRIFFIN HOUSE

Natchez, Adams County, Mississippi

Tod Williams

1977

Natchez Metropolitan Planning Commission

Detail of front dormer window, looking  
southeast.

Photo 5 of 8

**APR 11 1979**

MAY 18 1979



SMART-GRIFFIN HOUSE

Natchez, Adams County, Mississippi

Robert J. Cangelosi, Jr.

1978

Koch and Wilson Architects, 1100 Jackson,  
New Orleans, LA 70130

West gable-end balcony, looking southeast.

Photo 6 of 8

APR 11 1979

MAY 18 1979



SMART-GRIFFIN HOUSE

Natchez, Adams County, Mississippi

Robert J. Cangelosi, Jr.

1978

Koch and Wilson Architects, 1100 Jackson,

New Orleans, LA 70130

Stairway in hall, looking south

Photo 7 of 8

MAY 18 1979

APR 11 1979





SMART-GRIFFIN HOUSE

Natchez, Adams County, Mississippi

Robert J. Cangelosi, Jr.

1978

Koch and Wilson Architects, 1100 Jackson,  
New Orleans, LA 70130

Mantel and under-window panel in front  
room, looking west.

Photo 8 of 8

MAY 18 1979

APR 11 1979