

MISSISSIPPI HISTORIC BRIDGE SURVEY

1. Name of Bridge: Rockport Bridge

2. Location

Code 029/127

County Copiah/Simpson USGS Quadrangle Georgetown

Town/vicinity Georgetown vicinity

UTM coordinates:

Zone 15 Easting 770620 Northing 3520625

Acreeage less than one Owner Copiah/Simpson counties

Verbal boundary description:

Includes the 18.5 by 400 ft. bridge spanning the Pearl River on the county road east of Rockport in Section 31, Township 10 North, Range 2 East.

State/counties for properties overlapping state or county lines:

State: Mississippi Code: 28 County: Copiah Code: 029

State: Mississippi Code: 28 County: Simpson Code: 127

3. Description

Number of spans 2 Length overall 400 ft. (122 m)

Span types:

(1) Pennsylvania through truss length 200 ft. (61 m)

(2) Pennsylvania through truss length 200 ft. (61 m)

(3) _____ length _____

Truss span components:

Top chords 2 channel beams and 1 plate

End posts 2 channel beams and 1 plate

Bottom chords 3 eye-bars (1 cylindrical and 2 rectilinear)

Hip verticals see diagram

Intermediate posts see diagram

Diagonals see diagram

Counters _____

Connections pins

Piers concrete-filled metal caissons

Abutments _____

Condition good. recently re-painted and re-decked

Date of construction 1910

Builder _____

Source Bridge plaque

4. Location of Legal Description

Courthouse, Office of the Chancery Clerk
 Registry of Deeds, etc.: Copiah/Simpson County Courthouse
 Street & Number: Courthouse Square/Courthouse Square
 City, Town: Hazlehurst/Mendenhall State: Mississippi

Profile Sketch

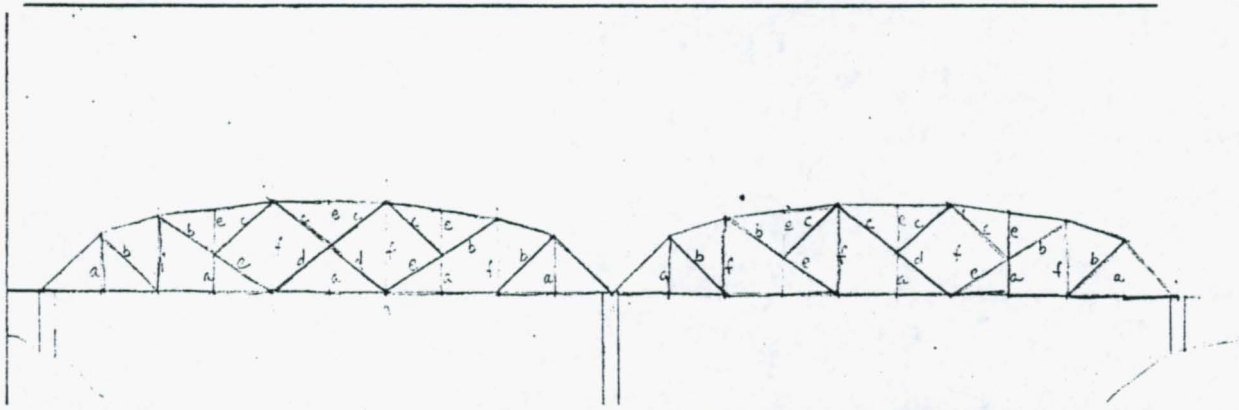

- (a) - 3 cylindrical eye-bars (d) - 1 cylindrical eye-bar
(b) - 2 rectilinear eye-bars (e) - 2 angle bars laced together
(c) - 2 cylindrical eye-bars (f) - 2 channel beams laced together

(4) Significance

Level of significance:

Local ____; State x ; National ____

Statement of significance:

This bridge consists of two Pennsylvania through truss spans. It is significant in that it is a representative example of this type of truss bridge which is to say that it embodies "the distinctive characteristics of a type, period, or method of construction."

(5) Form prepared by:

Jack D. Elliott, Jr.
Historical Archaeologist
Division of Historic Preservation
Mississippi Department of Archives and History
P.O. Box 571
Jackson, Mississippi 39205

029-GEO-4502-X-DL
Rockport Bridge
Copiah and Simpson Counties

Rockport Bridge (not extant), over Pearl River, near Rockport, Georgetown vicinity, Copiah and Simpson Counties (also numbered as 127-PIN-6108-NR-DUPL) (1910). Two spans, both Pennsylvania through truss. The bridge collapsed in February 1999 when a log truck tried to cross it. Designated a Mississippi Landmark on 4 August 1987. It had been listed on the National Register on 16 November 1988 as part of the Historic Bridges of Mississippi thematic group, but was delisted on 15 December 1999. [photos 1694:1-14,16-22]

Rockport Bridge
Georgetown vicinity, Copiah/Simpson
Counties, Mississippi

UTM REFERENCES:

15/770620/3520625

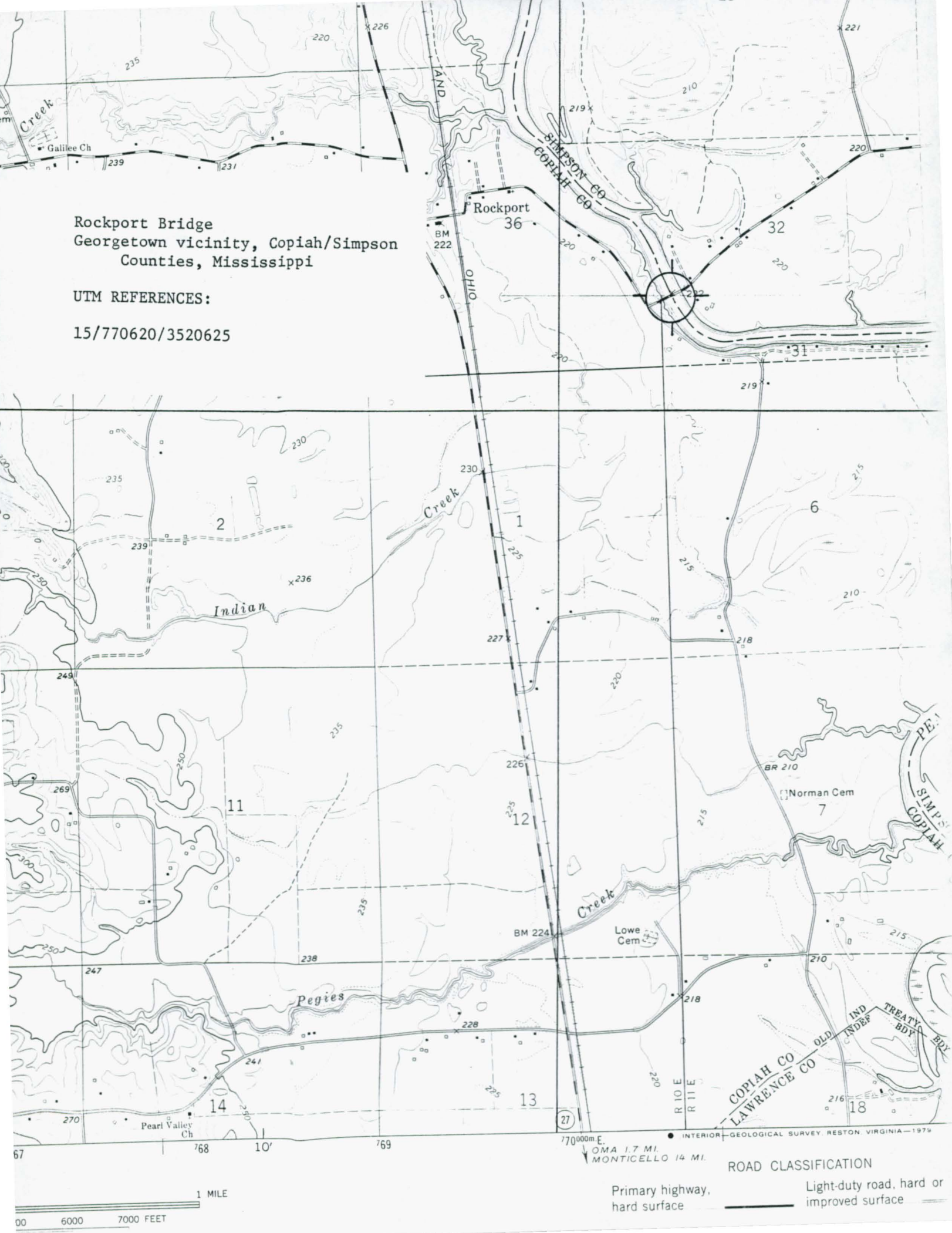

67 768 10' 769 770000m.E.

OMA 1.7 MI.
MONTICELLO 14 MI.

INTERIOR GEOLOGICAL SURVEY, RESTON, VIRGINIA—1979

ROAD CLASSIFICATION

Primary highway, hard surface
Light-duty road, hard or improved surface





Rockport Bridge
Copiah/Simpson Counties, Vicinity of
Georgetown, Mississippi
Jack D. Elliott, Jr.
Mississippi Department of Archives &
History
January 24, 1986
View to North

No. 11 of 35