

MISSISSIPPI HISTORIC BRIDGE SURVEY

2402
OCT 03 19881. Name of Bridge: Enterprise Bridge

2. Location

Code 023County Clarke USGS Quadrangle StonewallTown/vicinity Enterprise

UTM coordinates:

Zone 16 Easting 328420 Northing 3561178Acreage less than one Owner Town of Enterprise

Verbal boundary description:

Includes the 111.2 ft. bridge over the Chickasawhay River on the former crossing of Bridge Street which is on the south side of the present crossing inside the coporation limits of the Town of Enterprise.

3. Description

Number of spans 2 Length overall 111.2 ft (62m)

Span types:

(1) Warren polygonal pony truss length 105.6 ft (31 m)(2) Warren polygonal pony truss length 105.6 ft (31 m)

(3) _____ length _____

Truss span components:

Top chords 2 channel beams and 1 plate laced together
underneathEnd posts 2 channel beams and 1 plate laced together
underneathBottom chords 2 channel beams

Hip verticals _____

Intermediate posts I-beamDiagonals All are I-beams except for the ones at the
ends of the trusses. These are 4 angle bars
that form composite I-beams.

Counters _____

Connections rivetsPiers concreteCondition goodDate of construction probably 1920s or 1930sBuilder unknown

Source _____

4. Location of Legal Description

Courthouse, Office of the Chancery Clerk

Registry of Deeds, etc.: Clarke County CourthouseStreet & Number: South ArchusaCity, Town: Quitman State: Mississippi

Profile Sketch

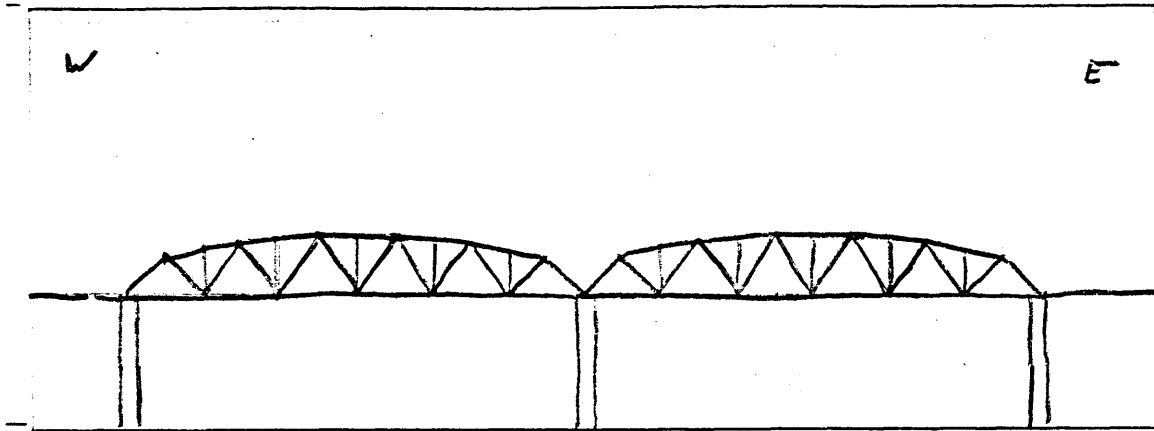

5. Significance

Level of significance:

Local ____; State x; National ____

Statement of significance:

This bridge consists of two Warren polygonal pony truss spans. This type of truss was commonly used in Mississippi during the early 20th century. It is significant in that it embodies "the distinctive characteristics of a type, period, or method of construction." It was preserved by agreement with the Mississippi State Highway Department in 1983.

6. Form prepared by:

Jack D. Elliott, Jr.
Historical Archaeologist
Division of Historic Preservation
Mississippi Department of Archives and History
P.O. Box 571
Jackson, Mississippi 39205



Historic Bridges of Mississippi TR

Enterprise Bridge

Clarke County, Enterprise, Mississippi

Jack D. Elliott, Jr.

February 5, 1986

Mississippi Department of Archives &
History

View to Northeast

No. 3 of 35