

**NATIONAL REGISTER OF HISTORIC PLACES
REGISTRATION FORM**

1. Name of Property

historic name: Vernal Presbyterian Church
other names/site number:

2. Location

street & number: 455 McInnis-Vernal Road
city or town: Lucedale vicinity X
state: Mississippi code: MS county: Greene code:41 zip code: 39452-2241

3. State/Federal Agency Certification

As the designated authority under the National Historic Preservation Act of 1966, as amended, I hereby certify that this X nomination request for determination of eligibility meets the documentation standards for registering properties in the National Register of Historic Places and meets the procedural and professional requirements set forth in 36 CFR Part 60. In my opinion, the property X meets does not meet the National Register Criteria. I recommend that this property be considered significant nationally statewide X locally. (See continuation sheet for additional comments.)

Kenneth H. P. Paul Oct. 9, 2002
Signature of certifying official Date

Deputy State Historic Preservation Officer
State or Federal agency and bureau

In my opinion, the property meets does not meet the National Register criteria. (See continuation sheet for additional comments.)

Signature of commenting or other official Date

State or Federal agency and bureau

4. National Park Service Certification

I, hereby certify that this property is:
X entered in the National Register,
 See continuation sheet.
 determined eligible for the
National Register
 See continuation sheet.
 determined not eligible for the
National Register
 removed from the National Register
 other (explain):

Signature of the Keeper Date of Action
Daniel J. Vivian 11/18/02

5. Classification

Ownership of Property:

Private

Number of Resources within Property:

(Do not include previously listed resources in the count)

Category of Property:

Building

Contributing

Noncontributing

1

0

buildings

sites

structures

objects

1

0

Total

Name of related multiple property listing

(Enter "N/A" if property is not part of a multiple property listing.)

N/A

Number of contributing resources previously listed in the National Register

6. Function or Use

Historic Functions:

RELIGION: Religious facility

Current Functions:

RELIGION: Religious facility

7. Description

Architectural Classification(s):

Gothic Revival

Materials:

foundation: brick

roof: asphalt

walls: wood-weatherboard

other

Narrative Description:

See Continuation Sheets

8. Statement of Significance

Applicable National Register Criteria

- A** Property is associated with events that have made a significant contribution to the broad patterns of our history.
- B** Property is associated with the lives of persons significant in our past.
- C** Property embodies the distinctive characteristics of a type, period, or method of construction or represents the work of a master, or possesses high artistic values, or represents a significant and distinguishable entity whose components lack individual distinction.
- D** Property has yielded, or is likely to yield information important in prehistory or history.

Areas of Significance

Architecture

Period of Significance

1906-08

Significant Dates

1906-08

Criteria Considerations:

Property is:

- A** owned by a religious institution or used for religious purposes.
- B** removed from its original location.
- C** a birthplace or a grave.
- D** a cemetery.
- E** a reconstructed building, object, or structure.
- F** a commemorative property.
- G** less than 50 years of age or achieved significance within the past 50 years.

Significant Person(s)

Cultural Affiliation(s)

Architect/Builder
not recorded

Narrative Statement of Significance: See continuation sheets.

9. Major Bibliographical References

Bibliography See continuation sheet.

Previous documentation on file (NPS)

- preliminary determination of individual listing (36 CFR 67) has been requested.
- previously listed in the National Register
- previously determined eligible by the National Register
- designated a National Historic Landmark
- recorded by Historic American Buildings Survey

- recorded by Historic American Engineering Record

Primary Location of Additional Data

- State Historic Preservation Office
 - Other State agency
 - Federal agency
 - Local government
 - University
 - Other
- Name of repository: _____

10. Geographical Data

Acreage of Property: 3 Acres

UTM References:	<i>Zone</i>	<i>Easting</i>	<i>Northing</i>
	16	346175	3434360

Verbal Boundary Description See continuation sheet.

Boundary Justification: See continuation sheet.

11. Form Prepared By

name/title:	Mr. & Mrs. Pete McLeod		
organization:			date: June 2002
street & number:	202 Pete McLeod Road		telephone:
city or town:	Lucedale	state: MS	zip code: 39452

Additional Documentation

Submit the following items with the completed form:

Continuation Sheets

Maps

A USGS map (7.5 or 15 minute series) indicating the property's location.

A sketch map for historic districts and properties having large acreage or numerous resources.

Photographs

Representative black and white photographs of the property.

Additional items (Check with the SHPO or FPO for any additional items)

Property Owner(s)

name:	Vernal Presbyterian Church (Attn: Frances Forsyth, Clerk of Session)		
street & number:	117 McInnis-Vernal Road		telephone:
city or town:	Lucedale	state: MS	zip code: 39452

Paperwork Reduction Act Statement: This information is being collected for applications to the National Register of Historic Places to nominate properties for listing or determine eligibility for listing, to list properties, and to amend existing listings. Response to this request is required to obtain a benefit in accordance with the National Historic Preservation Act, as amended (16 U.S.C. 470 et seq.).

Estimated Burden Statement: Public reporting burden for this form is estimated to average 18.1 hours per response including the time for reviewing instructions, gathering and maintaining data, and completing and reviewing the form. Direct comments regarding this burden estimate or any aspect of this form to the Chief, Administrative Services Division, National Park Service, P.O. Box 37127, Washington, DC 20013-7127; and the Office of Management and Budget, Paperwork Reductions Projects (1024-0018), Washington, DC 20503.

**United States Department of the Interior
National Park Service**

**NATIONAL REGISTER OF HISTORIC PLACES
CONTINUATION SHEET**

Section: 7

Page: 1

Vernal Presbyterian Church
Greene County, Mississippi

DESCRIPTION

The Vernal Presbyterian Church at 455 McInnis-Vernal Road, Lucedale vicinity, Greene County, Mississippi is a one story, gable-front, rectangularly-massed vernacular Gothic Revival church. Construction started in 1906 and was completed in 1908. All work was done by volunteers from the congregation. The church faces south toward a road leading east and west from Vernal River Road to Winborn Chapel Road. The Vernal Presbyterian Church is nominated within its immediate surroundings of three acres of wooded grounds along Evans Creek.

The church sanctuary has a steep-pitched roof, with a rise of approximately eighteen-in-twelve, covered with composition shingles. The gable on the front or south side has boxed eaves with cornice molding and a wide simple fascia. The foyer protrudes beyond the sanctuary with an approximate fifty-five foot tall tower containing a belfry with open handrails and a very steep sloped steeple roof reaching a height of approximately sixty-five feet. There is no evidence a bell was ever hung in the belfry. Two 2/2 wooden windows with colored glass Gothic arch transoms flank the entry.

The exterior of the building is clad in wood lap-siding over 2x4 balloon framing. The double-entrance doors are wood panel in a simple wood surround. Entry steps are of pre-fabricated concrete in place of the original wood steps. Three-quarter inch black pipe forms the handrail.

The wood joist floor structure is supported on brick piers approximately ten feet on center.

Five 2/2 wooden windows with colored glass Gothic arch transoms on the west and east elevations of the sanctuary contribute greatly to the character of this structure.

A Sunday school addition constructed in 1954 is visible on the west elevation north and east of the sanctuary. The site has a gradual slope to the north so the two stoops at the Sunday school entry door visible on the west elevation are taller than the foyer steps. The Sunday school addition windows are 6/6 wood.

Two 2/2 wooden windows with Gothic arch transoms are visible on the north elevation of the sanctuary. The north elevation consists of two components, the original building built in 1906 and the Sunday school addition built in 1954. In 1974 a fellowship hall was added to Sunday school wing. A stoop of brick at the fellowship entry is visible as well as a wood entry door from the sanctuary

**United States Department of the Interior
National Park Service**

**NATIONAL REGISTER OF HISTORIC PLACES
CONTINUATION SHEET**

Section: 7

Page: 2

Vernal Presbyterian Church
Greene County, Mississippi

The east elevation consists of two components, the 1954 and 1974 additions and the 1906 sanctuary. The 1954 and 1974 additions in the foreground have rectangular 6/6 wood windows. The side elevation of a porch on the fellowship hall with wood columns is visible. The east side of sanctuary in the background is the same as the west elevation. The fellowship hall has a porch facing south with columns.

One enters the sanctuary through a pair of wooden doors from the foyer. The floor is of 1x4 tongue-and-groove heart pine, typical of all floors in the building except the fellowship hall addition. The ceiling height of the sanctuary is twenty feet, with beaded-board placed on the diagonal in the center with the sides sloping vertical to a flat area formed by a collar beam approximately at the third points of the rafters. The ceiling and walls above the chair rail are of pine beaded-boards painted white. Below the chair rail the walls are diagonal beaded-board with a dark stain. The base is a 12" wood heart pine board with a dark stain.

Viewed from the foyer entry doors, the interior is an open rectangular space divided by two rows of wooden pews forming a center aisle and two side aisles. The pews, made of oak, have molded top and end rails and mitered corners; they were refinished in the 1970's.

Original fittings and details survive in the sanctuary. The original choir seats are three rows of attached theatre seats situated in the northwest corner of the sanctuary. An original handmade pine lectern of beaded-board tongue-and-groove heart-pine lumber with simple molding is placed on the small raised platform. A raised platform of 1x4 tongue-and-groove heart flooring thirty feet by ten feet and seven inches tall extends along the north and west walls. Captain McIntosh donated the communion table and the pulpit chairs. These were in the old church before it was moved into the new church. He is said to have brought them from Mobile, Alabama, in an ox-drawn wagon.

**United States Department of the Interior
National Park Service**

**NATIONAL REGISTER OF HISTORIC PLACES
CONTINUATION SHEET**

Section: 8

Page: 3

Vernal Presbyterian Church
Greene County, Mississippi

STATEMENT OF SIGNIFICANCE

The Vernal Presbyterian Church, a rural vernacular church located in the Vernal community between Leakesville and Lucedale, Mississippi, in the southern part of Greene County, is significant under Criterion C for architecture because it is an increasingly-rare and unusually intact example of a rural Gothic Revival church from the first decade of the twentieth century. Vernal Presbyterian Church retains its original framing, weatherboard siding, windows, and interior fittings including woodwork, floors and pews.

The Vernal Presbyterian Church was organized on Saturday, February 28, 1880. Original church members and families were largely of Scottish and Irish ancestry. The first permanent church building was erected in 1882.

On October 23, 1905 the congregation met and resolved to build a new church building. The building committee consisted of A.A. McLeod, Neil McLeod, W.N. McInnis, P.A. McLeod, W.W. McLeod and John McInnis. This building, which is still our place of worship, was completed and dedicated in 1908.

The kerosene lamps were replaced in the church by electric light in 1946. In 1949 the church building was repaired and gas heat was installed.

On August 1, 1954 the congregation met and approved the plan to build a Sunday School Annex, and a building committee was appointed. By December 1954 this Sunday school annex, built adjoining the back of the church sanctuary, was ready for use. On February 22, 1970 the congregation met to approve plans for construction of a fellowship hall, kitchen and bathroom facilities. This addition was completed in 1974.

**United States Department of the Interior
National Park Service**

**NATIONAL REGISTER OF HISTORIC PLACES
CONTINUATION SHEET**

Section: 9

Page: 4

Vernal Presbyterian Church
Greene County, Mississippi

MAJOR BIBLIOGRAPHICAL REFERENCES

McLeod, Mr. & Mrs. Neil, Pipkins, Mr. & Mrs. Earnest and McLeod, Ms Mae. "History of Vernal Presbyterian Church – First 75 years ". Unpublished history written in 1955, in Greene County, MS

Jackson, W. Harvell. *By the Rivers of Water* Volume II, pages 680-688. Published by Lewis Printing Service, Pascagoula, MS. 1982.

Ferguson, Rev. Angus Gray, "Family, School, Church and Pioneer History". Printed by Southern Printing Company, Lakeland, Florida, about 1934-35. Pages 38-47.

Greene County, Mississippi. Chancery Clerk. Deed Book P page 0582. Greene County Courthouse, Leakesville, MS.

Greene County, Mississippi. Tax Assessor. Landroll, Parcel 119. Greene County Courthouse, Leakesville, MS.

**United States Department of the Interior
National Park Service**

**NATIONAL REGISTER OF HISTORIC PLACES
CONTINUATION SHEET**

Section: 10

Page: 5

Vernal Presbyterian Church
Greene County, Mississippi

Verbal Boundary Description

The property of the Vernal Presbyterian Church consists of two parcels described as follows:

Parcel #1

Commencing at the Southwest corner of the SW $\frac{1}{4}$ of the NE $\frac{1}{4}$, of Section 20, in Township one (1) North of Range six (6) West of St. Stephens meridian in said County and State, as a place of beginning, thence East a distance of 135 feet, thence North a distance of 135 feet, thence West a distance of 135 feet, thence South a distance of 135 feet to place of beginning – the said land being 135 feet square.

Parcel #2

Beginning at the center point of Section 20 Township one (1) North, Range six (6) West and run East on the center line of said Section a distance of 315 feet, thence South a distance of 210 feet, thence West a distance of 600 feet to the meanderings of Evans Creek, thence up the center of said Evans Creek, to where said creek crosses the center line dividing Section 20, Township 1 North Range 6 West thence East along said center line to the starting point.

The west side of the church building sits approximately 30 feet east of the center section marker of section 20. The north side of the building is approximately 50 feet from the north boundary line (Parcel #1). The east side of the building is along the east side of (Parcel #1) boundary line. The south side of the building extends into the land described in (Parcel #2).

Boundary Justification

This property consists of the Vernal Presbyterian Church and its immediate surroundings.

Vernal Presbyterian Church
Greene County, Mississippi

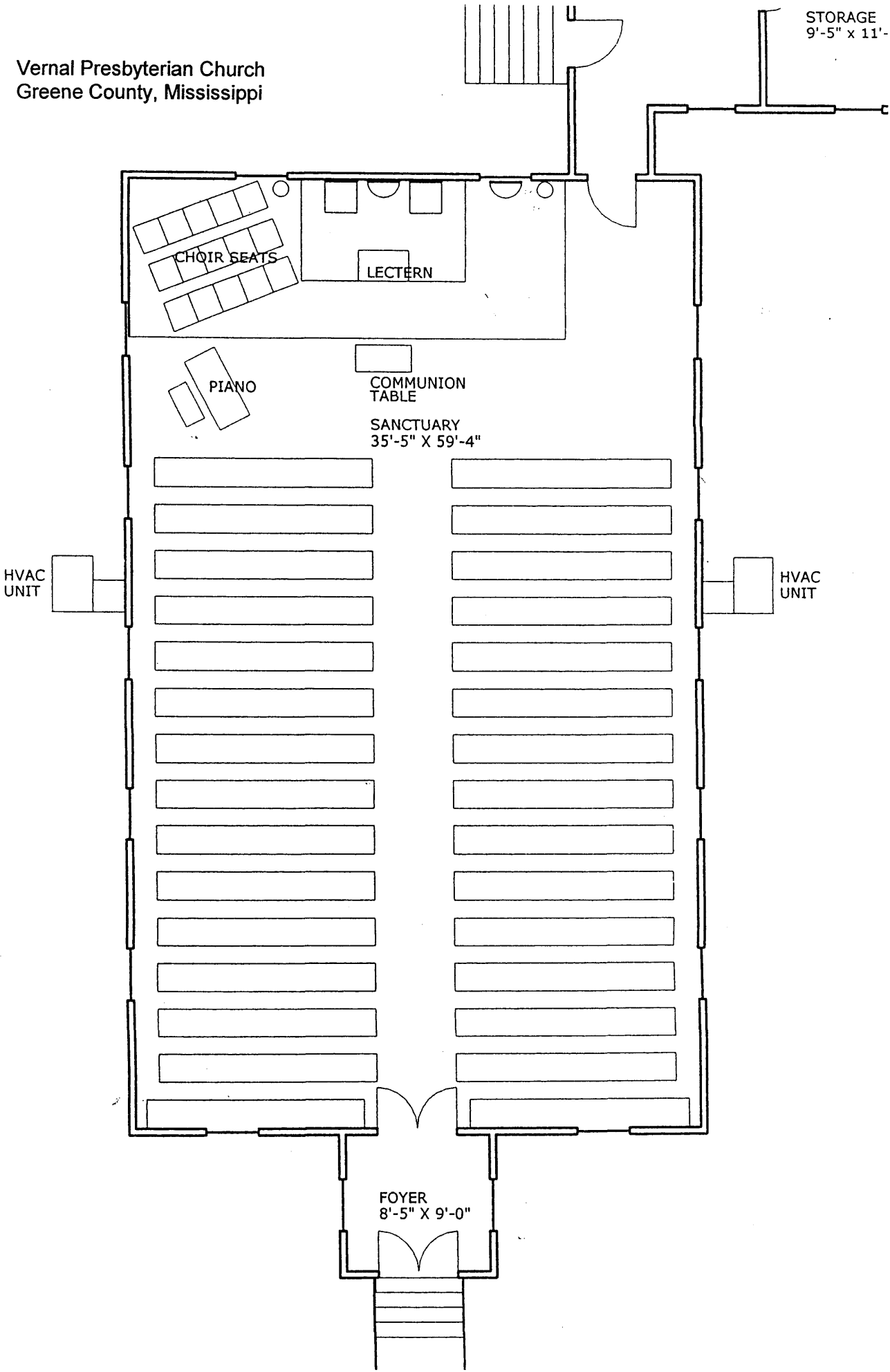

STORAGE
9'-5" x 11'-0"

CHOIR SEATS

LECTERN

PIANO

COMMUNION
TABLE

SANCTUARY
35'-5" X 59'-4"

HVAC
UNIT

HVAC
UNIT

FOYER
8'-5" X 9'-0"



Vernal Presbyterian Church

Greene County, Mississippi

photo by Jennifer Baughn

April 2002

Miss. Dept. of Archives & History

front (south) facade, view to north

photo 1 of 6



Vernal Presbyterian Church
Greene County, MS
photo by Jennifer Baughn
April 2002

Miss. Dept. of Archives & History
West side of the building,
view to northeast

photo 2 of 6



Vernal Presbyterian Church
Greene County, MS

Photo by Jennifer Baughn

April 2002

Miss. Dept. of Archives & History

Addition, located northeast of
the sanctuary, view to north

Photo 3 of 6



Vernal Presbyterian Church

Greene County, MS

photo by Jennifer Baughn

April 2002

Miss. Dept. of Archives & History

detail of interior, showing a window,
wainscot, and wall surface.

view to northwest

photo 4 of 6.



Vernal Presbyterian Church

Greene County, MS

photo by Jennifer Baughn

April 2002

Miss. Dept. of Archives & History

Interior, view to south

photo 5 of 6



Vernal Presbyterian Church

Greene County MS

photo by Jennifer Baughn

April 2002

Miss. Dept. of Archives & History

Interior, view to north,

toward pulpit.

Photo 6 of 6