

UNITED STATES DEPARTMENT OF THE INTERIOR
NATIONAL PARK SERVICE2-31
FOR NPS USE ONLY

RECEIVED

DATE ENTERED

NATIONAL REGISTER OF HISTORIC PLACES
INVENTORY -- NOMINATION FORMSEE INSTRUCTIONS IN *HOW TO COMPLETE NATIONAL REGISTER FORMS*
TYPE ALL ENTRIES -- COMPLETE APPLICABLE SECTIONS**1 NAME**

HISTORIC

Yazoo and Mississippi Valley Depot

AND/OR COMMON

Levee Street Station

2 LOCATION

STREET & NUMBER

500 Grove Street

NOT FOR PUBLICATION

CITY, TOWN

Vicksburg

CONGRESSIONAL DISTRICT

Fourth

STATE

Mississippi

CODE

28

COUNTY

Warren

CODE

149

3 CLASSIFICATION

CATEGORY

☐ DISTRICT☒ BUILDING(S)☐ STRUCTURE☐ SITE☐ OBJECT

OWNERSHIP

☐ PUBLIC☒ PRIVATE☐ BOTH

PUBLIC ACQUISITION

☐ IN PROCESS☐ BEING CONSIDERED

STATUS

☒ OCCUPIED☐ UNOCCUPIED☐ WORK IN PROGRESS

ACCESSIBLE

☒ YES: RESTRICTED☐ YES: UNRESTRICTED☐ NO

PRESENT USE

☐ AGRICULTURE☒ COMMERCIAL☐ EDUCATIONAL☐ ENTERTAINMENT☒ GOVERNMENT☐ INDUSTRIAL☐ MILITARY☐ MUSEUM☐ PARK☐ PRIVATE RESIDENCE☐ RELIGIOUS☐ SCIENTIFIC☐ TRANSPORTATION☐ OTHER:**4 OWNER OF PROPERTY**

NAME

K. D. & J. Real Estate

STREET & NUMBER

P. O. Box 1093

CITY, TOWN

Vicksburg

VICINITY OF

STATE

Mississippi 39180

5 LOCATION OF LEGAL DESCRIPTIONCOURTHOUSE,
REGISTRY OF DEEDS, ETC.Office of the Chancery Clerk
Warren County Courthouse

STREET & NUMBER

P. O. Box 351

CITY, TOWN

Vicksburg

STATE

Mississippi 39180

6 REPRESENTATION IN EXISTING SURVEYS

TITLE

Statewide Survey of Historic Sites

DATE

1976

☐ FEDERAL ☒ STATE ☐ COUNTY ☐ LOCALDEPOSITORY FOR
SURVEY RECORDS

Mississippi Department of Archives and History

CITY, TOWN

Jackson

STATE

Mississippi

7. DESCRIPTION

CONDITION

☐ EXCELLENT ☐ DETERIORATED
☒ GOOD ☐ RUINS
☐ FAIR ☐ UNEXPOSED

CHECK ONE

☐ UNALTERED
☒ ALTERED

CHECK ONE

☒ ORIGINAL SITE
☐ MOVED DATE _____

DESCRIBE THE PRESENT AND ORIGINAL (IF KNOWN) PHYSICAL APPEARANCE

The Yazoo and Mississippi Valley Depot is located in downtown Vicksburg overlooking the Yazoo River Diversion Canal, a tributary of the Mississippi River. The exterior brick walls of the two-and-a-half-story Georgian Revival structure are laid in Flemish bond with glazed headers repeated on every fourth course. The steep-pitch gambrel roof, with gable dormers along the east (facade) and west elevation, is accentuated by a prominent frame belltower composed of a two-stage cupola surmounted by a dome on an octagonal base. On the facade, a central free-standing portico and balustrade is carried by modified Tuscan columns. The five-bay portico separates two projecting and pedimented single-bay pavilions with a stylized modillioned cornice and semi-circular window in the tympanum of each. Double-hung sash on the two main floors have multiple lights in the upper sash and a single pane in the lower sash, with radiating stone voussoirs and keystone above each. The inset central section of the facade is articulated on the first floor by round-arched windows with keystones and archivolt trim. The three-bay north and south (side) walls are carried up as a parapet between the two end chimneys, and topped by a geometrically patterned jig-sawn balustrade. A one-story circular frame portico on the south elevation is supported by Tuscan columns. The frieze of the portico entablature is enriched with triglyphs and guttae. The west (rear) elevation faces the railroad track and a shed-roof passenger waiting platform extends the full length of the building. The shed is supported by cast-iron Tuscan columns.

The original interior plan of the depot consisted of a white waiting room south of the central entrance and a black waiting room and baggage room north. Identical chimney mantelpieces in the north and south waiting rooms feature simple molded architraves supporting a paneled frieze, denticulated cornice, and shelf. The second floor was used for railroad company offices and the unfinished third floor served as storage space.

Rehabilitation of the depot in 1977 remedied serious structural damage to the foundation caused by flooding in 1919, 1927, and 1973 (Karl Jabour, owner of the Yazoo and Mississippi Valley depot, interviewed by Jack A. Gold, architectural historian with the Mississippi Department of Archives and History, Jackson, at Vicksburg, Miss., May 12, 1979). The north and south waiting rooms were made into a bar and restaurant. Enclosure of the passenger waiting porch provided additional dining and kitchen space. The second floor was renovated for General Services Administration offices, and the third floor for retail use. An elevator was installed at the center of the structure adjacent to the original four-run stair to the third floor.

8 SIGNIFICANCE

PERIOD	AREAS OF SIGNIFICANCE -- CHECK AND JUSTIFY BELOW				
PREHISTORIC	<input type="checkbox"/> ARCHEOLOGY-PREHISTORIC	<input type="checkbox"/> COMMUNITY PLANNING	<input type="checkbox"/> LANDSCAPE ARCHITECTURE	<input type="checkbox"/> RELIGION	
1400-1499	<input type="checkbox"/> ARCHEOLOGY-HISTORIC	<input type="checkbox"/> CONSERVATION	<input type="checkbox"/> LAW	<input type="checkbox"/> SCIENCE	
1500-1599	<input type="checkbox"/> AGRICULTURE	<input type="checkbox"/> ECONOMICS	<input type="checkbox"/> LITERATURE	<input type="checkbox"/> SCULPTURE	
1600-1699	<input checked="" type="checkbox"/> ARCHITECTURE	<input type="checkbox"/> EDUCATION	<input type="checkbox"/> MILITARY	<input type="checkbox"/> SOCIAL/HUMANITARIAN	
1700-1799	<input type="checkbox"/> ART	<input type="checkbox"/> ENGINEERING	<input type="checkbox"/> MUSIC	<input type="checkbox"/> THEATER	
1800-1899	<input type="checkbox"/> COMMERCE	<input type="checkbox"/> EXPLORATION/SETTLEMENT	<input type="checkbox"/> PHILOSOPHY	<input checked="" type="checkbox"/> TRANSPORTATION	
<input checked="" type="checkbox"/> 1900-	<input type="checkbox"/> COMMUNICATIONS	<input type="checkbox"/> INDUSTRY	<input type="checkbox"/> POLITICS/GOVERNMENT	<input type="checkbox"/> OTHER (SPECIFY)	
	<input type="checkbox"/> INVENTION				

SPECIFIC DATES	1907	BUILDER/ARCHITECT	D. H. Burnham and Co.
----------------	------	-------------------	-----------------------

STATEMENT OF SIGNIFICANCE

Designed by the firm of D. H. Burnham & Co. of Chicago, the Yazoo and Mississippi Valley Depot is an architecturally significant example of the influence of the Georgian Revival style on public buildings in America after 1900. The structure is also representative of the increased economic prosperity of the region facilitated by improved rail service routes along the Mississippi corridor of the Illinois Central (Gulf) railroad system. More recently the rehabilitation of the structure as a restaurant and office facility has provided the former depot a suitable adaptive use.

The Yazoo and Mississippi Valley railroad was incorporated in 1882 and consolidated with the Louisville, New Orleans, and Texas railroad as a part of the Illinois Central Railroad Company in 1892 (Carlton J. Corliss, Main Line of Mid-America [New York: Creative Age Press, 1950], p. 240). The Louisville, New Orleans, Texas name was changed to Yazoo and Mississippi Valley and the line's passenger and freight services prospered. Increased demand for railroad service here resulted in the construction in 1907 of a new depot to replace the modest frame structure used formerly by the Louisville, New Orleans and Texas. Passenger service was discontinued in 1932. Illinois Central Gulf Railroad company offices were located here until the sale of the building in 1977.

Classical proportion and detail and the emphasis on symmetrical form relates the eighteenth-century Palladian influence characteristic of Georgian architecture in America to the revival-style depot in Vicksburg. Derivative in form and scale of public buildings in colonial Williamsburg such as the Capitol (1701-05) and Governor's Palace (1706-20), the Yazoo and Mississippi Valley Depot presents a startling academic contrast to neighboring mid-nineteenth century commercial buildings. Marcus Whiffen addresses this contrast: "Many of the public and educational buildings of the Georgian Revival have a special sort of unreality that is increased rather than diminished by the 'correctness' of their detail" (Marcus Whiffen, American Architecture since 1790 [Cambridge: The M. I. T. Press, 1969], p. 164). The structure displays the sophisticated application of such typically Georgian details as balustrades, quoins, stylized cornices, and voussoirs, coupled with the formal arrangement of building parts. The successful integration of these building elements by D. H. Burnham and Co. is complemented by the high-quality masonry work of contractor George B. Swift and Co., Vicksburg.

9 MAJOR BIBLIOGRAPHICAL REFERENCES

Alexander, Edwin P. Down at the Depot. New York: Bramhall House, 1970.

Corliss, Carlton J. Main Line of Mid-America. New York: Creative Age Press, 1950.

Gold, Jack A., architectural historian with the Mississippi Department of Archives and History. Inspection of the Yazoo and Mississippi Valley Depot, May 12, 1979.

10 GEOGRAPHICAL DATA

ACREAGE OF NOMINATED PROPERTY two acres

QUADRANGLE NAME Vicksburg West

QUADRANGLE SCALE 1:24000

UTM REFERENCES

A 15 699240 3581280

B

ZONE EASTING NORTHING

ZONE EASTING NORTHING

C

D

E

F

G

H

VERBAL BOUNDARY DESCRIPTION

Boundary of nominated property correspond with red line on enclosed map.

LIST ALL STATES AND COUNTIES FOR PROPERTIES OVERLAPPING STATE OR COUNTY BOUNDARIES

STATE CODE COUNTY CODE

STATE CODE COUNTY CODE

11 FORM PREPARED BY

NAME / TITLE

Jack A. Gold

Architectural Historian

ORGANIZATION

DATE

Mississippi Department of Archives and History

June, 1979

STREET & NUMBER

TELEPHONE

P. O. Box 571

(601) 354-7326

CITY OR TOWN

STATE

Jackson

Mississippi 39205

12 STATE HISTORIC PRESERVATION OFFICER CERTIFICATION

THE EVALUATED SIGNIFICANCE OF THIS PROPERTY WITHIN THE STATE IS:

NATIONAL

STATE X

LOCAL

As the designated State Historic Preservation Officer for the National Historic Preservation Act of 1966 (Public Law 89-665), I hereby nominate this property for inclusion in the National Register and certify that it has been evaluated according to the criteria and procedures set forth by the National Park Service.

STATE HISTORIC PRESERVATION OFFICER SIGNATURE

John B. Hilliard

TITLE

State Historic Preservation Officer

DATE

August 31, 1979

FOR NPS USE ONLY

I HEREBY CERTIFY THAT THIS PROPERTY IS INCLUDED IN THE NATIONAL REGISTER

DATE

KEEPER OF THE NATIONAL REGISTER

ATTEST:

DATE

CHIEF OF REGISTRATION

UNITED STATES DEPARTMENT OF THE INTERIOR
HERITAGE CONSERVATION AND RECREATION SERVICE

FOR HCRS USE ONLY

RECEIVED

DATE ENTERED

NATIONAL REGISTER OF HISTORIC PLACES INVENTORY -- NOMINATION FORM

CONTINUATION SHEET

ITEM NUMBER 9

PAGE 1

9 - MAJOR BIBLIOGRAPHICAL REFERENCES

Jabour, Karl, owner of the Yazoo and Mississippi Valley depot. Interviewed by Jack A. Gold, architectural historian with the Mississippi Department of Archives and History, Jackson, at Vicksburg, Miss., May 12, 1979.

Warren Co., Miss. Chancery Clerk, Deed Book 118:191. Mississippi Department of Archives and History, Jackson. Microfilm.

Whiffen, Marcus. American Architecture since 1780. Cambridge: The M. I. T. Press, 1969.

2848 IV NE
(REDWOOD)

7.5 MINUTE SERIES (TOPOGRAPHIC)

SW/4 VICKSBURG 15' QUADRANGLE

UTM REFERENCE:

15/699240/3581280

680 000 FEET

(MISS.)
3583

WALTERSVILLE 0.9 MI.
ROLLING FORK 42 MI.

3582

3581

3580

20'

3579

MISS. 27
42 MI.

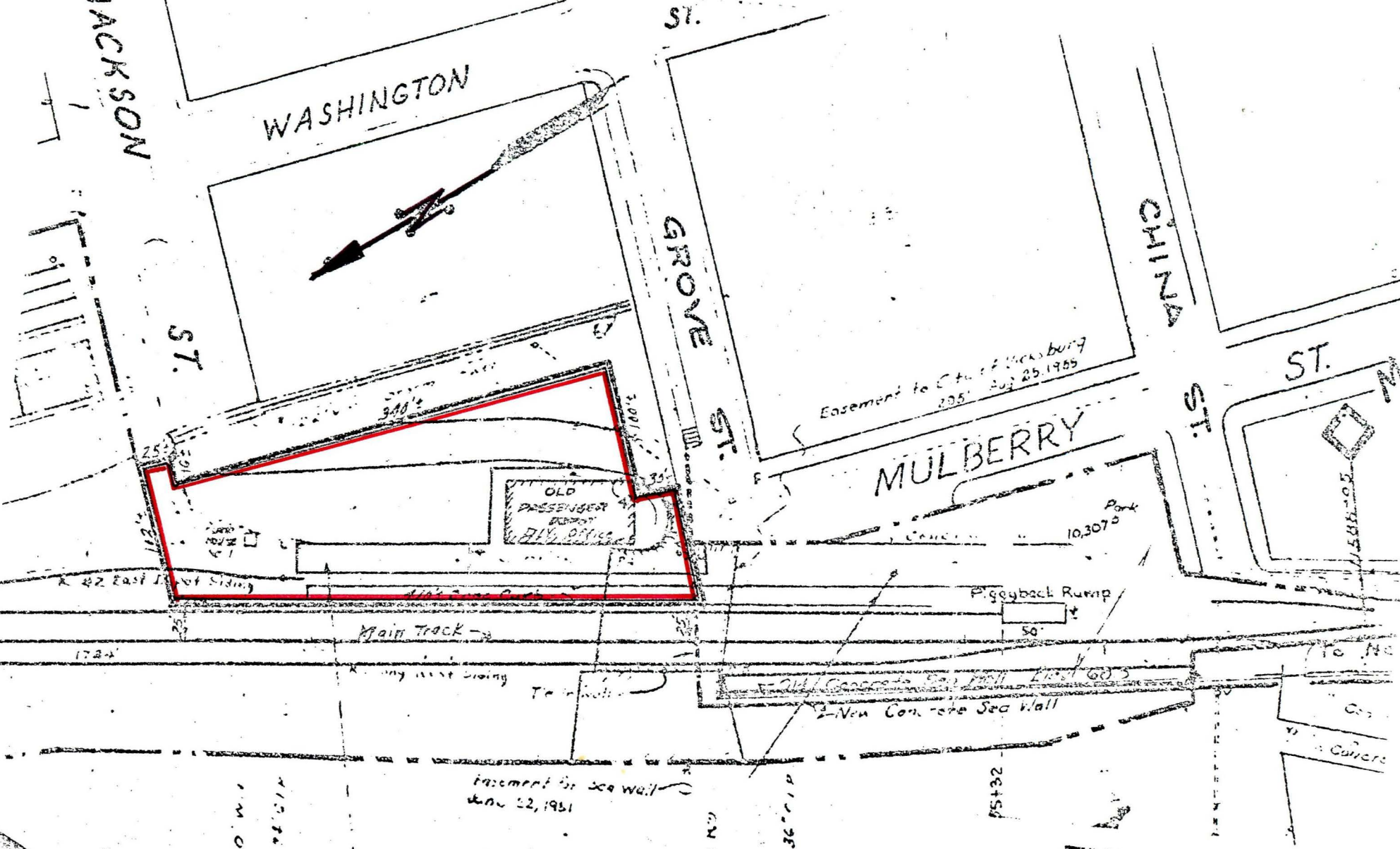

LAKE CENTENNIAL

EXHIBIT "A"

I.C.G.R.R.CO.
REAL ESTATE DEPT.
CHICAGO, ILL.

VICKSBURG, MISS.



LEVEE STREET STATION

RAILROAD
CROSSING

YAZOO AND MISSISSIPPI VALLEY DEPOT

Vicksburg, Warren County, Mississippi

Jack A. Gold

March, 1979

Mississippi Department of Archives and History

Facade; view to west.

Photo No. 1



YAZOO AND MISSISSIPPI VALLEY DEPOT

Vicksburg, Warren County, Mississippi

Jack A. Gold

March, 1979

Mississippi Department of Archives and History

South elevation; view to north.

Photo No. 2



YAZOO AND MISSISSIPPI VALLEY DEPOT

Vicksburg, Warren County, Mississippi

Jack A. Gold

March, 1979

Mississippi Department of Archives and History

North and west (rear) elevations; view to
southeast.

Photo No. 3



YAZOO AND MISSISSIPPI VALLEY DEPOT

Vicksburg, Warren County, Mississippi

Jack A. Gold

March, 1979

Mississippi Department of Archives and History

Photo No. 4



YAZOO AND MISSISSIPPI VALLEY DEPOT

Vicksburg, Warren County, Mississippi

Jack A. Gold

March, 1979

Mississippi Department of Archives and History

Mantlepiece, black waiting room; view to north.

Photo No. 5