



# Historic Sites Survey

## ARCHITECTURAL DESCRIPTION:

Two-and-a-half-story frame Queen Anne residence facing west toward the railroad tracks. Steeply pitched truncated hipped roof with irregular gabled projections featuring a two-and-a-half-story octagonal tower with tent roof at the northeast corner. Irregular fenestration on both stories of the facade. Double-leaf central entrance topped by transom. One-story gallery, supported on attenuated, modified Tuscan columns, across facade with balustraded porch on second story. One exterior chimney. Kitchen added to rear in 1907. Outbuildings include cottage to immediate rear of property (220 Myrtle Street).

## ALTERATIONS:

Kitchen added 1907

## OUTBUILDINGS:

Cottage to rear (220 Myrtle Street).

## LANDSCAPE FEATURES:

Huge magnolia in front of residence planted by Mrs. Clark, wife of man who laid out streets for city.

## STATEMENT OF SIGNIFICANCE:

The Berryhill House is an excellent example of Queen Anne architecture and is one of Magnolia's four Queen Anne residences. In addition, it is the only one of the city's extant Queen Anne residences located outside of the prosperous Southtown neighborhood and in Magnolia's more modest northern neighborhood and serves as a stylistic model of the Queen Anne style for the northern section of town. The Berryhill residence exhibits many high-style Queen Anne details--such as monumental tower, a wrap-around porch with a second-story balustraded porch, and decorative stickwork--and is an outstanding building within the context of Magnolia's historic resources.

NAME: Berryhill House

STREET NO: 265 West Railroad Avenue

TOWN/VIC: Magnolia

COUNTY: Pike

BLOCK/LOT: 10

PRESENT OWNER: Rev. Davis Berryhill  
 ADDRESS: 265 West Railroad Avenue  
 Magnolia, Mississippi 39652

PRESENT USE: Residence

FORMER USE: Residence

DATE: 1889

STYLE: Queen Anne

ARCH/BUILDER: Unknown

SOURCE OF DATE: Local knowledge

ENVIRONMENT: One of three isolated residences  
 facing railroad tracks.

LEVEL OF SIGNIFICANCE

NEIGHBORHOOD

LOCAL X

STATE

NATIONAL

PHOTOS

NEG. #

SITE OR AREA PLAN WITH NORTH ARROW AND SHAPE OF STRUCTURE:

CONTINUATION:

PHYSICAL CONDITION:

Good

THREATS:

Although the residence is located facing an industrial area, it is buffered from the industries by a grassy median and should not be included in the industrial area.

VERBAL BOUNDARY DESCRIPTION:

Parcel No. 300047  
100 N.S. x 160 E.W. Block 10

ACREAGE: less than one acre

UTM REF: This UTM corresponds to site "U" on the quad map.

A	1 5	7 4 2 3 6 0	3 4 4 8 3 3 0
	ZONE EASTING		NORTHING
C			
B			
	ZONE EASTING		NORTHING
D			

FORM PREPARED BY:

DATE

P. Ana Gordon

May, 1982

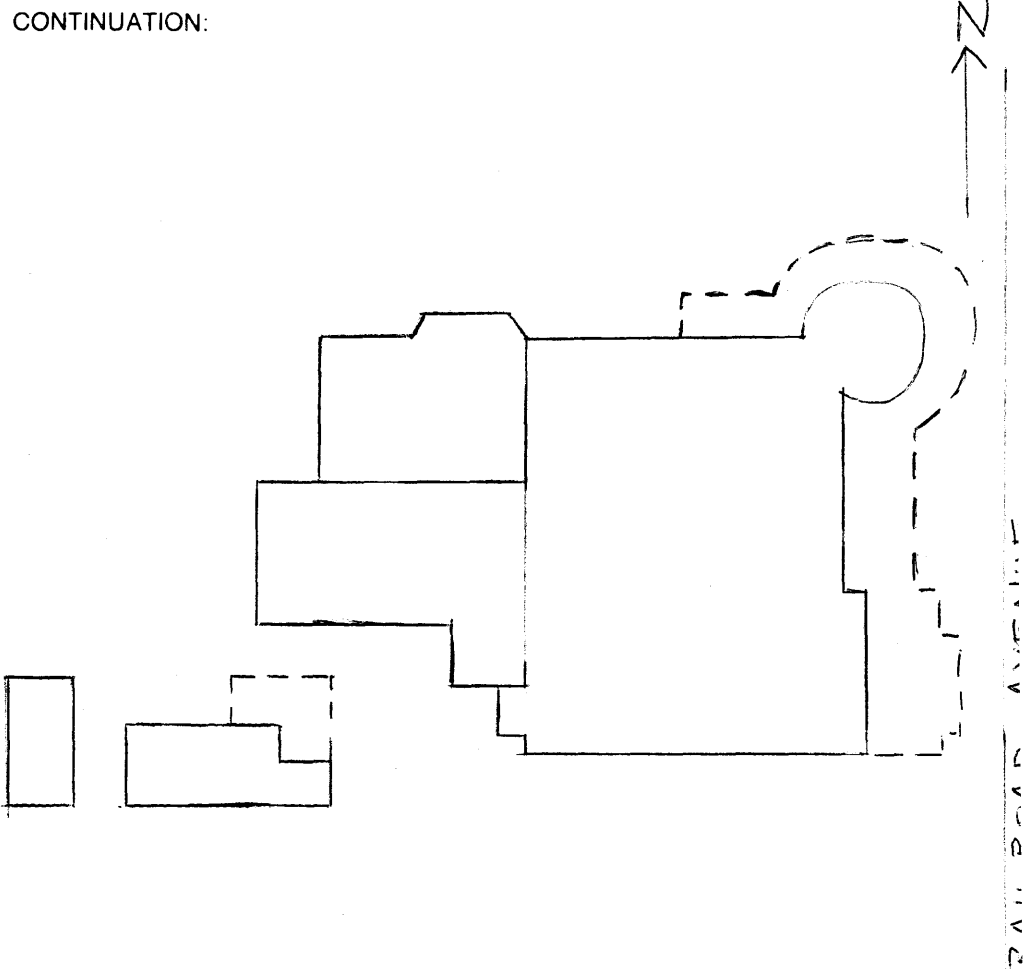



Berryhill House, 265 West Railroad, view  
to the northeast

Historic Resources of Magnolia *MMA*

Magnolia, Pike County, Mississippi

P. Ana Gordon, Mississippi Department  
of Archives and History

February, 1982

Photo 13 of 39