



Historic Sites Survey

ARCHITECTURAL DESCRIPTION:

One-story, irregularly massed frame residence on corner facing east. Steeply pitched hipped roof with a gable projection and a three-bay pavilion on the southwest corner. Centered entrance is a single door with transom. Other fenestration on the front facade includes two floor-to-ceiling windows. Porch begins at center of front facade and continues around north (secondary) facade. Ornamental details such as the intricate bargeboards on the side gables and the paneled frieze along the porch make this the most ornately decorated one-story house in Magnolia.

ALTERATIONS:

None

OUTBUILDINGS:

None

LANDSCAPE FEATURES:

A terraced lawn and a multitude of bushes on both primary and secondary facade.

STATEMENT OF SIGNIFICANCE:

The Holmes House is a unique residence in Magnolia and is architecturally significant as the best example of a picturesquely massed, highly-decorated, one-story residence. The house is one of the largest one-story residences in the city and its imposing massing is augmented by its elevated corner lot setting and its steeply pitched hipped roof. The Holmes House also is remarkable for its L-shaped porch with paneled frieze and the intricate bargeboards on the non-pictured gable. The Holmes House is a masterpiece amid Magnolia's other turn-of-the-century one-story residences.

NAME: Holmes House ✓

STREET NO: 405 North Cherry Street

TOWN/VIC: Magnolia ✓

COUNTY: Pike ✓

BLOCK/LOT: 4

PRESENT OWNER: Mrs. Wendell Holmes
 ADDRESS 405 North Cherry Street

Magnolia, Mississippi 39652
 PRESENT USE: Residence

FORMER USE: Residence

DATE: Ca. 1900

STYLE: Vernacular Queen Anne

ARCH/BUILDER: Unknown

SOURCE OF DATE: Local knowledge

ENVIRONMENT: Corner lot on residential street

LEVEL OF SIGNIFICANCE

NEIGHBORHOOD

LOCAL X

STATE

NATIONAL

PHOTOS

NEG. #

SITE OR AREA PLAN WITH NORTH ARROW AND SHAPE OF STRUCTURE:

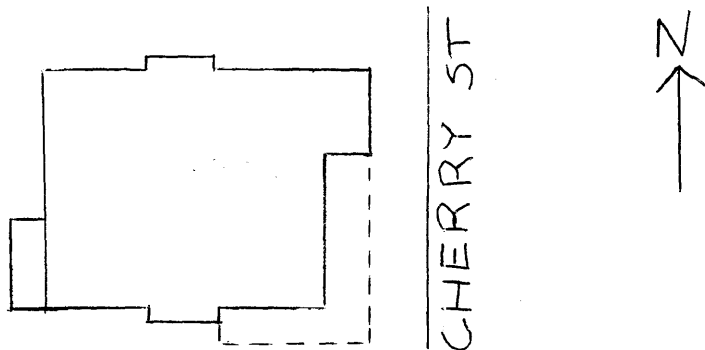

CONTINUATION:

PHYSICAL CONDITION:

Good

THREATS:

None

VERBAL BOUNDARY DESCRIPTION:

Parcel No. 300016
150 N.S. x 200 E.W. Block 4

ACREAGE: less than one

UTM REF:

This UTM corresponds to site "V" on the quad map.

A

1	1	5
---	---	---

7	4	2	3	0	0
---	---	---	---	---	---

3	4	4	8	5	6	5
---	---	---	---	---	---	---

ZONE EASTING NORTHING

C

--	--

--	--	--	--	--	--	--	--	--	--	--	--

--	--	--	--	--	--	--	--	--	--	--	--	--

B

--	--

--	--	--	--	--	--	--	--	--	--	--	--

--	--	--	--	--	--	--	--	--	--	--	--	--

ZONE EASTING NORTHING

D

--	--

--	--	--	--	--	--	--	--	--	--	--	--

--	--	--	--	--	--	--	--	--	--	--	--	--

FORM PREPARED BY:

P. Ana Gordon

DATE

May, 1982



Holmes House, 405 North Cherry, view to
the east

Historic Resources of Magnolia *MR A*

Magnolia, Pike County, Mississippi

P. Ana Gordon, Mississippi Department
of Archives and History

February, 1982

Photo 1 of 39