

**United States Department of the Interior
Heritage Conservation and Recreation Service**

**National Register of Historic Places
Inventory—Nomination Form**

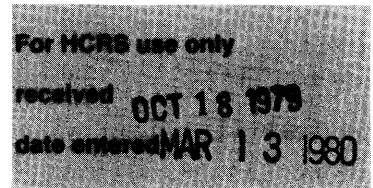

See instructions in *How to Complete National Register Forms*
Type all entries—complete applicable sections

1. Name

historic Pecan Grove

and/or common Pecan Grove

2. Location N of Church Hill off MS 551

street & number Miss. Off Highway 551 about one-and-a-half miles not for publication
north of Christ Church, Church Hill, Miss.

city, town Church Hill vicinity of Miss congressional district Fourth

state Mississippi code 28 county Jefferson code 063

3. Classification

Category	Ownership	Status	Present Use	
<input type="checkbox"/> district	<input type="checkbox"/> public	<input checked="" type="checkbox"/> occupied	<input checked="" type="checkbox"/> agriculture	<input type="checkbox"/> museum
<input checked="" type="checkbox"/> building(s)	<input checked="" type="checkbox"/> private	<input type="checkbox"/> unoccupied	<input type="checkbox"/> commercial	<input type="checkbox"/> park
<input type="checkbox"/> structure	<input type="checkbox"/> both	<input type="checkbox"/> work in progress	<input type="checkbox"/> educational	<input checked="" type="checkbox"/> private residence
<input type="checkbox"/> site	Public Acquisition	Accessible	<input type="checkbox"/> entertainment	<input type="checkbox"/> religious
<input type="checkbox"/> object	<input type="checkbox"/> in process	<input type="checkbox"/> yes: restricted	<input type="checkbox"/> government	<input type="checkbox"/> scientific
	<input type="checkbox"/> being considered	<input type="checkbox"/> yes: unrestricted	<input type="checkbox"/> industrial	<input type="checkbox"/> transportation
		<input checked="" type="checkbox"/> no	<input type="checkbox"/> military	<input type="checkbox"/> other:

4. Owner of Property

name Mr. and Mrs. W. W. Valentine

street & number Miss. Highway 551

city, town Church Hill vicinity of _____ state Mississippi

5. Location of Legal Description

courthouse, registry of deeds, etc. Jefferson County Courthouse/Chancery Clerk

street & number P. O. Box 145

city, town Fayette state Mississippi

6. Representation in Existing Surveys

title _____ has this property been determined eligible? yes no

date _____ federal state county local

depository for survey records _____

city, town _____ state _____

7. Description

Condition

excellent
 good
 fair

deteriorated
 ruins
 unexposed

Check one

unaltered
 altered

Check one

original site
 moved date _____

Describe the present and original (if known) physical appearance

Situated on a 750-acre tract of farmland and entered from a gravel drive off Mississippi Highway 559 about one-and-a-half miles north of historic Church Hill, Mississippi, Pecan Grove is a one-and-a-half story, frame, plantation dwelling with gabled roof. Originally, the roof was pierced by one interior brick chimney with two outside-end chimneys located on the southerly elevation and one outside-end chimney on the northerly elevation. The five-bay easterly facade is fronted by a gallery cut under the front slope of the roof, and the gallery is supported by wooden box columns that have been cut at the bottom and placed upon brick piers. The matched-board ceiling of the gallery is divided into five deeply recessed and molded panels. The front wall of the house is composed of matched boards and finished with a base that has two fasciae and is delicately molded. The windows, the northernmost one having been extended and converted into a door, have delicately molded architrave surrounds and aprons that have two fasciae and are molded. The entrance doorway which is located in the center bay consists of a later ca. 1900 single-leaf door with glazed upper panel enframed by a semi-circular fanlight and molded pilasters. The windows contain six-over-six, double-hung sash and are closed by original shutter blinds on the southerly elevation.

The interior floor plan was originally a single-pile plan, three rooms across, with small rooms, or "cabinets," located at either end of an undercut rear gallery. Probably not long after the house was constructed, these "cabinet" rooms were enlarged and the recessed gallery became a hallway. The central front room and the adjacent room to the north are identically trimmed with doors that are eight-paneled and molded, architrave door and window surrounds, bases that have two fasciae and are molded, chair molding with two fasciae, and pilastered Federal mantel pieces with bed moldings. The mantel pieces of the two rooms are unusual for the area, because the mantel shelves wrap around the side of the chimney wall. Original fireplace cabinets remain in the center front room, but the cabinets and mantel shelf return in the northern front room have been removed.

The southernmost of the front rooms is more simply trimmed with beaded bases having a single fascia and no chair molding. The mantel piece is exceptionally fine with pilasters adorned with string beading and gouged carving adorning the central tablet, end blocks, and frieze. Another identical mantel piece was originally located in the southern "cabinet" room but is now missing. The rear rooms are plainly trimmed and have walls and ceilings of matched boards. The mantel piece in the northern rear room is of ca. 1900 design. The stairway to the second floor, which is enclosed and entered on the southern hall wall, rises in a straight flight to terminate

8. Significance

Period	Areas of Significance—Check and justify below			
<input type="checkbox"/> prehistoric	<input type="checkbox"/> archeology-prehistoric	<input type="checkbox"/> community planning	<input type="checkbox"/> landscape architecture	<input type="checkbox"/> religion
<input type="checkbox"/> 1400-1499	<input type="checkbox"/> archeology-historic	<input type="checkbox"/> conservation	<input type="checkbox"/> law	<input type="checkbox"/> science
<input type="checkbox"/> 1500-1599	<input checked="" type="checkbox"/> agriculture	<input type="checkbox"/> economics	<input type="checkbox"/> literature	<input type="checkbox"/> sculpture
<input type="checkbox"/> 1600-1699	<input checked="" type="checkbox"/> architecture	<input type="checkbox"/> education	<input type="checkbox"/> military	<input type="checkbox"/> social/ humanitarian
<input type="checkbox"/> 1700-1799	<input type="checkbox"/> art	<input type="checkbox"/> engineering	<input type="checkbox"/> music	<input type="checkbox"/> theater
<input checked="" type="checkbox"/> 1800-1899	<input type="checkbox"/> commerce	<input type="checkbox"/> exploration/settlement	<input type="checkbox"/> philosophy	<input type="checkbox"/> transportation
<input type="checkbox"/> 1900-	<input type="checkbox"/> communications	<input type="checkbox"/> industry	<input type="checkbox"/> politics/government	<input type="checkbox"/> other (specify)
		<input type="checkbox"/> invention		

Specific dates 1815-17

Builder/Architect

Statement of Significance (in one paragraph)

Pecan Grove is an outstanding example of an early Mississippi plantation residence in the Federal Style. The house and surrounding plantation gain further significance from their long history of family ownership. The plantation consists of 764.83 acres of land (Jefferson Co. Deed of Trust Book 21:389), the first 587.34 acres having been acquired in 1815 by the great-great-grandfather of the present owner, Mrs. Lillian Baker Valentine (Jefferson Co. Deed Book Cl:181).

Thomas Baker and his brother Loe of New Jersey, settled in the Natchez area of Mississippi early in the nineteenth century (Historical and Biographical Memoirs of Mississippi [Chicago: The Goodspeed Publishing Co., 1891], Vol. I, pp. 333-4). Loe Baker was recorded as being a resident of Natchez as early as 1807 (Jefferson Co. Deed Book Cl:43), but the first recorded reference to Thomas appears in 1815 when he purchased 587.34 acres of land in Jefferson County and was listed as a resident of Natchez in neighboring Adams County (Jefferson Co. Deed Book Cl:181). Pecan Grove was erected upon this tract, and stylistic evidence indicates that the house was constructed soon after the 1815 date of purchase. Family tradition maintains that Thomas Baker's first wife, Nancy [Ann] (Jefferson Co. Deed Book Cl:185), resided in the house, and, since he married his second wife, Eliza Green, on January 1, 1818 (Baker family Bible, Lillian Baker Valentine, Pecan Grove Plantation, Church Hill, Mississippi), Pecan Grove was probably erected in the years 1815-17.

Eliza Green, Baker's second wife, was the granddaughter of Col. Thomas Green who settled in the Natchez region after the Revolutionary War and was influential in area politics well into the territorial period. Greenville, an early small town in Jefferson County that ceased to exist in the nineteenth century, was named for the prominent Green family, whose Springfield Plantation is listed on the National Register of Historic Places. Col. Green officiated at the marriage of Andrew Jackson and Rachel Robards, who had previously been living with the Green family and serving as a tutor for their children. Goodspeed's Historical and Biographical Memoirs of Mississippi records the information that Thomas Baker was a merchant in the old town of Greenville (Vol. I, p. 333), and Baker's purchase of a Greenville town lot in 1818 substantiates this claim (Jefferson Co. Deed Book A:7).

In 1854, Thomas Francis Baker, Jr., son of Thomas and Eliza Green

9. Major Bibliographical References

See continuation sheet.

10. Geographical Data

UTM NOT VERIFIED

Acreeage of nominated property 8.26 acres

Quadrangle name Fayette

Quadrangle scale 1:62500

UMT References

A

1	5	6	6	7	5	7	0	3	5	3	2	2	6	0
Zone				Easting				Northing						

B

Zone				Easting				Northing						

C

Zone				Easting				Northing						

D

Zone				Easting				Northing						

E

Zone				Easting				Northing						

F

Zone				Easting				Northing						

G

Zone				Easting				Northing						

H

Zone				Easting				Northing						

Verbal boundary description and justification The nominated property forms a four-sided figure with right angle corners and equal sides of 600 feet each with the center being the center point of the roof ridge of the house. The sides of the figure are parallel to the walls of the house.

List all states and counties for properties overlapping state or county boundaries

state _____ code _____ county _____ code _____

state _____ code _____ county _____ code _____

11. Form Prepared By

name/title Mary Warren Miller/Research Consultant

organization Self-employed date September 24, 1979

street & number 506 High Street telephone (601) 442-9786

city or town Natchez state Mississippi 39120

12. State Historic Preservation Officer Certification

The evaluated significance of this property within the state is:

national state local

As the designated State Historic Preservation Officer for the National Historic Preservation Act of 1966 (Public Law 89-665), I hereby nominate this property for inclusion in the National Register and certify that it has been evaluated according to the criteria and procedures set forth by the Heritage Conservation and Recreation Service.

State Historic Preservation Officer signature Robert R. Williams

title State Historic Preservation Officer date October 16, 1979

For HCERS use only

I hereby certify that this property is included in the National Register

W. Ray Luce date 3/13/80
for Keeper of the National Register

Attest: Carl A. Dubois date 3/11/80

Chief of Registration

UNITED STATES DEPARTMENT OF THE INTERIOR
NATIONAL PARK SERVICE

**NATIONAL REGISTER OF HISTORIC PLACES
INVENTORY -- NOMINATION FORM**

FOR NPS USE ONLY	
RECEIVED	OCT 18 1979
DATE ENTERED	MAR 13 1980

CONTINUATION SHEET

ITEM NUMBER 7

PAGE 1

in an unfinished second story that is partitioned into two rooms by the interior chimney of the house. On the door at the bottom of the stair remains a 19th-century "faux bois" treatment, and traces of early paint colors remain on the walls of the enclosed stairway. The rear enlarged "cabinet" rooms also appear to retain 19th-century paint colors.

The rear of Pecan Grove has been altered by the addition of a room and storage area added in the twentieth century. No original outbuildings remain.

UNITED STATES DEPARTMENT OF THE INTERIOR
HERITAGE CONSERVATION AND RECREATION SERVICE

**NATIONAL REGISTER OF HISTORIC PLACES
INVENTORY -- NOMINATION FORM**

FOR HCRS USE ONLY
RECEIVED OCT 18 1979
DATE ENTERED

MAR 13 1980

CONTINUATION SHEET

ITEM NUMBER 8 PAGE 1

Baker assumed control of Pecan Grove Plantation. He repaired the house and commenced the successful operation of a large plantation (Goodspeed, Vol. I, pp. 333-4). Today, the house is the residence of Thomas Francis Baker's great-granddaughter and her husband, Mr. and Mrs. W. W. Valentine. Pecan Grove Plantation contains the only historic house in the Church Hill community still owned by the family of the original builder and is one of the largest, intact antebellum plantations in the state of Mississippi. Nearing eighty years of age, Mrs. Valentine's vivid recollections of her own childhood and the traditional history handed down by the previous six generations of Bakers and Greens to reside in Jefferson County provide an excellent resource for studying the history of the Church Hill community and the old Natchez region.

UNITED STATES DEPARTMENT OF THE INTERIOR
NATIONAL PARK SERVICE

FOR NPS USE ONLY

RECEIVED

MAR 13 1980

DATE ENTERED

NATIONAL REGISTER OF HISTORIC PLACES
INVENTORY -- NOMINATION FORM

Pecan Grove

CONTINUATION SHEET Jefferson County ITEM NUMBER 8 PAGE 1

Pecan Grove is an outstanding example of an early Mississippi plantation residence in the Federal Style. Examples of Federal Style plantation residences in Mississippi are scarce, as most were replaced by finer Greek Revival residences during the twenty year period preceeding the Civil War when the planting economy of Mississippi reached its greatest heights. The house and surrounding 764.83-acre plantation gain further significance from their long history of family ownership, the first 587.34 acres having been acquired in 1815 by the great-great-grandfather of the present owner, Mrs. Lillian Baker Valentine. The size of the plantation is also exceptionally unusual for Mississippi plantations as most of them were long ago divided into smaller farms or subdivided for housing construction. The house possesses many characteristics which make it typical of the residences constructed in the Natchez area of the lower Mississippi Valley region. One of these characteristics is its front gallery (a gallery being the regional term to define a porch which extends the full width of the house) which is cut under the front slope of the roof rather than attached. Another regional characteristic is its floor plan which features a single-pile plan with small rooms, or "cabinets," enclosed at either end of an undercut rear gallery (similar to The Briers and John Baynton House). This basic plan evolved later into a double-pile plan with a rear gallery flanked by "cabinets" (The Cliffs Plantation and Winchester House) and into a plan in which the rear gallery area was originally enclosed as a room (Sunnyside). The configuration of the rear gallery and flanking cabinet rooms at Pecan Grove was altered very early to enlarge the cabinets into sizeable rooms and reduce the rear gallery to the function of a passage or hallway. Very unusual for Mississippi are the mantel pieces in the central front room and the adjacent room to the north which feature mantel shelves that wrap around the side of the chimney wall. This feature is more common to the New Orleans area of Louisiana than to Mississippi.

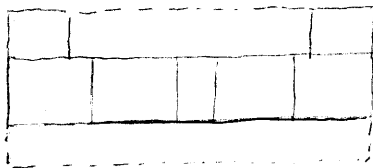

The Briers

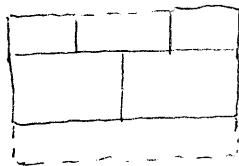

John Baynton House

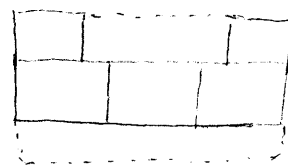

Pecan Grove

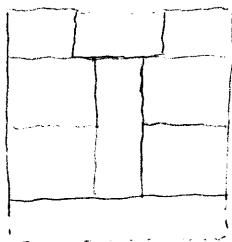

The Cliffs

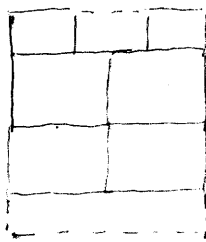

Winchester House

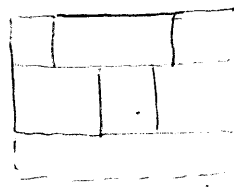

Sunnyside

**NATIONAL REGISTER OF HISTORIC PLACES
INVENTORY -- NOMINATION FORM**

FOR HCRS USE ONLY	
RECEIVED	OCT 18 1979
DATE ENTERED	MAR 13 1980

CONTINUATION SHEET

ITEM NUMBER 9

PAGE 1

Baker family Bible. Lillian Baker Valentine, Pecan Grove Plantation,
Church Hill, Mississippi.

Historical and Biographical Memoirs of Mississippi. Chicago: The
Goodspeed Publishing Co., 1891.

Jefferson Co., Miss. Chancery Clerk. Deed Books C1, A.

Jefferson Co., Miss. Chancery Clerk. Deed of Trust Book 21.

Jefferson Co., Miss. Chancery Clerk. Probate Box C7.



PECAN GROVE

Church Hill, Jefferson Co., Miss.

Looking westerly, the facade.

Photo 1 of 5

OCT 18 1979

MAR 13 1980



PECAN GROVE

Church Hill, Jefferson Co., Miss.

Looking southeasterly, the
northerly elevation.

Photo 2 of 5

OCT 18 1979

MAR 13 1980



PECAN GROVE

Church Hill, Jefferson Co., Miss.

**Looking westerly, the entrance
doorway.**

Photo 3 of 5

MAR 13 1980

OCT 18 1979



PECAN GROVE

Church Hill, Jefferson Co., Miss.

**Looking northerly, the parlor, or
center front room.**

Photo 4 of 5

OCT 18 1979

MAR 13 1980



PECAN GROVE

Church Hill, Jefferson Co., Miss.

Looking southerly, the mantel
piece in the southernmost front
room.

Photo 5 of 5

OCT 18 1979

MAR 13 1980