

MISSISSIPPI HISTORIC BRIDGE SURVEY

1. Name of Bridge: Waynesboro Bridge

2. Location

Code 153

County Wayne USGS Quadrangle Waynesboro

Town/vicinity Waynesboro vicinity

UTM coordinates:

Zone 16 Easting 341755 Northing 3507720

Acreage less than one Owner Wayne County

Verbal boundary description:

Includes the 18.4 by 162 ft. bridge spanning the Chickasawhay River on Old Highway 84 in Section 2, Township 8 North, Range 7 West.

3. Description

Number of spans 1 Length overall 162 ft. (49.4 m.)

Span types:

(1) Pratt through truss length 162 ft (49.4 m)

(2) _____ length _____

(3) _____ length _____

Truss span components:

Top chords 2 channel beams and 1 plate

End posts 2 channel beams and 1 plate

Bottom chords 3 rectilinear eye-bars

Hip verticals 3 rectilinear eye-bars above 2 channel beams

Intermediate posts 2 channel beams laced together

Diagonals see diagram

Counters see diagram

Connections pins

Piers concrete-filled metal caissons

Condition good. truss is painted. deck is new.

Date of construction 1910

Builder unknown

Source State Highway Department Bridge Inventory

4. Location of Legal Description

Courthouse, Office of the Chancery Clerk
Registry of Deeds, etc.: Wayne County Courthouse
Street & Number: Turner and Azalea Drive
City, Town: Waynesboro State: Mississippi

Profile Sketch

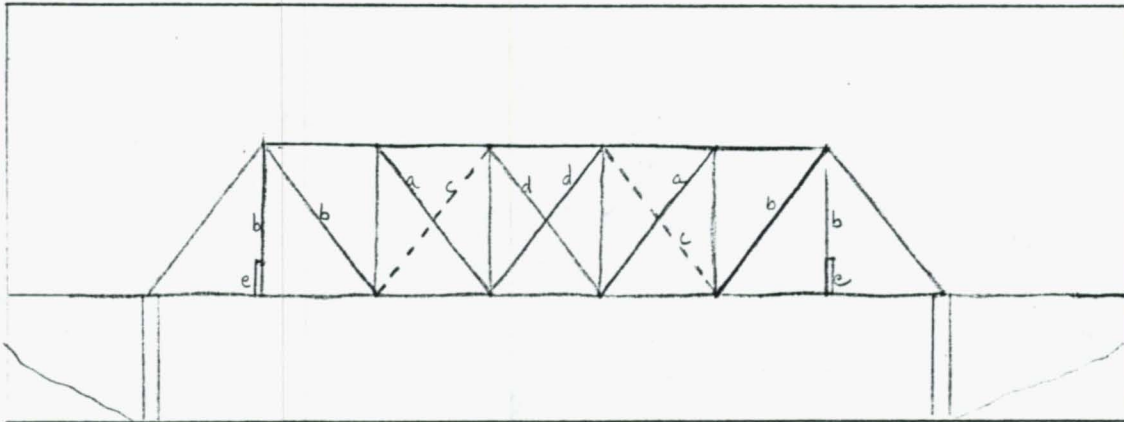

- (a) - 2 rectilinear eye-bars
- (b) - 3 rectilinear eye-bars
- (c) - 1 cylindrical eye-bar
- (d) - 2 cylindrical eye-bars
- (e) - 2 channel beams

5. Significance

Level of significance:

Local ____; State x ; National ____

Statement of significance:

This bridge consists of one Pratt through truss span, which was a commonly used type of truss span in Mississippi during the early 20th century. It is significant in that it embodies "the distinctive characteristics of a type, period, or method of construction."

6. Form prepared by:

Jack D. Elliott, Jr.
Historical Archaeologist
Division of Historic Preservation
Mississippi Department of Archives and History
P.O. Box 571
Jackson, Mississippi 39205

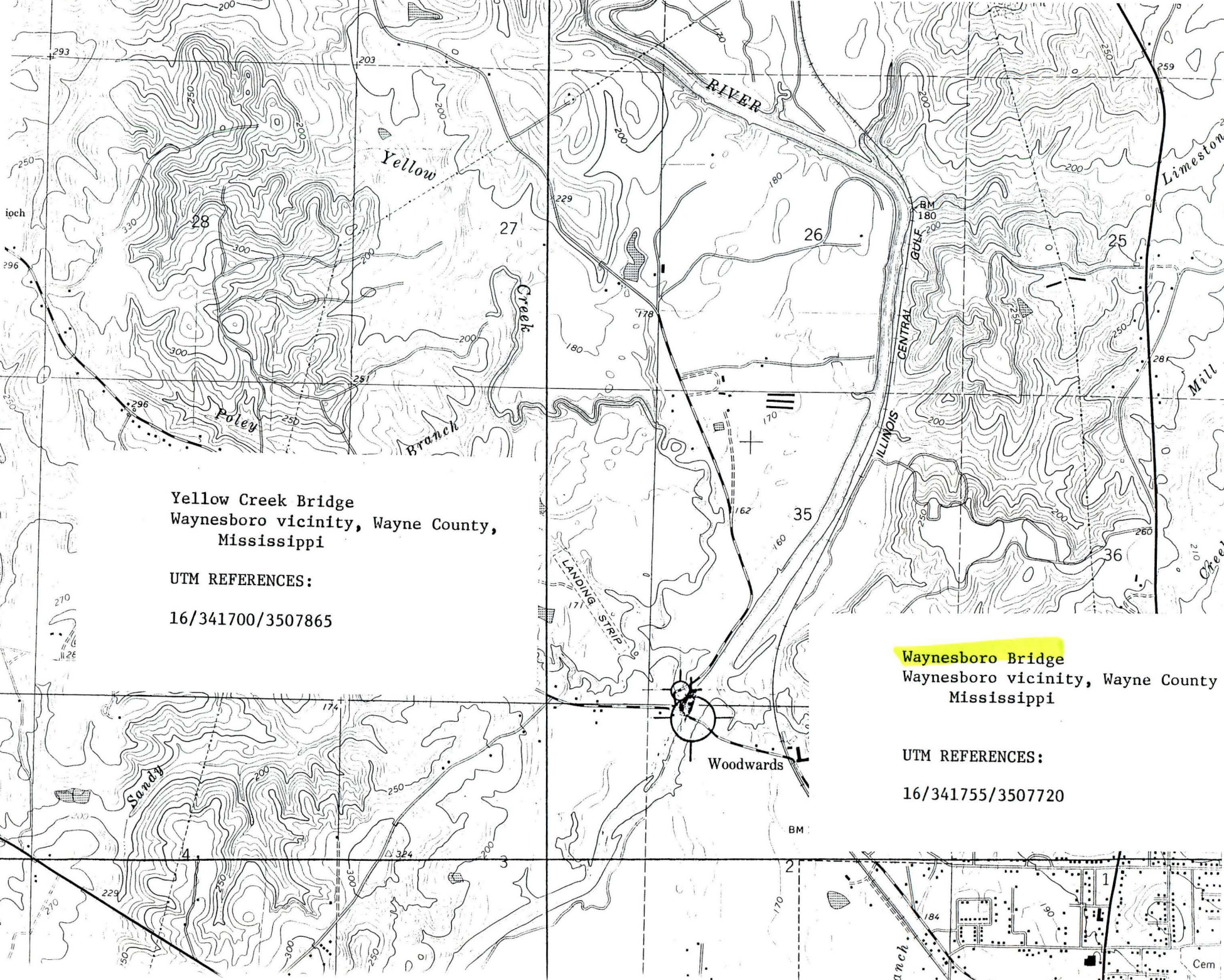

Yellow Creek Bridge
Waynesboro vicinity, Wayne County,
Mississippi

UTM REFERENCES:
16/341700/3507865

Waynesboro Bridge
Waynesboro vicinity, Wayne County
Mississippi

UTM REFERENCES:
16/341755/3507720

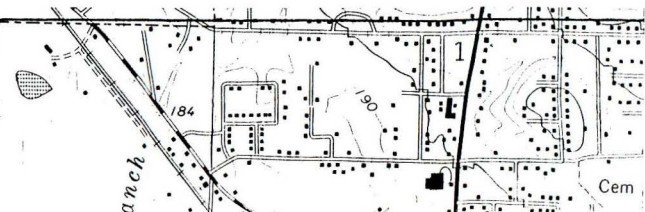



Waynesboro Bridge

Wayne County

Vicinity of Waynesboro, Mississippi

Jack D. Elliott, Jr.

March 14, 1986

Mississippi Department of Archives &
History

View to Northeast