

UNITED STATES DEPARTMENT OF THE INTERIOR
NATIONAL PARK SERVICE

FOR NPS USE ONLY

RECEIVED

DATE ENTERED

**NATIONAL REGISTER OF HISTORIC PLACES
INVENTORY -- NOMINATION FORM**

SEE INSTRUCTIONS IN *HOW TO COMPLETE NATIONAL REGISTER FORMS*
TYPE ALL ENTRIES -- COMPLETE APPLICABLE SECTIONS

1 NAME

HISTORIC

The Junius R. Ward House

AND/OR COMMON

The Erwin House

2 LOCATION

STREET & NUMBER

Old Highway 1

— NOT FOR PUBLICATION

CITY, TOWN

Erwin

 VICINITY OF Chatham

CONGRESSIONAL DISTRICT

Second

STATE

Mississippi

CODE

28

COUNTY

Washington

CODE

151

3 CLASSIFICATION

CATEGORY	OWNERSHIP	STATUS	PRESENT USE	
<input type="checkbox"/> DISTRICT	<input type="checkbox"/> PUBLIC	<input checked="" type="checkbox"/> OCCUPIED	<input type="checkbox"/> AGRICULTURE	<input type="checkbox"/> MUSEUM
<input checked="" type="checkbox"/> BUILDING(S)	<input checked="" type="checkbox"/> PRIVATE	<input type="checkbox"/> UNOCCUPIED	<input type="checkbox"/> COMMERCIAL	<input type="checkbox"/> PARK
<input type="checkbox"/> STRUCTURE	<input type="checkbox"/> BOTH	<input type="checkbox"/> WORK IN PROGRESS	<input type="checkbox"/> EDUCATIONAL	<input checked="" type="checkbox"/> PRIVATE RESIDENCE
<input type="checkbox"/> SITE	<input type="checkbox"/> PUBLIC ACQUISITION	<input type="checkbox"/> ACCESSIBLE	<input type="checkbox"/> ENTERTAINMENT	<input type="checkbox"/> RELIGIOUS
<input type="checkbox"/> OBJECT	<input type="checkbox"/> IN PROCESS	<input checked="" type="checkbox"/> YES: RESTRICTED	<input type="checkbox"/> GOVERNMENT	<input type="checkbox"/> SCIENTIFIC
	<input type="checkbox"/> BEING CONSIDERED	<input type="checkbox"/> YES: UNRESTRICTED	<input type="checkbox"/> INDUSTRIAL	<input type="checkbox"/> TRANSPORTATION
		<input type="checkbox"/> NO	<input type="checkbox"/> MILITARY	<input type="checkbox"/> OTHER:

4 OWNER OF PROPERTY

NAME

Mr. and Mrs. William J. Shutt

STREET & NUMBER

CITY, TOWN

Chatham

— VICINITY OF

STATE

Mississippi

5 LOCATION OF LEGAL DESCRIPTION

COURTHOUSE,

REGISTRY OF DEEDS, ETC.

Washington County Courthouse

STREET & NUMBER

Washington Avenue

CITY, TOWN

Greenville

STATE

Mississippi

6 REPRESENTATION IN EXISTING SURVEYS

TITLE

DATE

 FEDERAL STATE COUNTY LOCALDEPOSITORY FOR
SURVEY RECORDS

CITY, TOWN

STATE

7 DESCRIPTION

CONDITION		CHECK ONE	CHECK ONE
<input type="checkbox"/> EXCELLENT	<input type="checkbox"/> DETERIORATED	<input type="checkbox"/> UNALTERED	<input checked="" type="checkbox"/> ORIGINAL SITE
<input checked="" type="checkbox"/> GOOD	<input type="checkbox"/> RUINS	<input checked="" type="checkbox"/> ALTERED	<input type="checkbox"/> MOVED DATE _____
<input type="checkbox"/> FAIR	<input type="checkbox"/> UNEXPOSED		

DESCRIBE THE PRESENT AND ORIGINAL (IF KNOWN) PHYSICAL APPEARANCE

The Erwin House is a modest wooden structure situated on the north side of Lake Washington at Erwin, Washington County, Mississippi. Typical of many small plantation houses built in the first half of the nineteenth century, the Erwin House is five bays wide and one-and-a-half stories high, with buttressed chimneys on the gabled ends. Standing on a foundation of brick piers, the house is constructed of dressed, half-notched logs covered with clapboarding. Since there remains no evidence of daubing and the notching was not cut to cast off water, it seems clear that the clapboard sheathing is original. The undercut gallery, which extends the full width of the principal block, is treated with simple piers supporting a plain narrow entablature. A pair of paneled pilasters and sections of the original molded cornice are survivals of a more sophisticated gallery treatment. The entrance to the Erwin House, flanked by rectangular sidelights and transom, is contained in a substantial frontispiece with large corner blocks and architraves of a pronounced Gothic profile. Similar treatment was also used around the windows, which symmetrically flank the frontispiece. Originally double hung with six-over-six glazing, they were extended to their current floor length height around 1910. The facade of the main block is emphasized further by the use of flush siding and a high baseboard under the gallery.

Although encumbered by additions, the plan of the Erwin House is a classic Mississippi type. The front, or south, half of the house is arranged according to the traditional single-pile formula with a central stair hall flanked by a large parlor and dining room on either side. Two small cabinets, with an open loggia between, occupy the rear section. Two low chambers without fireplaces are placed on the second floor. Shortly after the completion of the main house around 1830, a single room with a buttressed chimney was added to the west end. Since that time other additions have been attached, removed, and rebuilt, until the rear of the house has developed a disturbing incongruity. Spatial alterations to the original house were limited, however, to the enclosure of the loggia (c. 1910), and to an extension of a rear cabinet (c. 1925).

As in most vernacular structures of the period, the interior of the Erwin House is fitted with simple, yet finely joined, woodwork. Well-proportioned architraves with corner blocks are cut in a double cyma recta profile set between unmolded backbands. Identical mantels, with battered pilasters and paneled friezes, remain intact in each of the four original rooms. The open-newel stair, with its ramped banister and scrolled step-ends is the most ambitious and notable interior feature of the Erwin House.

8 SIGNIFICANCE

PERIOD	AREAS OF SIGNIFICANCE -- CHECK AND JUSTIFY BELOW			
<input type="checkbox"/> PREHISTORIC	<input type="checkbox"/> ARCHEOLOGY-PREHISTORIC	<input type="checkbox"/> COMMUNITY PLANNING	<input type="checkbox"/> LANDSCAPE ARCHITECTURE	<input type="checkbox"/> RELIGION
<input type="checkbox"/> 1400-1499	<input type="checkbox"/> ARCHEOLOGY-HISTORIC	<input type="checkbox"/> CONSERVATION	<input type="checkbox"/> LAW	<input type="checkbox"/> SCIENCE
<input type="checkbox"/> 1500-1599	<input type="checkbox"/> AGRICULTURE	<input type="checkbox"/> ECONOMICS	<input type="checkbox"/> LITERATURE	<input type="checkbox"/> SCULPTURE
<input type="checkbox"/> 1600-1699	<input checked="" type="checkbox"/> ARCHITECTURE	<input type="checkbox"/> EDUCATION	<input type="checkbox"/> MILITARY	<input type="checkbox"/> SOCIAL/HUMANITARIAN
<input type="checkbox"/> 1700-1799	<input type="checkbox"/> ART	<input type="checkbox"/> ENGINEERING	<input type="checkbox"/> MUSIC	<input type="checkbox"/> THEATER
<input checked="" type="checkbox"/> 1800-1899	<input type="checkbox"/> COMMERCE	<input checked="" type="checkbox"/> EXPLORATION/SETTLEMENT	<input type="checkbox"/> PHILOSOPHY	<input type="checkbox"/> TRANSPORTATION
<input type="checkbox"/> 1900-	<input type="checkbox"/> COMMUNICATIONS	<input type="checkbox"/> INDUSTRY	<input type="checkbox"/> POLITICS/GOVERNMENT	<input type="checkbox"/> OTHER (SPECIFY)
		<input type="checkbox"/> INVENTION		

SPECIFIC DATES

c. 1830

BUILDER/ARCHITECT

STATEMENT OF SIGNIFICANCE

Located on Lake Washington at Erwin, Mississippi, the Erwin House is believed to be the oldest extant structure remaining in Washington County and one of the few properties in that area still maintained by descendants of the original grantee. Junius R. Ward (1802-1883), a native of Kentucky who was the first to settle at the head of the lake according to the Papers of the Washington County Historical Society, purchased the property on December 15, 1829, although the patent was delayed until September 1, 1831. In 1830, Ward began construction of the existing dwelling to replace a simple log structure located nearby. According to the 1831 tax records for Washington County, Ward owned an extensive amount of land and 42 slaves; in 1840 he owned 1,875 acres and 65 slaves. The 1850 census records indicate that he owned 750 acres of improved land and 1,200 acres of unimproved land, as well as livestock valued at \$5,400. During this period Ward served as one of eight commissioners of the Lake Washington and Deer Creek Railroad and Banking Company, which was incorporated in 1836. In 1877, title to the property was purchased by Matilda Erwin, Ward's daughter, and her husband, Johnson Erwin of nearby Mount Holly plantation. Their son Victor married Margaret Preston McNeily, the daughter of J. S. McNeily, who was editor of the Woodville Republican, the Greenville Times and the Vicksburg Herald, and who served as a member of the 1890 Mississippi Constitutional Convention. Although McNeily, who served in the 21st Mississippi infantry, C.S.A., apparently never exceeded the rank of private, he was widely known after the Civil War as "Captain" J. S. McNeily. McNeily was a frequent visitor to the Erwin House, where Mrs. Victor Erwin still lives with her daughter, Mrs. William Shutt.

The Erwin House is a valuable example of Mississippi vernacular architecture of the early nineteenth century. Although altered, the basic integrity of the structure has been assured through its continual ownership by one family.

UNITED STATES DEPARTMENT OF THE INTERIOR
NATIONAL PARK SERVICE

FOR NPS USE ONLY

RECEIVED

DATE ENTERED

NATIONAL REGISTER OF HISTORIC PLACES
INVENTORY -- NOMINATION FORM

CONTINUATION SHEET

ITEM NUMBER

PAGE

9. MAJOR BIBLIOGRAPHICAL REFERENCES (continued)

Jackson. Mississippi Department of Archives and History. Eunice Stockwell Papers. Lake Washington folder.

Jackson. Mississippi Department of Archives and History. Subject File. Junius R. Ward.

Laws of the State of Mississippi; Passed at a Regular Biennial Session of the Legislature, held at Jackson, in January & February, A.D. 1836. Jackson: G. R. & J. S. Fall, State Printers, 1836, p. 203.

McCain, William D. and Capers, Charlotte, eds. Memoirs of Henry Tillinghast Ireys, Papers of the Washington County Historical Society, 1910-1915. Jackson, Miss.: Hederman Brothers, 1954, pp. 123-24, 279-80, 305.

Mississippi. Auditor. Real and Personal Tax Rolls, Washington County, 1831, 1840. Official Archives of the State of Mississippi, Record Group 29, vol. 575. Mississippi Department of Archives and History, Jackson.

United States. Bureau of the Census. Agricultural Schedules. Washington County, 1850.

Washington County, Mississippi. Chancery Clerk. Land Entry Book 6, p. 82.

9 MAJOR BIBLIOGRAPHICAL REFERENCES

Compiled Service Records of Confederate Soldiers Who Served in Organizations from Mississippi, 21st Infantry, Mc-0. National Archives, Microcopy No. 269, Roll No. 298.

(continued)

10 GEOGRAPHICAL DATA

ACREAGE OF NOMINATED PROPERTY Five

UTM REFERENCES

A	1,5	6,8,2	2,2,5	3,6,6,4	2,8,0	B					
	ZONE	EASTING	NORTHING				ZONE	EASTING	NORTHING		
C						D					

VERBAL BOUNDARY DESCRIPTION

LIST ALL STATES AND COUNTIES FOR PROPERTIES OVERLAPPING STATE OR COUNTY BOUNDARIES

STATE	CODE	COUNTY	CODE
STATE	CODE	COUNTY	CODE

11 FORM PREPARED BY

NAME / TITLE

William C. Allen, Architectural Historian, Clinton I. Bagley, Historian

ORGANIZATION

Mississippi Department of Archives and History

DATE

March 31, 1975

STREET & NUMBER

P. O. Box 571

TELEPHONE

(601) 354-6218

CITY OR TOWN

Jackson

STATE

Mississippi

12 STATE HISTORIC PRESERVATION OFFICER CERTIFICATION

THE EVALUATED SIGNIFICANCE OF THIS PROPERTY WITHIN THE STATE IS:

NATIONAL

STATE

LOCAL

As the designated State Historic Preservation Officer for the National Historic Preservation Act of 1966 (Public Law 89-665), I hereby nominate this property for inclusion in the National Register and certify that it has been evaluated according to the criteria and procedures set forth by the National Park Service.

FEDERAL REPRESENTATIVE SIGNATURE

Robert B. Hilliard

TITLE

State Historic Preservation Officer

DATE

March 31, 1975

FOR NPS USE ONLY

I HEREBY CERTIFY THAT THIS PROPERTY IS INCLUDED IN THE NATIONAL REGISTER

DATE

DIRECTOR, OFFICE OF ARCHEOLOGY AND HISTORIC PRESERVATION
ATTEST:

DATE

KEEPER OF THE NATIONAL REGISTER

UNITED STATES DEPARTMENT OF THE INTERIOR
NATIONAL PARK SERVICE

NATIONAL REGISTER OF HISTORIC PLACES
PROPERTY MAP FORM

FOR NPS USE ONLY
RECEIVED
DATE ENTERED

SEE INSTRUCTIONS IN *HOW TO COMPLETE NATIONAL REGISTER FORMS*
TYPE ALL ENTRIES -- ENCLOSE WITH MAP

1 NAME

HISTORIC

The Junius R. Ward House

AND/OR COMMON

The Erwin House

2 LOCATION

CITY, TOWN

Erwin

VICINITY OF

Chatham

COUNTY

Washington

STATE

Mississippi

3 MAP REFERENCE

SOURCE U.S.G.S.

SCALE 1:24000

DATE 1970

4 REQUIREMENTS

TO BE INCLUDED ON ALL MAPS

1. PROPERTY BOUNDARIES
2. NORTH ARROW
3. UTM REFERENCES

UNITED STATES DEPARTMENT OF THE INTERIOR
NATIONAL PARK SERVICE

NATIONAL REGISTER OF HISTORIC PLACES
PROPERTY PHOTOGRAPH FORM

FOR NPS USE ONLY
RECEIVED
DATE ENTERED

SEE INSTRUCTIONS IN *HOW TO COMPLETE NATIONAL REGISTER FORMS*
TYPE ALL ENTRIES -- ENCLOSE WITH PHOTOGRAPH

1 NAME

HISTORIC

The Junius R. Ward House

AND/OR COMMON

The Erwin House

2 LOCATION

CITY, TOWN

Erwin

VICINITY OF
Chatham

COUNTY

Washington

STATE

Mississippi

3 PHOTO REFERENCE

PHOTO CREDIT Mississippi Department of Archives and
History

DATE OF PHOTO January, 1975

NEGATIVE FILED AT

Jackson, Mississippi

4 IDENTIFICATION

DESCRIBE VIEW, DIRECTION, ETC. IF DISTRICT, GIVE BUILDING NAME & STREET

PHOTO NO

View of South front

INT: 2983-75

UNITED STATES DEPARTMENT OF THE INTERIOR
NATIONAL PARK SERVICE

NATIONAL REGISTER OF HISTORIC PLACES
PROPERTY PHOTOGRAPH FORM

FOR NPS USE ONLY
RECEIVED
DATE ENTERED

SEE INSTRUCTIONS IN *HOW TO COMPLETE NATIONAL REGISTER FORMS*
TYPE ALL ENTRIES -- ENCLOSE WITH PHOTOGRAPH

1 NAME

HISTORIC

The Junius R. Ward House

AND/OR COMMON

The Erwin House

2 LOCATION

CITY, TOWN

Erwin

VICINITY OF
Chatham

COUNTY

Washington

STATE

Mississippi

3 PHOTO REFERENCE

PHOTO CREDIT Mississippi Department of Archives and
History

DATE OF PHOTO January, 1975

NEGATIVE FILED AT

Jackson, Mississippi

4 IDENTIFICATION

Fish Farm

THE ERWIN HOUSE
ERWIN, MISSISSIPPI
UTM REFERENCE
15/682225/3664280

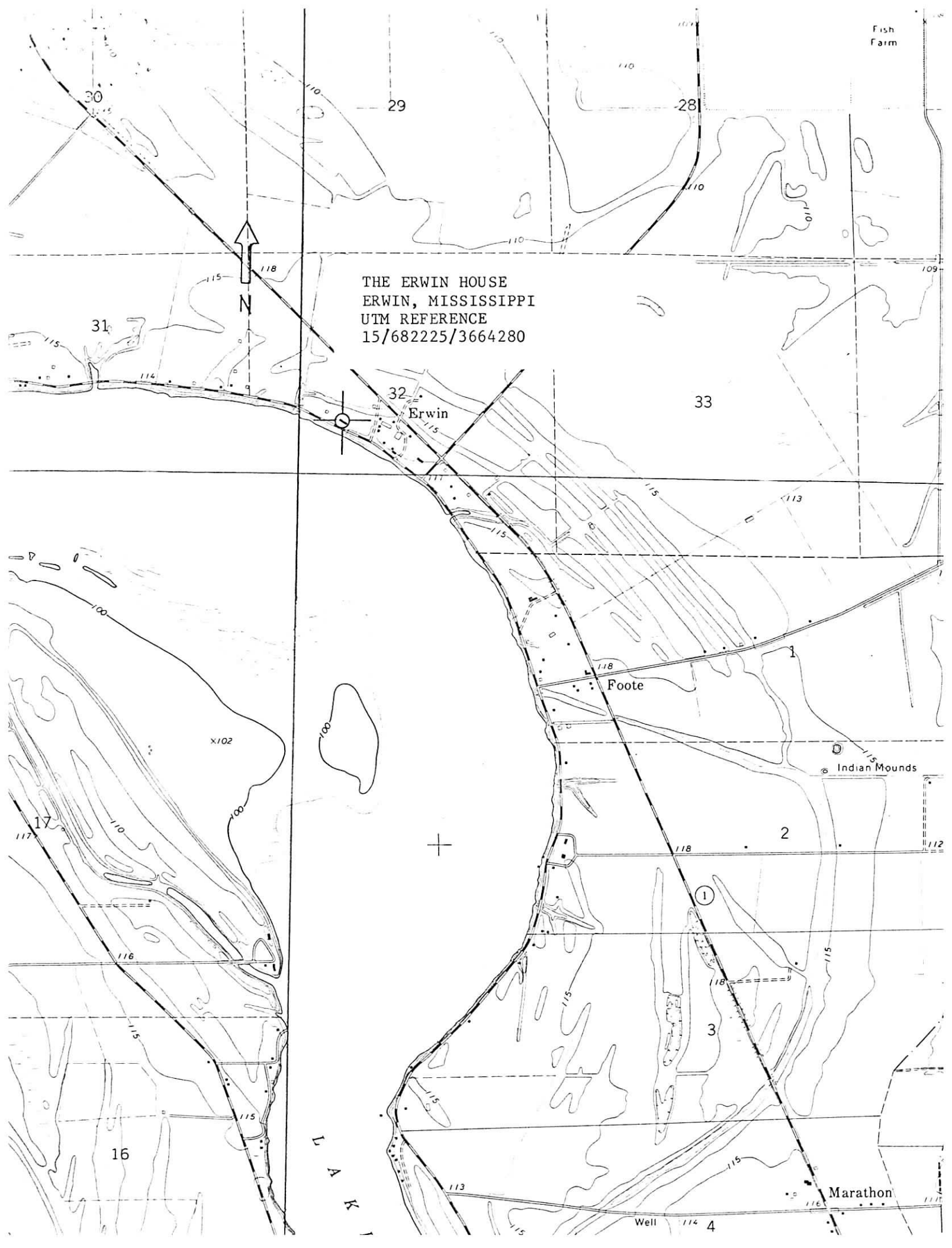

LAKE

Marathon

Well 114 4

Indian Mounds

Foote

Erwin

31

29

28

33

32

16

2

1

3

109

X102



WIM House, Mount Locust
WIM, Miss
1950 CREDIT Dr D.C. Montgomery - Greenville, Miss
May, 1972

STATE WIDE SURVEY
Division of History and Archaeology
Mississippi Department of Archives and History
Washington County
~~28-151-007-0021~~



rwin House - MOUNT LOUIS

rwin, Miss

photo credit

May, 1972

Dr. D. C. Montgomery, Greenville, Miss

STATE WIDE SURVEY

Division of Historic Sites and Archaeology
Mississippi Department of Archives and History

Washington County
~~28-151-007-0021~~