

**United States Department of the Interior
National Park Service**

**National Register of Historic Places
Continuation Sheet**

Section number _____ Page _____

SUPPLEMENTARY LISTING RECORD

NRIS Reference Number: 97000797

Date Listed: 8/1/97

Rankin County Confederate Monument
Property Name

Rankin
County

MISSISSIPPI
State

Brandon MPS
Multiple Name

This property is listed in the National Register of Historic Places in accordance with the attached nomination documentation subject to the following exceptions, exclusions, or amendments, notwithstanding the National Park Service certification included in the nomination documentation.

Mal M. Way
for **Signature of the Keeper**

9/2/97
Date of Action

=====
Amended Items in Nomination:

Section No. 10: This nomination is amended to show that the acreage of the property is less than one acre.

This change has been confirmed with the Mississippi SHPO.

DISTRIBUTION:

- National Register property file
- Nominating Authority (without nomination attachment)

United States Department of the Interior
National Park Service

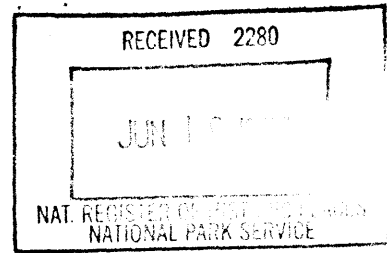

797

National Register of Historic Places Registration Form

1. Name of Property

historic name: Rankin County Confederate Monument

other name/site number: _____

2. Location

street & number: intersection of Government St. and North St. N/A not for publication

city or town: Brandon N/A vicinity

state Mississippi code MS county Rankin code 121 zip code 39042

3. State/Federal Agency Certification

As the designated authority under the National Historic Preservation Act of 1986, as amended, I hereby certify that this nomination request for determination of eligibility meets the documentation standards for registering properties in the National Register of Historic Places and meets the procedural and professional requirements set forth in 36 CFR Part 60. In my opinion, the property meets does not meet the National Register Criteria. I recommend that this property be considered significant nationally statewide locally. (See continuation sheet for additional comments.)

Kenneth H. P. Paul JUNE 12, 1997
Signature of certifying official Date

Deputy State Historic Preservation Officer

State or Federal agency and bureau

In my opinion, the property meets does not meet the National Register criteria. (See continuation sheet for additional comments.)

Signature of commenting or other official Date

State or Federal agency and bureau

4. National Park Service Certification

I, hereby certify that this property is:
 entered in the National Register
 See continuation sheet.
 determined eligible for the
 National Register
 See continuation sheet.
 determined not eligible for the
 National Register
 removed from the National
 Register
 other (explain): _____

for Signature of the Keeper Date of Action
Mag M. W. 8/11/97

Confederate Monument
Name of Property

Rankin, MS
County and State

5. Classification

Ownership of Property: public-local

Category of Property: object

Number of Resources within Property:

(Do not include previously listed resources in the count)

Contributing	Noncontributing	
0	0	buildings
0	0	sites
0	0	structures
1	0	objects
1	0	Total

Name of related multiple
property listing: Architectural and Historic
Resources in Brandon, MS

Number of contributing resources previously
listed in the National Register: 0

6. Function or Use

Historic Functions: Recreation and Culture

Sub: monument/marker

Current Functions: Recreation and Culture

Sub: monument/marker

7. Description

Architectural Classification:

N/A

Other Description:

Materials

foundation BRICK and CONCRETE
roof N/A
walls N/A
other base: granite/marble
shaft: marble
sculpture: granite

Narrative Description

See Continuation Sheet 7-1.

Confederate Monument
Name of Property

Rankin, MS
County and State

8. Statement of Significance

Applicable National Register Criteria

Areas of Significance

- A** Property is associated with events that have made a significant contribution to the broad patterns of our history.
- B** Property is associated with the lives of persons significant in our past.
- C** Property embodies the distinctive characteristics of a type, period, or method of construction or represents the work of a master, or possesses high artistic values, or represents a significant and distinguishable entity whose components lack individual distinction.
- D** Property has yielded, or is likely to yield, information important in prehistory or history.

ART
Social History

Period of Significance

1907

Significant Dates

1907

Criteria Considerations

Property is:

- A** owned by a religious institution or used for religious purposes
- B** removed from its original location.
- C** a birthplace or grave
- D** a cemetery
- E** a reconstructed building, object, or structure
- F** a commemorative property
- G** less than 50 years of age or achieved significance within the past 50 years.

Significant Persons

N/A

Cultural Affiliation

N/A

Architect/Builder

Narrative Statement of Significance

See Continuation Sheet 7-2.

9. MAJOR BIBLIOGRAPHICAL REFERENCES

Bibliography

See continuation sheet.

Previous Documentation on File (NPS): N/A

- preliminary determination of individual listing (36 CFR 67) has been requested.
- previously listed in the National Register
- previously determined eligible by the National Register
- designated a National Historic Landmark
- recorded by Historic American Buildings Survey

- recorded by Historic American Engineering Record

Primary Location of Additional Data:

- State Historic Preservation Office
 - Other State agency
 - Federal agency
 - Local government
 - University
 - Other
- Name of repository:

Confederate Monument
Name of Property

Rankin, MS
County and State

10. Geographical Data

Acreage of Property: Less than one acre

USGS Quad Map Name:

UTM References:	Zone	Easting	Northing	Zone	Easting	Northing
1	<u>16</u>	<u>218670</u>	3574760	3	_____	_____
2	_____	_____	_____	4	_____	_____

___ See continuation sheet.

Verbal Boundary Description: See continuation sheet.

Boundary Justification: See continuation sheet.

11. Form Prepared By

name/title: John Linn Hopkins & Marsha R. Oates
organization: Hopkins & Associates date:
street & number: 974 Philadelphia Street telephone: (901) 278-5186
city or town: Memphis state: TN zip code: 38104

Property Owner

name: Rankin County
street & number: 301 Town Square telephone: (601) 825-1475
city or town: Brandon state: MS zip code: 39042

United States Department of the Interior
National Park Service

National Register of Historic Places
Continuation Sheet

Confederate Monument
Brandon, Rankin County, MS

Section number 7 Page 1

7. Narrative Description

The Rankin County Confederate Monument, erected in 1907, stands on a low, flat median strip landscaped with small shrubs and annuals on Government Street (US Hwy. 80) at its intersection with North Street, to the west of the Rankin County Courthouse. The monument is 37 feet high and consists of a four level stepped base with the bottom step of granite and the three others of marble; and a marble shaft capped by a 7 foot tall granites statue of a Confederate soldier, facing west in a "lookout" posture. The west face of the monument has low reliefs of a crossed rifle and sword and a bayonet beneath a Confederate flag in the section of the shaft below the soldier and above the shaft's square pedestal which has inscriptions on each of its sides. The inscriptions are:

on the west:

LORD GOD OF HOSTS
BE WITH US YET
LEST WE FORGET,
LEST WE FORGET.

ERECTED BY
BRANDON CHAPTER
UNITED DAUGHTERS
OF THE CONFEDERACY
1861 - DEO VINDICE- 1865

on the east:

TO THOSE WHO WORE THE GREY,
IN LEGEND AND IN LAY OUR HEROES
IN GREY, SHALL FOREVER
LIVE OVER AGAIN FOR US.

THE EPITAPH OF THE SOLDIER
WHO FALLS WITH HIS
COUNTRY, IS WRITTEN IN
THE HEARTS OF THOSE
WHO LOVE THE RIGHT
AND HONOR THE BRAVE.

on the north:

STATES' RIGHTS AND HOME RULE
TRUTH CRUSHED TO EARTH
WILL RISE AGAIN.
MEN DIE, PRINCIPLES
LIVE FOREVER.
ALTHOUGH CONQUERED
WE ADORE IT;
WEEP FOR THOSE
WHO FELL BEFORE IT;
PARDON FOR THOSE WHO
TRAILED AND TORE IT.

THE CORNER STONE LAID BY
THE GRAND LODGE OF F. & A.M.
OF MISSISSIPPI. E. J. MARTIN,
ACTING GRAND MASTER,
NOV. 1, 1907

and on the south side: -

LOVE'S TRIBUTE
TO THE NOBLE MEN
WHO MARCHED
NEATH THE FOLDS
OF THE "STARS AND BARS"
AND WHO WERE FAITHFUL
TO THE END.

"UNDER THE SOD & DEW,
WAITING FOR THE JUDGMENT
DAY."

United States Department of the Interior
National Park Service

National Register of Historic Places Continuation Sheet

Confederate Monument
Brandon, Rankin County, MS

Section number 8 Page 2

8. Narrative Statement of Significance

The Confederate Monument in Brandon, erected in 1907, is nominated for listing on the National Register under Criterion A as a locally important example of the extensive effort to memorialize the Confederacy which was a major expression of social and civic consciousness in the South from the 1870s until the First World War, part of the development of a sense of a Southern regional identity during that period. It is also nominated under Criterion C for Art as a locally important example of sculpture which, while it is a conventional or stock sculptural piece more important for its historical association than for its artistic merit, is the primary example of public statuary in Rankin County. While this is a commemorative property subject to Criteria Consideration F, it merits National Register eligibility as an expression of the Confederate Memorial movement which was a historically significant social movement in the postbellum South.

The monument is located on a median in Brandon's major urban street, in a prominent site near the courthouse, and serves as a significant local landmark. It is the only major outdoor sculpture in Brandon, other than funerary monuments.

For an approximately fifty year period dating from the 1870s until WWI, both the North and the South built a profusion of monuments commemorating individual heroes, specific battles and the general soldiery of the Civil War. Most often, these memorials were placed on the grounds of state capitols, as in Jackson, MS and Nashville, TN; in cemeteries; on the grounds of city halls, post offices, or schools, such as the monument at the University of MS in Oxford; arrayed along a median strip, as on Monument Avenue in Richmond, VA or Monroe Street in Vicksburg, MS; or at an intersection of two streets, such as that at Okolona, MS; or on an island or median in the street, as seen in Port Gibson, MS and in Brandon. Confederate monuments in Aberdeen, Corinth and Tupelo were moved from their original street locations to sites on the courthouse grounds.

Mississippi has many Confederate monuments, but not every county has one in a prominent public location. Many of Mississippi's oldest Confederate monuments (ca. 1870-ca. 1900) are in cemeteries. Public monuments to Confederate soldiers, most dating from ca. 1900 to 1917, stand on the grounds of approximately 27 of the 92 active county courthouses in the state and at 3 former courthouses or courthouse sites. About 12 other county seats have Confederate

United States Department of the Interior
National Park Service

National Register of Historic Places Continuation Sheet

Confederate Monument
Brandon, Rankin County, MS

Section number 8 Page 3

8. Narrative Statement of Significance, continued

monuments in public squares, on street medians, at intersections or in parks, as do several communities that are not county seats. ¹

The Confederate monument in Brandon was largely the result of the efforts of the Brandon Chapter of the United Daughters of the Confederacy (UDC), which was organized in 1903 with seven charter members. The UDC chapter solicited subscriptions, had fund raising events, and asked the Board of Supervisors for a contribution to pay the \$3000 cost of the monument. The cornerstone was laid with Masonic ceremonies on November 1, 1907 and the statue was unveiled on November 29 of that same year. Mayor G. O. Robinson gave a welcoming speech to the Confederate veterans and other observers, UDC officers made speeches, and school children sang "Dixie" and "The Bonnie Blue Flag." During the ceremonies, the UDC chapter consigned the monument to the care of the Board of Supervisors.

Local historical tradition maintains that most Confederate monuments face north. ² Rankin County's monument faces west, the direction from which the Federal troops entered Brandon. Local tradition holds that "the monument marks the spot where General Sherman ordered his troops to stack arms during the siege of Brandon...."³

The Rankin County Confederate monument in Brandon is a good example of public commemorative statuary which symbolically expresses one of the prevalent societal attitudes of a small Southern town in the early years of the twentieth century.

¹ Richard J. Cawthon, material compiled from files of Historic Preservation Division, MS. Dept. of Archives and History. Jackson, MS.

² Rankin County Historical Society, Inc., *A History of Rankin County*, 2 vols. (Brandon, MS.: Rankin County Historical Society, 1988) 2: 85.

³ *Rankin County, a Historical Sketch* (Brandon: Rankin County Board of Supervisors and Rankin County Chamber of Commerce, 1979) n. p.

United States Department of the Interior
National Park Service

National Register of Historic Places Continuation Sheet

Confederate Monument
Brandon, Rankin County, MS

Section number 9 Page 4

9. Major Bibliographical References

Foster, Gaines M. *Ghosts of the Confederacy: Defeat, the Lost Cause, and the Emergence of the New South, 1865-1913*. Oxford UP, 1988.

History of Rankin County. 2 vols. Brandon, MS: Rankin County Historical Society, Inc., 1988.

Jackson, Mississippi. Mississippi Department of Archives and History. Historic Preservation Division. Files of the Chief Architectural Historian.

Rankin County, a Historical Sketch. Brandon, MS: Rankin County Board of Supervisors and Rankin County Chamber of Commerce, 1979.

United States Department of the Interior
National Park Service

National Register of Historic Places Continuation Sheet

Confederate Monument
Brandon, Rankin County, MS

Section number 10 Page 5

10. Geographical Data

Verbal Boundary Description

See accompanying scale map.

Boundary Justification

The boundaries include all of the highway median that is historically associated with the Confederate Monument.

United States Department of the Interior
National Park Service

National Register of Historic Places Continuation Sheet

Confederate Monument
Brandon, Rankin County, MS

Section number photo Page 6

Photograph List

Rankin County Confederate Monument
Intersection of Government and North streets
Brandon, Rankin County, MS

Photos by: John Linn Hopkins

Date: March, 1997

Negatives: Mississippi Department of Archives and History

Photo 1 of 2

View of the Rankin County Confederate Monument looking northeast across the Town Square towards the Rankin County Courthouse.

Photo 2 of 2

View of the front of the Rankin County Confederate Monument.

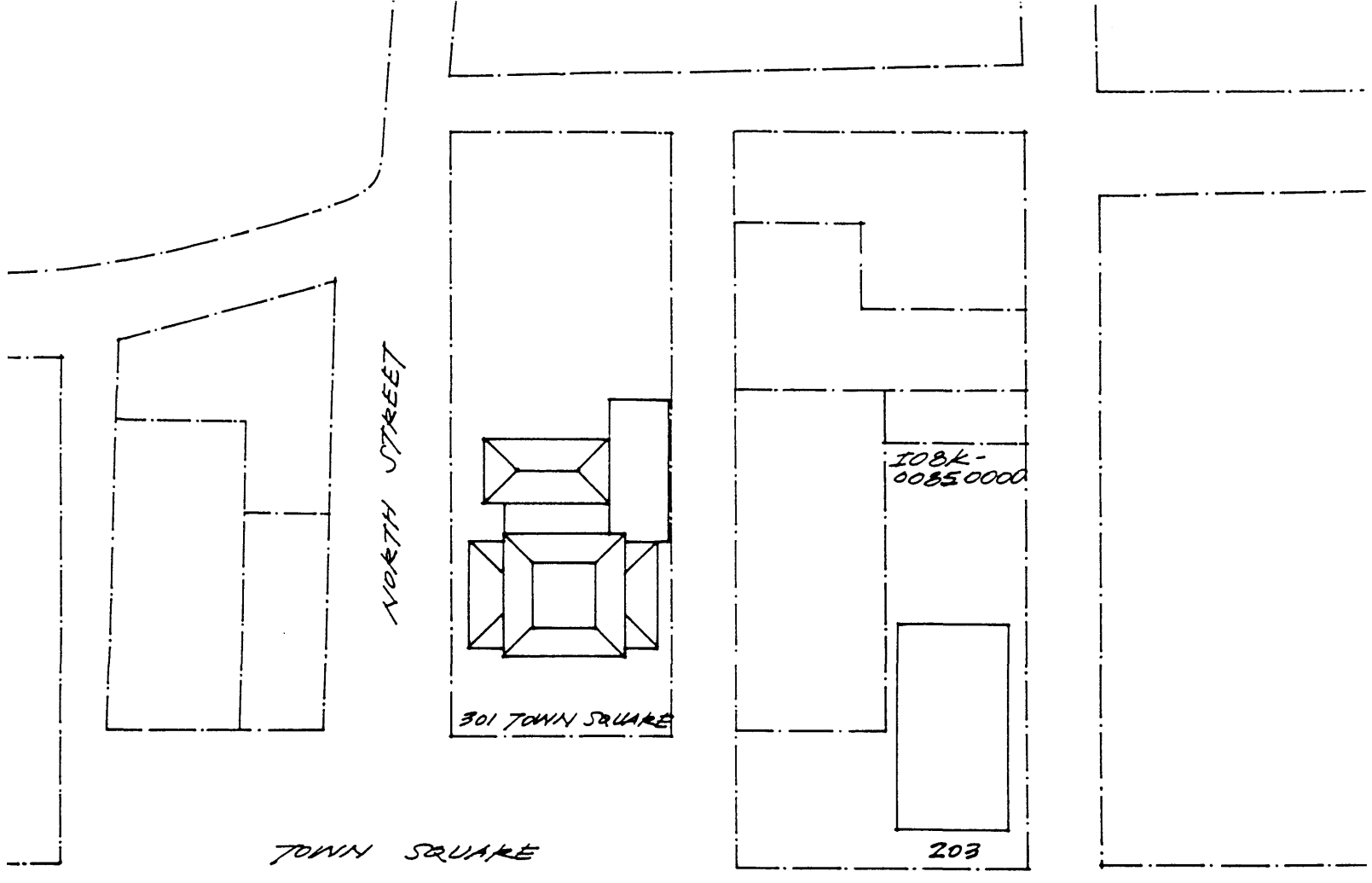

GOVERNMENT STREET

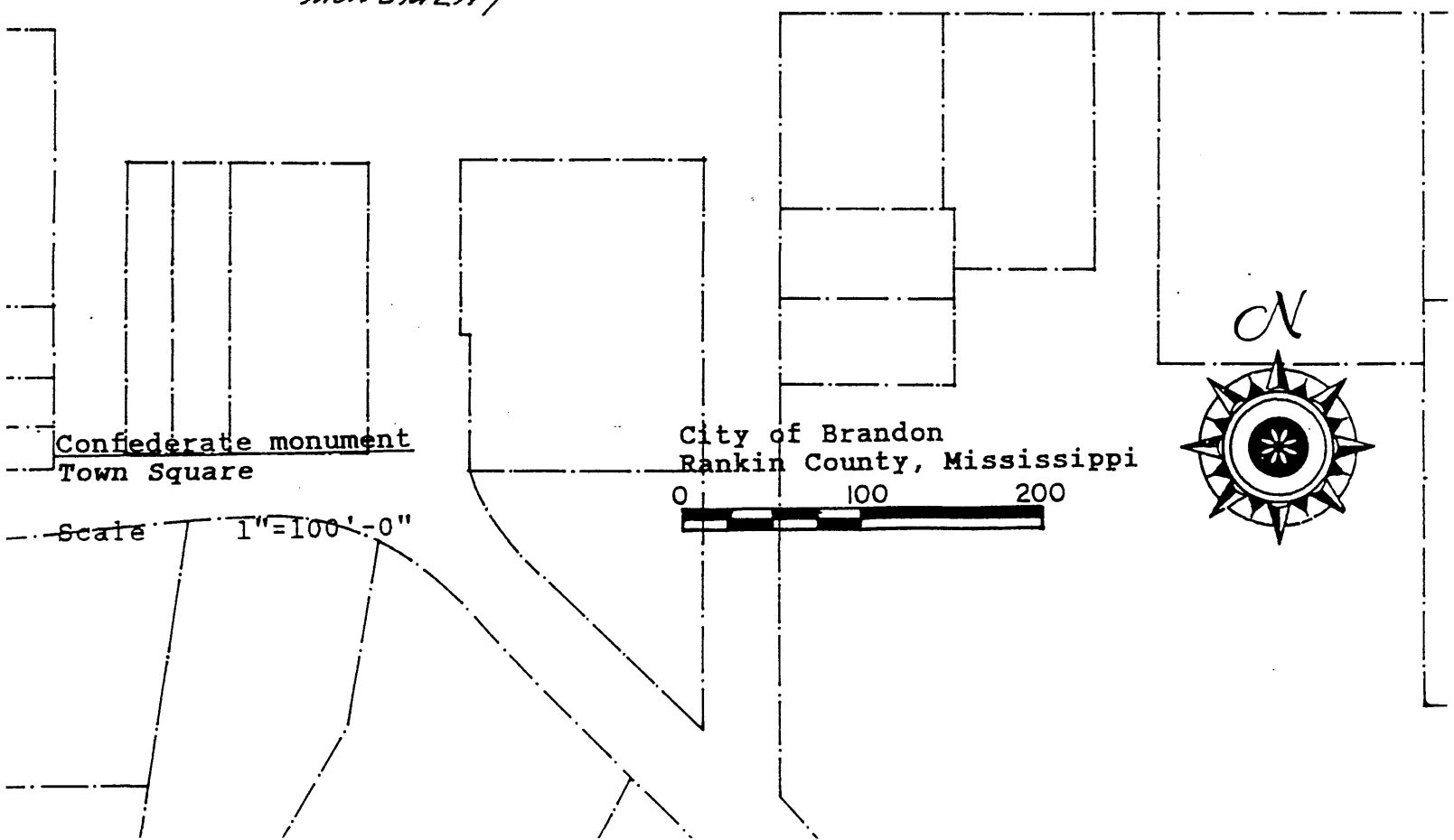

Confederate monument
Town Square

City of Brandon
Rankin County, Mississippi

Scale 1"=100'-0"

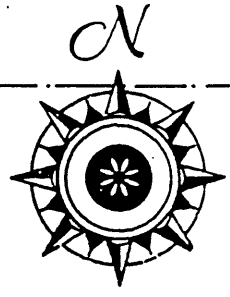
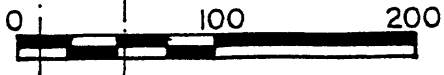

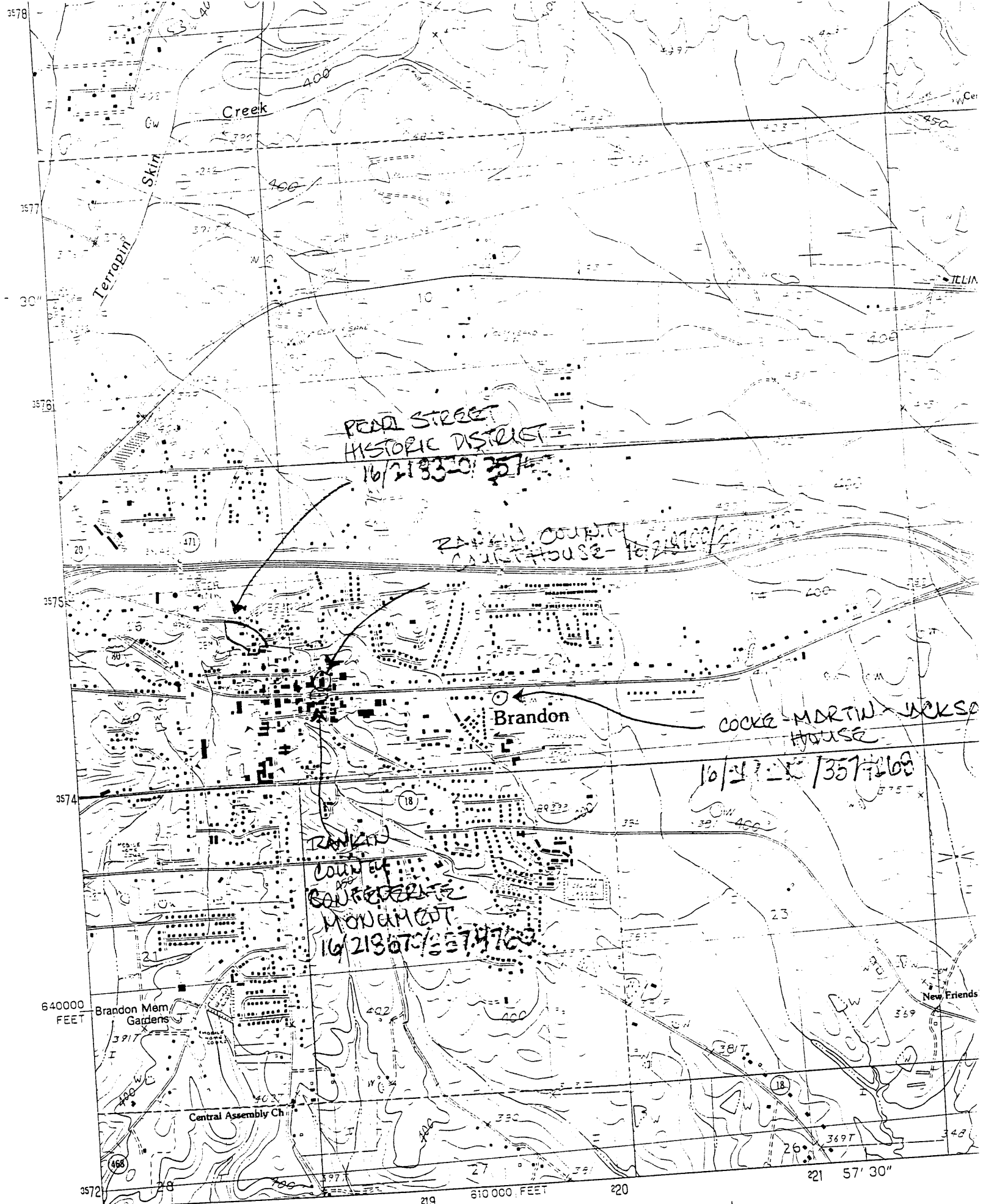

PRODUCED BY THE UNITED STATES GEOLOGICAL SURVEY
 CONTROL BY USGS AND NOS. NOAA 1976
 COMPILED FROM AERIAL PHOTOGRAPHS TAKEN 1982

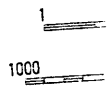



RANKIN CO. CONFEDERATE MONUMENT
GOVERNMENT & NORTH STS.
BRANDON, RANKIN CO., MS
PHOTO 1 OF 2



RANKIN CO. CONFEDERATE MONUMENT
GOVERNMENT & NORTH SIS.

BRANDON, RANKIN CO., MS

PHOTO 2082