

**United States Department of the Interior  
Heritage Conservation and Recreation Service**

**National Register of Historic Places  
Inventory—Nomination Form**

See instructions in *How to Complete National Register Forms*  
Type all entries—complete applicable sections

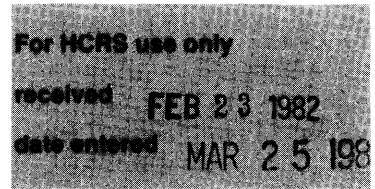

**1. Name**

historic Same  
and/or common Keyhole House

**2. Location**

street & number 1016 Main Street N/A not for publication  
city, town Natchez N/A vicinity of congressional district Fourth  
state Mississippi code 28 county Adams code 1

**3. Classification**

<b>Category</b>	<b>Ownership</b>	<b>Status</b>	<b>Present Use</b>
<input type="checkbox"/> district	<input type="checkbox"/> public	<input checked="" type="checkbox"/> occupied	<input type="checkbox"/> agriculture
<input checked="" type="checkbox"/> building(s)	<input checked="" type="checkbox"/> private	<input type="checkbox"/> unoccupied	<input type="checkbox"/> commercial
<input type="checkbox"/> structure	<input type="checkbox"/> both	<input type="checkbox"/> work in progress	<input type="checkbox"/> educational
<input type="checkbox"/> site	<b>Public Acquisition</b>	<b>Accessible</b>	<input checked="" type="checkbox"/> private residence
<input type="checkbox"/> object	<input type="checkbox"/> in process	<input type="checkbox"/> yes: restricted	<input type="checkbox"/> religious
	<u>N/A</u> being considered	<input checked="" type="checkbox"/> yes: unrestricted	<input type="checkbox"/> scientific
		<input type="checkbox"/> no	<input type="checkbox"/> transportation
			<input type="checkbox"/> other:

**4. Owner of Property**

name Warren William Maxie, Jr., and Anabel Young Maxie  
street & number 1016 Main Street  
city, town Natchez N/A vicinity of state Mississippi

**5. Location of Legal Description**

courthouse, registry of deeds, etc. Office of the Chancery Clerk  
Adams County Courthouse  
street & number Courthouse Square  
city, town Natchez state Mississippi

**6. Representation in Existing Surveys**

title N/A has this property been determined eligible?  yes  no  
date  federal  state  county  local  
depository for survey records  
city, town state

---

## 7. Description

---

**Condition**

excellent  
 good  
 fair

deteriorated  
 ruins  
 unexposed

**Check one**

unaltered  
 altered

**Check one**

original site  
 moved      date N/A

---

**Describe the present and original (if known) physical appearance**

The two-story red brick building faces northerly from its position on a large lot on the southwest corner of Main Street with Arlington Avenue. There is a one-story wing to the westerly side. One-story porches across the front of the house and wing have turned wood columns with jigsaw brackets, railings with turned wood balusters, spindle friezes, and broken wheel-like decorations between the doubled columns of the main porch. The entrance onto this main porch is emphasized by a slightly projecting pedimented bay with a circular opening having a radiating, stick surround, suggesting a traditional Chinese form.

Above the entrance porch there is a small balcony with a single central turned column and large quarter-circle brackets supporting a shingled gable. Adjacent to this unusual element is a large shingled gable containing a slightly projecting bay with two tall floor to ceiling windows on the first floor opening to the gallery and a single tall window on the second floor with a keyhole-shaped stone enframingent. This window, suggesting a Moorish influence, has caused the house to become known as the "Keyhole House". The westerly side of the house is marked by another shingled gable, at the apex of which rises a large chimney. The one-story wing on this side of the house also has a shingled gable with a chimney at its peak. On the easterly, or Arlington Avenue, side of the house, there is a porte cochere with a small stair leading to a side entrance door, which is actually a floor to ceiling window. Above, there is a small roofed balcony. Both porte cochere and balcony have turned columns and spindle work like that of the front porches. The front entrance, with an ornate wood enframingent, has a pair of double doors with small square lights in the upper part and wood panels below.

The entrance doors open into a hall with a fireplace to the right and wide double sliding doors opening into a large, nearly square room to the left. The hall fireplace has an elaborate wood mantel with a facing of decorative tile containing figures representing morning, noon and night. The room to the left, and the room behind it, have corner fireplaces, back to back, each with elaborate carved wood mantels with tile facings and mirrors above. The ceilings are coved and the front room has a square plaster ceiling centerpiece. The two rooms on the left have a pair of large sliding doors between them.

In the rear part of the entrance hall, separated from the front by a pair of turned wood posts supporting a cross beam, there is an elaborate staircase with a jigsaw railing. To the right rear of the entrance hall, a doorway leads into a large room forming the right wing of the house. This room also has a fireplace with a wood mantel, wood over-mantel with mirror, and tile facing. The coved ceiling has a circular plaster centerpiece. Large windows on three sides of this room admit an abundance of light. A floor to ceiling window provides entrance to this room from the porch across the front of this one-story wing.

The house possesses a high degree of architectural integrity. Exterior alteration has been limited to the addition of a small frame-with-brick-veneer room attached to the back porch and the enclosure of the back porch on both levels. Interior alterations have been limited to remodeling of the kitchen and two baths.

## 8. Significance

Period	Areas of Significance—Check and justify below			
<input type="checkbox"/> prehistoric	<input type="checkbox"/> archeology-prehistoric	<input type="checkbox"/> community planning	<input type="checkbox"/> landscape architecture	<input type="checkbox"/> religion
<input type="checkbox"/> 1400-1499	<input type="checkbox"/> archeology-historic	<input type="checkbox"/> conservation	<input type="checkbox"/> law	<input type="checkbox"/> science
<input type="checkbox"/> 1500-1599	<input type="checkbox"/> agriculture	<input type="checkbox"/> economics	<input type="checkbox"/> literature	<input type="checkbox"/> sculpture
<input type="checkbox"/> 1600-1699	<input checked="" type="checkbox"/> architecture	<input type="checkbox"/> education	<input type="checkbox"/> military	<input type="checkbox"/> social/ humanitarian
<input type="checkbox"/> 1700-1799	<input type="checkbox"/> art	<input type="checkbox"/> engineering	<input type="checkbox"/> music	<input type="checkbox"/> theater
<input checked="" type="checkbox"/> 1800-1899	<input type="checkbox"/> commerce	<input type="checkbox"/> exploration/settlement	<input type="checkbox"/> philosophy	<input type="checkbox"/> transportation
<input type="checkbox"/> 1900-	<input type="checkbox"/> communications	<input type="checkbox"/> industry	<input type="checkbox"/> politics/government	<input type="checkbox"/> other (specify)
		<input type="checkbox"/> invention		

**Specific dates** 1888-1901      **Builder/Architect** Unknown

### Statement of Significance (in one paragraph)

The "Keyhole House" is a regionally rare example of domestic architecture exhibiting an Oriental, or Moorish, influence as well as a shingle-style influence. The mass and form, the consistent character and fine workmanship of its details, both inside and out, make this unusual house one of the most architecturally significant of the late nineteenth century houses of Natchez. This house is classified as an "important" landmark building in the Natchez-Adams County Landmarks Inventory by Arch Winter and Sam Wilson. The house was constructed prior to September, 1901, the date of a Sanborn Insurance Map depicting the house on its lot.

UTM NOT VERIFIED  
ACRAGE NOT VERIFIED

# 9. Major Bibliographical References

Adams County Deed Books, Adams County Courthouse, Chancery Clerk's Office.

# 10. Geographical Data

Acreege of nominated property 1<sup>+</sup> acre

Quadrangle name Natchez

Quadrangle scale 1:24000

### UMT References

A 

1	5	6	5	2	2	1	5	3	4	9	2	8	0	0
Zone		Easting				Northing								

B 

Zone		Easting				Northing								

C 

Zone		Easting				Northing								

D 

Zone		Easting				Northing								

E 

Zone		Easting				Northing								

F 

Zone		Easting				Northing								

G 

Zone		Easting				Northing								

H 

Zone		Easting				Northing								

### Verbal boundary description and justification

See attached Xerox of Natchez City Tax Map with nominated property outlined in red.

### List all states and counties for properties overlapping state or county boundaries

state N/A code county code

state code county code

# 11. Form Prepared By

name/title Mrs. Anabel Y. Maxie

organization N/A date December 26, 1980

street & number 1016 Main Street telephone (601) 442-2975

city or town Natchez state Mississippi

# 12. State Historic Preservation Officer Certification

The evaluated significance of this property within the state is:

national  state  local

As the designated State Historic Preservation Officer for the National Historic Preservation Act of 1966 (Public Law 89-665), I hereby nominate this property for inclusion in the National Register and certify that it has been evaluated according to the criteria and procedures set forth by the Heritage Conservation and Recreation Service.

State Historic Preservation Officer signature Robert G. Bailey

title Deputy State Historic Preservation Officer date February 9, 1982

**For HCRS use only**

I hereby certify that this property is included in the National Register

William Byers Entered in the National Register date 3/25/82

Keeper of the National Register

Attest: \_\_\_\_\_ date \_\_\_\_\_

Chief of Registration

KEYHOLE HOUSE  
Natchez, Adams County, Mississippi

29

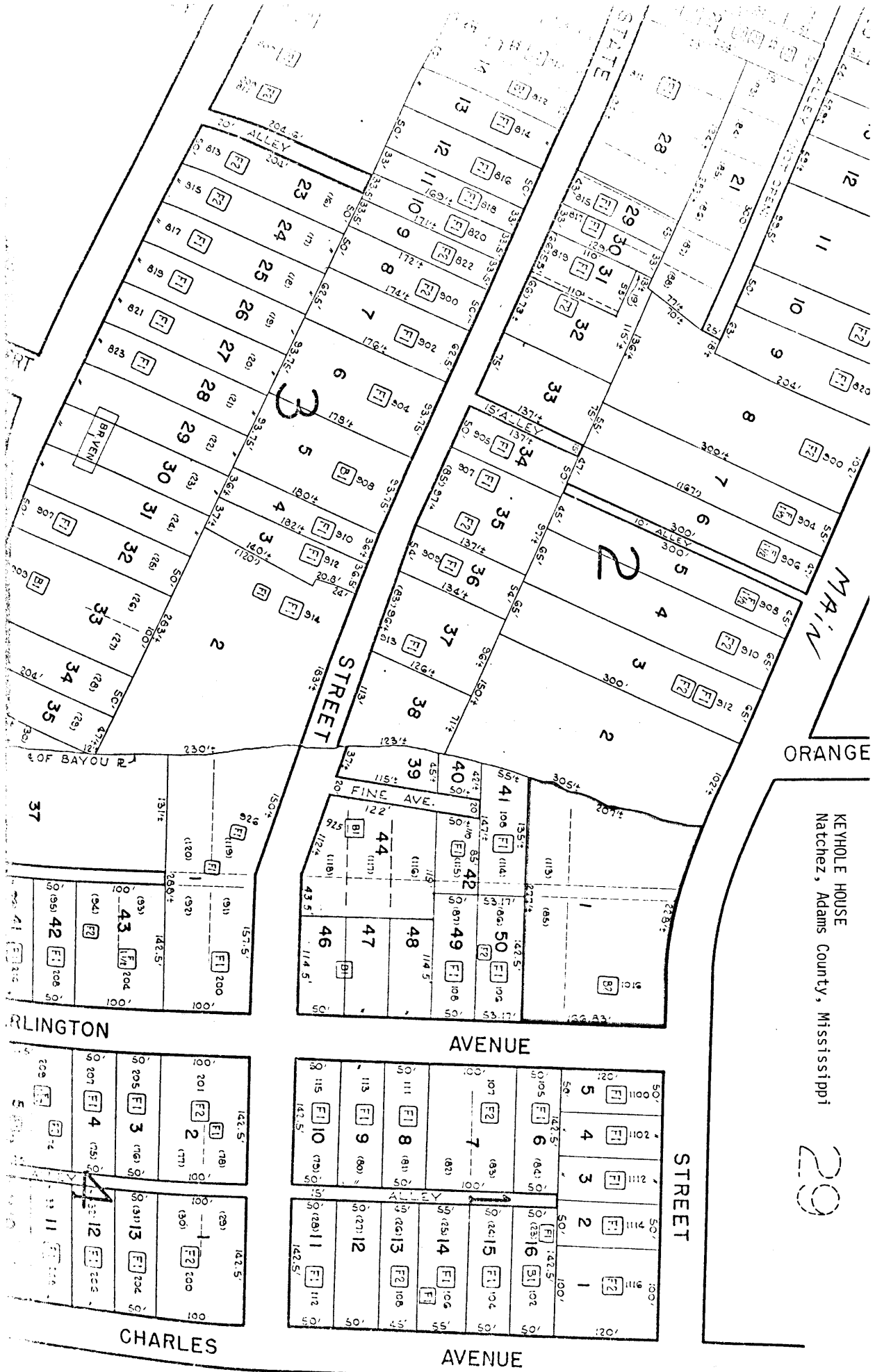

STATE STREET  
MAIN STREET  
ORANGE AVENUE  
CHARLES AVENUE  
STREET  
FINE AVE.  
BAYOU  
BR. VENT.  
KEYHOLE HOUSE  
Natchez, Adams County, Mississippi  
29



Keyhole House

Natchez, Adams County, Mississippi

Credit: Anabel Y. Maxie

1016 Main Street

Natchez, Mississippi 39120

December, 1980

View of the north (facade) and west  
elevations

Photo 1 of 3

FEB 23 1982





Keyhole House

Natchez, Adams County, Mississippi

Credit: Anabel Y. Maxie

1016 Main Street

Natchez, Mississippi 39120

December, 1980

View of the east and south (rear)

elevations

Photo 2 of 3

**FEB 23 1982**



Keyhole House

Natchez, Adams County, Mississippi

Credit: Anabel Y. Maxie

1016 Main Street

Natchez, Mississippi 39120

December, 1980

View of entrance hall and staircase  
from north

Photo 3 of 3

FEB 23 1982