

UNITED STATES DEPARTMENT OF THE INTERIOR
NATIONAL PARK SERVICE

PHO 673986

FOR NPS USE ONLY	
RECEIVED	MAY 1 1979
DATE ENTERED	MAY 3 1979

**NATIONAL REGISTER OF HISTORIC PLACES
INVENTORY -- NOMINATION FORM**

SEE INSTRUCTIONS IN *HOW TO COMPLETE NATIONAL REGISTER FORMS*
TYPE ALL ENTRIES -- COMPLETE APPLICABLE SECTIONS

1 NAME ✓

HISTORIC Hawthorne Place

AND/OR COMMON Hawthorne

2 LOCATION

STREET & NUMBER Hawthorne, Lower Woodville Road

CITY, TOWN Natchez VICINITY OF _____ NOT FOR PUBLICATION
CONGRESSIONAL DISTRICT Fourth

STATE Mississippi CODE 28 COUNTY Adams CODE 1

3 CLASSIFICATION

CATEGORY	OWNERSHIP	STATUS	PRESENT USE
<input type="checkbox"/> DISTRICT	<input type="checkbox"/> PUBLIC	<input checked="" type="checkbox"/> OCCUPIED	<input type="checkbox"/> AGRICULTURE <input type="checkbox"/> MUSEUM
<input checked="" type="checkbox"/> BUILDING(S)	<input checked="" type="checkbox"/> PRIVATE	<input type="checkbox"/> UNOCCUPIED	<input type="checkbox"/> COMMERCIAL <input type="checkbox"/> PARK
<input type="checkbox"/> STRUCTURE	<input type="checkbox"/> BOTH	<input type="checkbox"/> WORK IN PROGRESS	<input type="checkbox"/> EDUCATIONAL <input checked="" type="checkbox"/> PRIVATE RESIDENCE
<input type="checkbox"/> SITE	PUBLIC ACQUISITION	ACCESSIBLE	<input type="checkbox"/> ENTERTAINMENT <input type="checkbox"/> RELIGIOUS
<input type="checkbox"/> OBJECT	<input type="checkbox"/> IN PROCESS	<input checked="" type="checkbox"/> YES: RESTRICTED	<input type="checkbox"/> GOVERNMENT <input type="checkbox"/> SCIENTIFIC
	<input type="checkbox"/> BEING CONSIDERED	<input type="checkbox"/> YES: UNRESTRICTED	<input type="checkbox"/> INDUSTRIAL <input type="checkbox"/> TRANSPORTATION
		<input type="checkbox"/> NO	<input type="checkbox"/> MILITARY <input type="checkbox"/> OTHER:

4 OWNER OF PROPERTY ✓

NAME Mrs. Hyde Dunbar Jenkins

STREET & NUMBER Hawthorne, Lower Woodville Road

CITY, TOWN Natchez VICINITY OF _____ STATE Mississippi 39120

5 LOCATION OF LEGAL DESCRIPTION

COURTHOUSE, REGISTRY OF DEEDS, ETC. Office of the Chancery Clerk
Adams County Courthouse

STREET & NUMBER Courthouse Square

CITY, TOWN Natchez STATE Mississippi 39120

6 REPRESENTATION IN EXISTING SURVEYS

TITLE Statewide Survey of Historic Sites

DATE 1978 FEDERAL STATE COUNTY LOCAL

DEPOSITORY FOR SURVEY RECORDS Mississippi Department of Archives and History

CITY, TOWN Jackson STATE Mississippi 39205

7 DESCRIPTION

CONDITION		CHECK ONE	CHECK ONE
<input checked="" type="checkbox"/> EXCELLENT	<input type="checkbox"/> DETERIORATED	<input type="checkbox"/> UNALTERED	<input checked="" type="checkbox"/> ORIGINAL SITE
<input type="checkbox"/> GOOD	<input type="checkbox"/> RUINS	<input checked="" type="checkbox"/> ALTERED	<input type="checkbox"/> MOVED DATE _____
<input type="checkbox"/> FAIR	<input type="checkbox"/> UNEXPOSED		

DESCRIBE THE PRESENT AND ORIGINAL (IF KNOWN) PHYSICAL APPEARANCE

A gravel drive entered from the west side of Lower Woodville Road leads to Hawthorne Place, a story-and-a-half rectangular brick-nogged frame structure set upon a low brick foundation wall. The house is covered with clapboards except for the front wall, which is plastered and finished with a molded two-fasciae base. The broken front slope of the gabled roof is pierced by two interior brick chimneys. Three gabled dormers on the front slope and a large gabled dormer on the rear slope have been added recently. The five-bay facade is fronted by a gallery extending the full width of the house and supported by paneled wooden box columns with molded capitals without bases. The columns, linked by a railing composed of rectangular-sectioned balusters with molded handrail, are echoed on the front wall by pilasters at either end. A short flight of wooden steps with railings terminating in square newels leads from the gallery to the front walk.

Access to the interior is through a center doorway and one jib window, achieved by a simple splitting of an original window panel located in the northern end bay. The windows of the house, containing six-over-six double-hung sash, are set over molded panels on the facade and closed by shutter blinds. The entrance is composed of double-leaf eight-paneled molded doors set within an elaborately molded elliptical fanlight with keystone. Side lights are set above molded panels and flanked by symmetrically molded pilasters with molded capitals and bases.

The interior is basically a double-pile central-hall plan with cabinet rooms located at either end of a rear gallery, which appears to have been enclosed ca. 1830. The elaborate entrance is matched on the interior by the rear doorway and nearly matched in the two fanlighted doorways to the front rooms. The attached turned columns used in the design of the keystoned arch dividing the central hall are repeated in the mantel with oval paterae located in the northern front room. An unusual feature of the floor plan is the larger size of the two back rooms in relation to the more formal front rooms. The door and window surrounds of the four main rooms consist of symmetrically molded trim with corner blocks. All windows are set over molded panels, and the baseboards are molded with two fasciae. An original closet and Federal-style mantel are located in each of the large bedrooms.

The stairway, which runs back to front in a straight flight along the southerly wall of the hallway, is entered at the rear of the hall. The stair features a delicately turned newel and rectangular-sectioned balusters and terminates in a large upstairs hall with beaded base. Three bedrooms have been modernized, but their unfinished state indicates that they may have been intended originally to house servants or for storage.

Each cabinet room at the rear of the house contains a small bedroom and modern bath. A den was added recently across the three central bays of the rear. A three-bay-wide frame addition was added, apparently in the late 1830s, to the northerly wall of the house; this gabled-roof addition houses a modern kitchen and laundry. Other interesting features of the house are a stenciled floor, which has survived in a closet beneath the stairway, and original hardware from the 1820s and '30s.

Outbuildings consist of two notable frame structures, a barn and carriage house; a frame gabled-roof structure believed to have been a wash house; and a brick gabled-roof building probably originally used as a summer kitchen and dining room.

8 SIGNIFICANCE

PERIOD AREAS OF SIGNIFICANCE -- CHECK AND JUSTIFY BELOW

<input type="checkbox"/> PREHISTORIC	<input type="checkbox"/> ARCHEOLOGY-PREHISTORIC	<input type="checkbox"/> COMMUNITY PLANNING	<input type="checkbox"/> LANDSCAPE ARCHITECTURE	<input type="checkbox"/> RELIGION
<input type="checkbox"/> 1400-1499	<input type="checkbox"/> ARCHEOLOGY-HISTORIC	<input type="checkbox"/> CONSERVATION	<input type="checkbox"/> LAW	<input type="checkbox"/> SCIENCE
<input type="checkbox"/> 1500-1599	<input type="checkbox"/> AGRICULTURE	<input type="checkbox"/> ECONOMICS	<input type="checkbox"/> LITERATURE	<input type="checkbox"/> SCULPTURE
<input type="checkbox"/> 1600-1699	<input checked="" type="checkbox"/> ARCHITECTURE	<input type="checkbox"/> EDUCATION	<input type="checkbox"/> MILITARY	<input type="checkbox"/> SOCIAL/HUMANITARIAN
<input type="checkbox"/> 1700-1799	<input type="checkbox"/> ART	<input type="checkbox"/> ENGINEERING	<input type="checkbox"/> MUSIC	<input type="checkbox"/> THEATER
<input checked="" type="checkbox"/> 1800-1899	<input type="checkbox"/> COMMERCE	<input type="checkbox"/> EXPLORATION/SETTLEMENT	<input type="checkbox"/> PHILOSOPHY	<input type="checkbox"/> TRANSPORTATION
<input type="checkbox"/> 1900-	<input type="checkbox"/> COMMUNICATIONS	<input type="checkbox"/> INDUSTRY	<input type="checkbox"/> POLITICS/GOVERNMENT	<input type="checkbox"/> OTHER (SPECIFY)
		<input type="checkbox"/> INVENTION		

SPECIFIC DATES

BUILDER/ARCHITECT

STATEMENT OF SIGNIFICANCE

Hawthorne Place is an outstanding example of a Natchez Federal-style cottage. The marked contrast between its cottage-like exterior and the grand scale of its interior spaces, coupled with the fineness of its millwork, sets it apart from other Federal-style cottages in the area. Its brick-nogged frame construction is rare (only two other examples, Bedford Plantation and The Briers, are known to survive in the area), and its frame barn and carriage house are probably the oldest surviving buildings of their type in the vicinity of Natchez.

Documentary evidence supported by stylistic comparisons indicates that Hawthorne Place was constructed at some time between 1820 and 1827, most probably between 1825 and 1827, as the residence of Maria Overaker and her widowed mother, Margaret Overaker. The house was constructed on a sixty-acre tract once part of a large estate owned by George Overaker, wealthy landholder and owner of the White Horse Tavern (D. Clayton James, Antebellum Natchez [Baton Rouge: Louisiana State University Press, 1968], p. 188). When George Overaker died in 1820 (The Mississippi State Gazette, June 10, 1820, p.2), his estate was partitioned and divided among his widow and daughters, Maria and Elizabeth Tichenor (Mrs. Gabriel) (Adams Co., Miss., Deed Book L: 590). A plat map of an 1820 survey of Overaker's estate shows only two buildings on the estate, Hope Farm, the residence of George Overaker and a National Register of Historic Places property, and the White Horse Tavern (Deed Book P: 524). Hawthorne Place does not appear on the 1820 map.

In December, 1825, Maria Overaker and her sister Elizabeth Tichenor exchanged the tracts of land each had inherited from her father (Deed Book P: 216-17). The tract of land originally given to Elizabeth and later traded to Maria is the land upon which Hawthorne Place stands. In February, 1827, Margaret sold Hope Farm (Deed Book P: 525) and neither she nor Maria acquired any other property. Since the 1830 census lists Margaret Overaker as head of a household with one younger white female, she and her daughter Maria were probably residing at Hawthorne Place on the tract acquired in 1825 from Elizabeth Tichenor. Either Hawthorne Place was constructed by the Tichenors between 1820 and 1825 or, as is more likely, it was constructed between 1825, when Maria Overaker acquired the property, and 1827, when the Overakers sold Hope Farm. The 1820 and 1830 census records indicate that the Tichenors resided within the city limits of Natchez, where Gabriel Tichenor was cashier of the Bank Of Mississippi (James, pp. 198-99). In construction form and millwork Hawthorne Place resembles the National Register house The Briers, described as "new" in an 1825 newspaper advertisement (Mississippi State Gazette, Jan. 12, 1825, p. 1).

In 1833, Maria Overaker sold Hawthorne Place for \$10,000 to Robert Dunbar II (Deed Book GG: 583), son of Robert Dunbar, one of the earliest prominent settlers in the Natchez area. The property apparently acquired its historic name during the Dunbar ownership,

9 MAJOR BIBLIOGRAPHICAL REFERENCES

Adams, Co., Miss. Chancery Clerk. Deed Books L, P, GG, LL, 4W, 6G.

James, D. Clayton. Antebellum Natchez. Baton Rouge: Louisiana State University Press, 1968.

Mississippi State Gazette, Jan. 12, 1825.

10 GEOGRAPHICAL DATA

ACREAGE OF NOMINATED PROPERTY 12.23

QUADRANGLE NAME Natchez, Miss. - La.

QUADRANGLE SCALE 1: 24000

UTM REFERENCES

A

1	5	6	5	2	0	4	3	3	4	9	0	1	5	0
ZONE	EASTING							NORTHING						

B

1	5	6	5	2	0	4	3	3	4	9	0	0	0	0
ZONE	EASTING							NORTHING						

C

1	5	6	5	1	5	6	0	3	4	9	0	0	8	4
ZONE	EASTING							NORTHING						

D

1	5	6	5	1	6	3	0	3	4	9	0	4	7	5
ZONE	EASTING							NORTHING						

E

ZONE	EASTING							NORTHING						

F

ZONE	EASTING							NORTHING						

G

ZONE	EASTING							NORTHING						

H

ZONE	EASTING							NORTHING						

VERBAL BOUNDARY DESCRIPTION

See attached photocopy of city tax map. The nominated property is outlined in red and is located on Map 68, Block 2, Parcels 3 and 4.

LIST ALL STATES AND COUNTIES FOR PROPERTIES OVERLAPPING STATE OR COUNTY BOUNDARIES

STATE	CODE	COUNTY	CODE
STATE	CODE	COUNTY	CODE

11 FORM PREPARED BY

NAME / TITLE

Mary Warren Miller

Research Consultant

ORGANIZATION

Private Consultant

DATE

February 4, 1979

STREET & NUMBER

506 High Street

TELEPHONE

(601) 442-9786

CITY OR TOWN

Natchez

STATE

Mississippi 39120

12 STATE HISTORIC PRESERVATION OFFICER CERTIFICATION

THE EVALUATED SIGNIFICANCE OF THIS PROPERTY WITHIN THE STATE IS:

NATIONAL

STATE

LOCAL

As the designated State Historic Preservation Officer for the National Historic Preservation Act of 1966 (Public Law 89-665), I hereby nominate this property for inclusion in the National Register and certify that it has been evaluated according to the criteria and procedures set forth by the National Park Service.

STATE HISTORIC PRESERVATION OFFICER SIGNATURE

Elmer B. Williams

TITLE State Historic Preservation Officer

DATE

April 25, 1979

FOR NPS USE ONLY

I HEREBY CERTIFY THAT THIS PROPERTY IS INCLUDED IN THE NATIONAL REGISTER

7-2-79

DATE

3/2/79

KEEPER OF THE NATIONAL REGISTER

ATTEST

Janis H. Gilmore

DATE

7/2/79

CHIEF OF REGISTRATION

UNITED STATES DEPARTMENT OF THE INTERIOR
NATIONAL PARK SERVICE

**NATIONAL REGISTER OF HISTORIC PLACES
INVENTORY -- NOMINATION FORM**

FOR NPS USE ONLY	
RECEIVED	MAY 1 1979
DATE ENTERED	JUL 3 1979

CONTINUATION SHEET

ITEM NUMBER 8&9

PAGE 1

8 - SIGNIFICANCE

as the house is referred to by name in a Dunbar marriage notice of 1854 (Natchez Weekly Courier, May 3, 1854, p. 3) and in a deed of 1857 (Deed Book LL: 401).

In 1928, the McGehee family purchased Hawthorne Place (Deed Book 4W: 541), which was later partitioned to grant the house and thirteen acres to Carl A. McGehee (Deed Book 6G: 306). Today, the house is owned by Mr. McGehee's daughter, Mrs. Hyde Dunbar Jenkins, and is open as part of the spring Natchez Pilgrimage.

9 - MAJOR BIBLIOGRAPHICAL REFERENCES

Natchez Weekly Courier, May 3, 1854.

The Mississippi State Gazette, June 10, 1820.

United States. Bureau of the Census. Population Schedules, Adams Co., Miss., 1820, 1830.

66

56

BK 1

RECEIVED
 MAY 1 1979
 REGISTER
 TOWN

MISSISSIPPI
 CENTRAL

U.S. HWY. 65 & 84 BY-PASS

BK 1
 14
 megalip

BK 2

2
 28.73Ac
 (3)

3
 12.23Ac

4
 211.4'
 133'
 118'
 (B)

5
 211.8'
 143.3'
 211'
 146.6'
 (A)

6
 16.24Ac

HAWTHORNE PLACE
 MAP 68
 BLOCK 2
 PARCEL

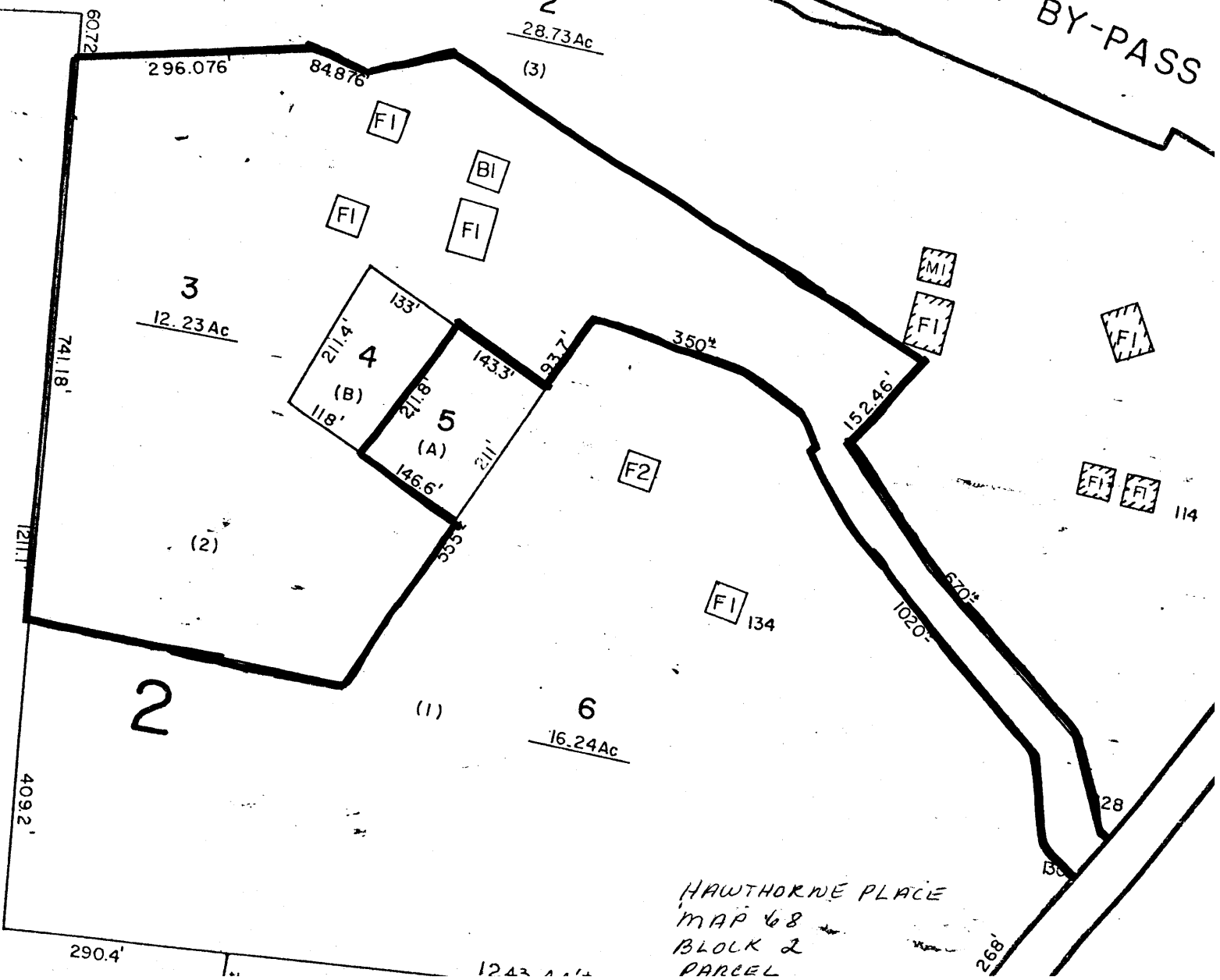

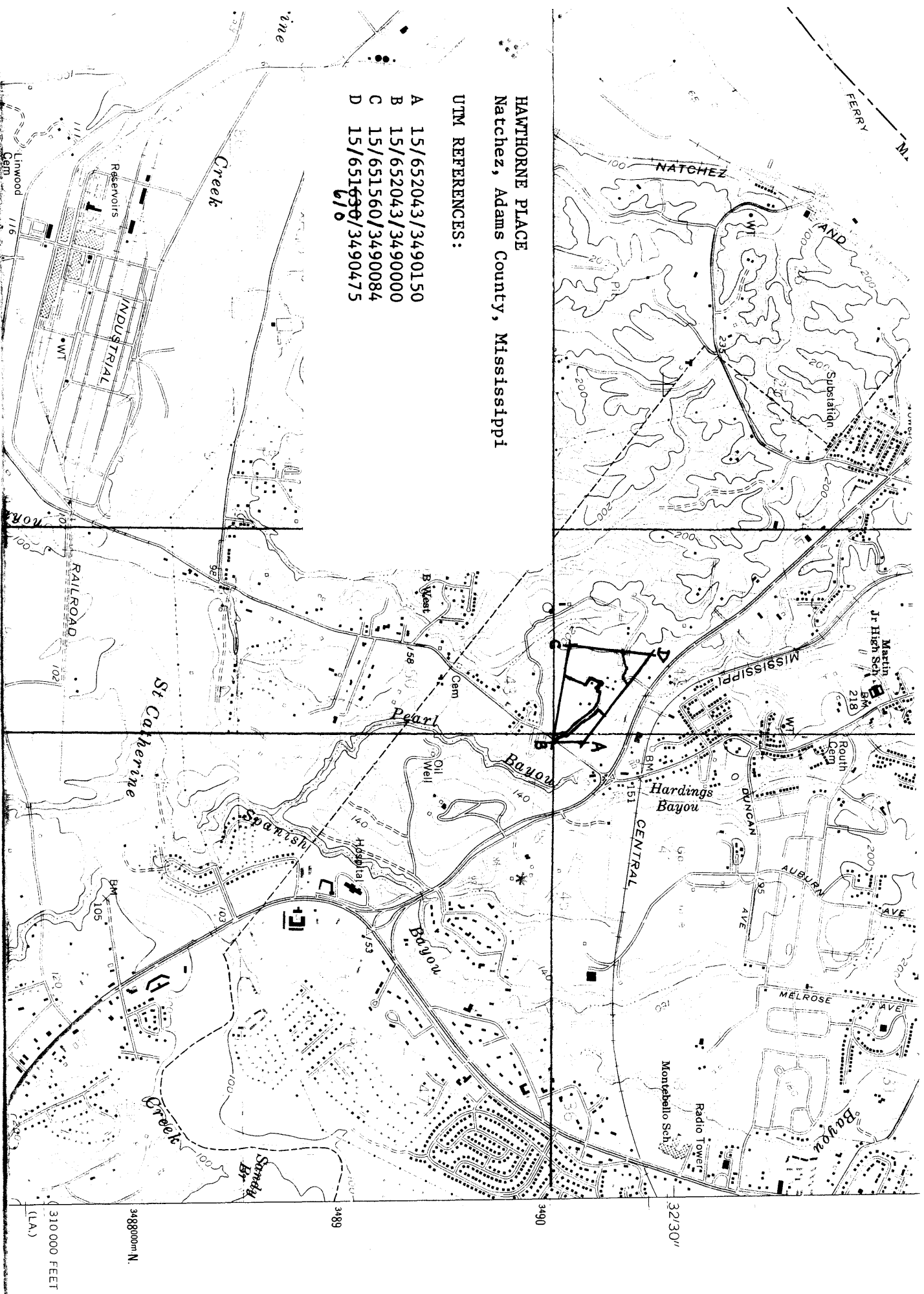

HAWTHORNE PLACE
 Natchez, Adams County, Mississippi

UTM REFERENCES:

- A 15/652043/3490150
- B 15/652043/3490000
- C 15/651560/3490084
- D 15/651590/3490475

310 000 FEET
 (L.A.)

3488000m N.

3489

3490

3230'



HAWTHORNE PLACE

Natchez, Adams County, Mississippi

Danny Richardson

January 29, 1979

Looking southwest, the facade and northern
addition to Hawthorne Place.

Photo 1 of 7

MAY 1 1979

pse
JUL 3 1979



HAWTHORNE PLACE

Natchez, Adams County, Mississippi

Danny Richardson

January 29, 1979

Looking easterly, the hallway and entrance
doorway of Hawthorne Place.

Photo 2 of 7

MAY 1 1979

DOE
JUL 3 1979



HAWTHORNE PLACE

Natchez, Adams County, Mississippi

Danny Richardson

January 29, 1979

Looking northwest, the facade and southern
wall of Hawthorne Place.

Photo 3 of 7

MAY 1 1979

DOE
JUL 3 1979



HAWTHORNE PLACE

Natchez, Adams County, Mississippi

Danny Richardson

January 29, 1979

Looking easterly, the rear of Hawthorne
Place, showing modern den enclosure on
the rear.

Photo 4 of 7

MAY 1 1979

DOE
JUL 3 1979



HAWTHORNE PLACE

Natchez, Adams County, Mississippi

Danny Richardson

January 29, 1979

Looking northerly, the brick dependency
which was probably the original summer
kitchen and dining room.

Photo 5 of 7

MAY 1 1979

JUL 3^{doc} 1979



HAWTHORNE PLACE

Natchez, Adams County, Mississippi

Danny Richardson

January 29, 1979

Looking northwest, an original frame
outbuilding with two-bay addition
located behind Hawthorne Place.

Photo 6 of 7

MAY 1 1979

JUL 3 1979
DOE



HAWTHORNE PLACE

Natchez, Adams County, Mississippi

Danny Richardson

January 29, 1979

Looking southwest, the frame carriage house
and barn behind Hawthorne Place.

Photo 7 of 7

MAY 1 1979

DOE
JUL 3 1979