

**NATIONAL REGISTER OF HISTORIC PLACES
INVENTORY - NOMINATION FORM**

(Type all entries - complete applicable sections)

STATE:
Mississippi

COUNTY:
Lowndes

FOR NPS USE ONLY

ENTRY NUMBER	DATE
715.28.0001	5/6/71

1. NAME

COMMON:
S. D. Lee House

AND/OR HISTORIC:
Blewett-Harrison-Lee House

2. LOCATION

STREET AND NUMBER:
314 North Seventh Street

CITY OR TOWN:
Columbus

STATE	CODE	COUNTY:	CODE
Mississippi	39701	Lowndes	087

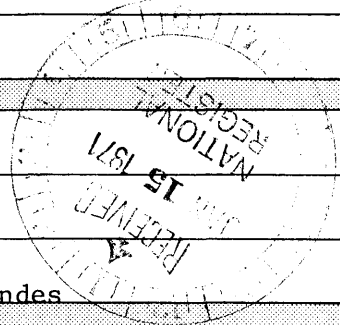

3. CLASSIFICATION

CATEGORY (Check One)	OWNERSHIP	STATUS	ACCESSIBLE TO THE PUBLIC
<input type="checkbox"/> District <input type="checkbox"/> Site <input type="checkbox"/> Object <input checked="" type="checkbox"/> Building	<input checked="" type="checkbox"/> Public <input type="checkbox"/> Private <input type="checkbox"/> Both	Public Acquisition: <input type="checkbox"/> In Process <input type="checkbox"/> Being Considered	Yes: <input type="checkbox"/> Restricted <input checked="" type="checkbox"/> Unrestricted <input type="checkbox"/> No
PRESENT USE (Check One or More as Appropriate)			
<input type="checkbox"/> Agricultural <input type="checkbox"/> Commercial <input type="checkbox"/> Educational <input type="checkbox"/> Entertainment	<input type="checkbox"/> Government <input type="checkbox"/> Industrial <input type="checkbox"/> Military <input checked="" type="checkbox"/> Museum	<input type="checkbox"/> Park <input type="checkbox"/> Private Residence <input type="checkbox"/> Religious <input type="checkbox"/> Scientific	<input type="checkbox"/> Transportation <input checked="" type="checkbox"/> Other (Specify) <u>Entertainment</u>

4. OWNER OF PROPERTY

OWNER'S NAME:
Columbus Separate School District

STREET AND NUMBER:
501 North Third Avenue

CITY OR TOWN:
Columbus

STATE:	CODE
Mississippi	28

5. LOCATION OF LEGAL DESCRIPTION

COURTHOUSE, REGISTRY OF DEEDS, ETC.:
Courthouse of Lowndes County, Chancery Clerk's Office

STREET AND NUMBER:
South Second Avenue

CITY OR TOWN:
Columbus

STATE	CODE
Mississippi	28

6. REPRESENTATION IN EXISTING SURVEYS

TITLE OF SURVEY:
Historic American Buildings Survey

DATE OF SURVEY: 1936
 Federal
 State
 County
 Local

DEPOSITORY FOR SURVEY RECORDS:
Division of Prints and Photographs

STREET AND NUMBER:
Library of Congress

CITY OR TOWN:
Washington

STATE:	CODE
District of Columbia	08

SEE INSTRUCTIONS

STATE: Mississippi
COUNTY: Lowndes
ENTRY NUMBER: 715.28.0001
DATE: 5/6/71
FOR NPS USE ONLY

7. DESCRIPTION

CONDITION	(Check One)					
	<input type="checkbox"/> Excellent	<input checked="" type="checkbox"/> Good	<input type="checkbox"/> Fair	<input type="checkbox"/> Deteriorated	<input type="checkbox"/> Ruins	<input type="checkbox"/> Unexposed
	(Check One)			(Check One)		
	<input checked="" type="checkbox"/> Altered	<input type="checkbox"/> Unaltered	<input type="checkbox"/> Moved	<input checked="" type="checkbox"/> Original Site		

DESCRIBE THE PRESENT AND ORIGINAL (if known) PHYSICAL APPEARANCE

The Blewett-Harrison-Lee House is a large two story house that represents the influence of late Georgian architecture combined with Greek Revival. The house was built in the mid-1840s by Major Thomas G. Blewett.

Originally, there was a large glassed-in conservatory opening into the drawing room on the south side. This conservatory was about one and a half stories high. Also, there had been a broad one story wing on the north side containing the master bedroom with elaborately frescoed ceiling. The ceilings on the first floor were approximately fourteen feet in height, while the ceiling on the second floor were fourteen and a half feet in height. Also, the original roof made of copper has been replaced with a more modern type roof.

The house, leased by the Stephen D. Lee Foundation in 1960, is currently undergoing limited restoration, and is the headquarters of the Columbus Pilgrimage.

SEE INSTRUCTIONS



6. SIGNIFICANCE

PERIOD (Check One or More as Appropriate)

- Pre-Columbian | 16th Century | 18th Century | 20th Century
 15th Century | 17th Century | 19th Century

SPECIFIC DATE(S) (If Applicable and Known) ca. 1847

AREAS OF SIGNIFICANCE (Check One or More as Appropriate)

- | | | | |
|--|---|--|---|
| <input type="checkbox"/> Aboriginal | <input type="checkbox"/> Education | <input type="checkbox"/> Political | <input type="checkbox"/> Urban Planning |
| <input type="checkbox"/> Prehistoric | <input type="checkbox"/> Engineering | <input type="checkbox"/> Religion/Philosophy | <input checked="" type="checkbox"/> Other (Specify) |
| <input type="checkbox"/> Historic | <input type="checkbox"/> Industry | <input type="checkbox"/> Science | <u>Museum</u> |
| <input type="checkbox"/> Agriculture | <input type="checkbox"/> Invention | <input type="checkbox"/> Sculpture | <u>Architectural</u> |
| <input checked="" type="checkbox"/> Architecture | <input type="checkbox"/> Landscape Architecture | <input type="checkbox"/> Social/Humanitarian | _____ |
| <input type="checkbox"/> Art | <input type="checkbox"/> Literature | <input type="checkbox"/> Theater | _____ |
| <input type="checkbox"/> Commerce | <input checked="" type="checkbox"/> Military | <input type="checkbox"/> Transportation | _____ |
| <input type="checkbox"/> Communications | <input type="checkbox"/> Music | | _____ |
| <input type="checkbox"/> Conservation | | | _____ |

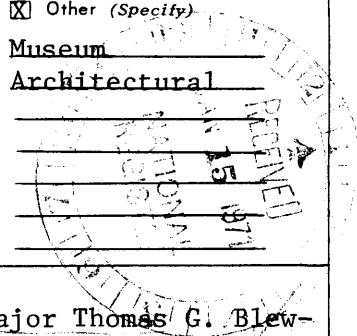

STATEMENT OF SIGNIFICANCE

The Blewett-Harrison-Lee House was built by Major Thomas G. Blewett (1789-1871) in the mid-1840s. Major Blewett, who moved to the Columbus area in 1832, was a prominent and benevolent citizen of the community.

In 1840, Blewett's oldest daughter married James T. Harrison, who is noted for his role in helping to establish rights for women under State law. He was also selected by the Mississippi Secession Convention as a delegate to the Confederate Convention in Montgomery, Alabama, in 1861. Harrison was a member of the Confederate Congress; and, in 1865 was elected to the Federal Congress, but was refused admission along with the rest of the Mississippi delegation. The Mississippi Bar Association selected him to defend Jefferson Davis, if Davis were tried by the United States Government.

Upon the death of his father-in-law in 1871, Harrison moved into the Blewett House and lived there until his death in 1879. His widow continued to live in the house until her death in 1890.

After the death of Mrs. Harrison, the house was occupied by General Stephen D. Lee (1833-1903), and his wife, who was the granddaughter of Major Thomas Blewett. General Lee was a graduate of West Point, Class of 1854. He also served in the United States Army, as well as the Confederate Army. He is considered by many historians to have given the first order to fire on Fort Sumter. Lee advanced to the rank of lieutenant general and took part in the battles of Richmond, Second Manassas, Sharpsburg, Vicksburg, Tupelo, Atlanta, Franklin, and Nashville. After the war, he was selected to be the first President of the Agricultural and Mechanical College of Mississippi, which has now become Mississippi State University. Lee remained at this post until 1899, when he accepted a position as a member of the Vicksburg National Park Association. He also served as the Commander of the United Confederate Veterans. General Lee's other achievements included serving as president of the Mississippi Historical Society, authoring numerous articles, and serving on the Board of Trustees of the Mississippi Department of Archives and History.

Through the years the Blewett-Harrison-Lee House has been a social center for the Columbus area. General Leonidas Polk was entertained here during the Civil War. The house also served as headquarters for Confederate Generals S. D. Lee, N. B. Forrest, and W. H. Jackson. In 1911, the house was the scene of a reception for President William H. Taft during his visit to Columbus. The house in 1915 became the property of General Lee's only

SEE INSTRUCTIONS

9. MAJOR BIBLIOGRAPHICAL REFERENCES

Columbus Pilgrimage. (Columbus, Mississippi, 1942), 51.

Conversation with Robert C. Jones, Mississippi Department of Education, Jackson, Mississippi, December 12, 1970.

Lipscomb, William, A History of Columbus Mississippi. (Birmingham, Ala.: Press of Dispatch, 1909), 118-120.

Moulder, Bob and Conway, Sigrid, Shrines to Yesterday. (1968), 3.

10. GEOGRAPHICAL DATA

LATITUDE AND LONGITUDE COORDINATES DEFINING A RECTANGLE LOCATING THE PROPERTY				OR	LATITUDE AND LONGITUDE COORDINATES DEFINING THE CENTER POINT OF A PROPERTY OF LESS THAN TEN ACRES													
CORNER	LATITUDE				LONGITUDE			LATITUDE			LONGITUDE							
	Degrees	Minutes	Seconds	Degrees	Minutes	Seconds	Degrees	Minutes	Seconds	Degrees	Minutes	Seconds						
NW	°	'	"	°	'	"	33	°	29	'	54	"	88	°	25	'	32	"
NE	°	'	"	°	'	"												
SE	°	'	"	°	'	"												
SW	°	'	"	°	'	"												

APPROXIMATE ACREAGE OF NOMINATED PROPERTY: 2.5 acres

LIST ALL STATES AND COUNTIES FOR PROPERTIES OVERLAPPING STATE OR COUNTY BOUNDARIES

STATE:	CODE	COUNTY	CODE
STATE:	CODE	COUNTY:	CODE
STATE:	CODE	COUNTY:	CODE
STATE:	CODE	COUNTY:	CODE

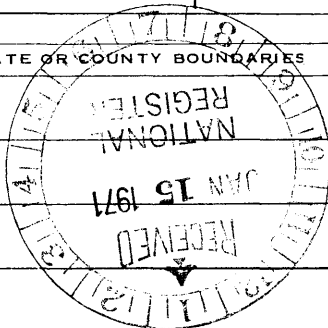

11. FORM PREPARED BY

NAME AND TITLE:
Clinton I. Bagley, Junior Historian

ORGANIZATION: Miss. Department of Archives and History DATE: 12/18/70

STREET AND NUMBER:
P. O. Box 571

CITY OR TOWN: Jackson STATE: Mississippi 39205 CODE: 28

12. STATE LIAISON OFFICER CERTIFICATION

As the designated State Liaison Officer for the National Historic Preservation Act of 1966 (Public Law 89-665), I hereby nominate this property for inclusion in the National Register and certify that it has been evaluated according to the criteria and procedures set forth by the National Park Service. The recommended level of significance of this nomination is:

National State Local

Name: R. A. McLemore
R. A. McLemore

Title: Director, Miss. Department of Archives and History

Date: _____

I hereby certify that this property is included in the National Register.

Ernest A. Connelly
Chief, Office of Archeology and Historic Preservation

MAY 6 1971

Date: _____

ATTEST:
William M. ...
Keeper of The National Register

Date: **APR 8 1971**

SEE INSTRUCTIONS

**NATIONAL REGISTER OF HISTORIC PLACES
INVENTORY - NOMINATION FORM**

(Continuation Sheet)

STATE	
Mississippi	
COUNTY	
Lowndes	
FOR NPS USE ONLY	
ENTRY NUMBER	DATE
71,528.0001	5/6/71

(Number all entries)

8.

son, Blewett Lee, who in turn, sold the house in the same year to the City of Columbus with the restriction that the property be used for educational purposes.

In 1917, the house was made a part of the S. D. Lee High School and was converted into classroom use until 1959. In 1960, the Board of the Columbus Separate School District leased the house to the Stephen D. Lee Foundation, and it is currently used for exhibitions, social activities, educational and civic meetings, as well as a museum and headquarters for the Columbus Pilgrimage. Since 1960, limited restoration of the house has been accomplished.

9.

Rowland, Dunbar, Mississippi. (n.p.: Southern Historical Association, 1916), II, 69-70.

Subject file, "General S. D. Lee." Collections of the Mississippi Department of Archives and History.

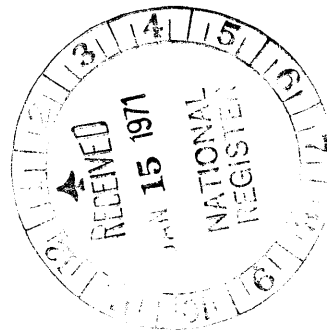

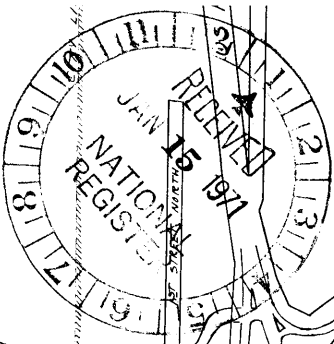

33° 29' 54"

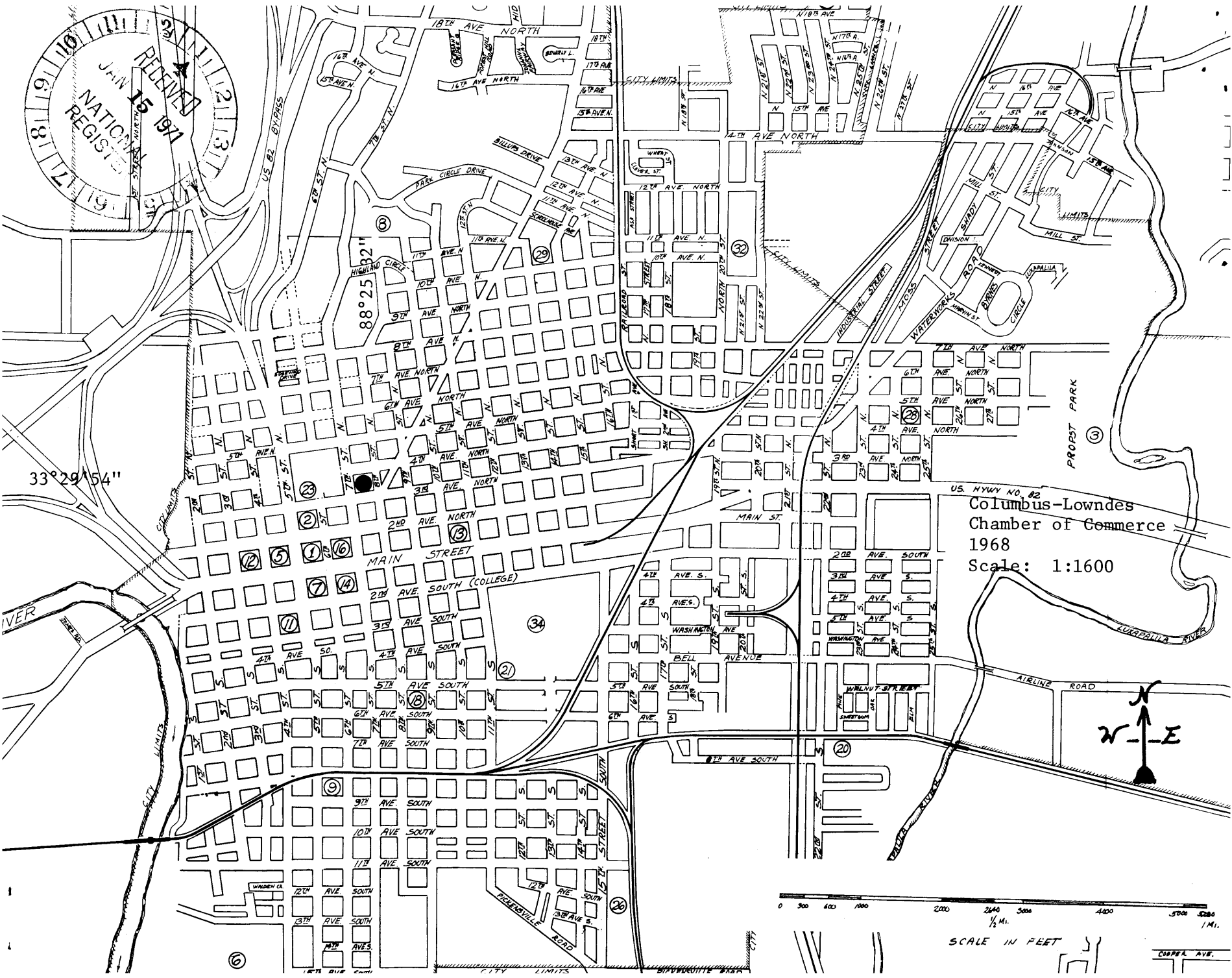

US. HWY. NO. 82
Columbus-Lowndes
Chamber of Commerce
1968
Scale: 1:1600

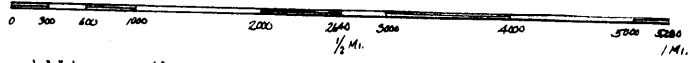
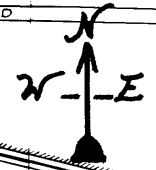

SCALE IN FEET

COOPER AVE.



DIVELBISS
BOOK EXCHANGE

UNITED STATES DEPARTMENT OF THE INTERIOR
NATIONAL PARK SERVICE

NATIONAL REGISTER OF HISTORIC PLACES
PROPERTY PHOTOGRAPH FORM

(Type all entries - attach to or enclose with photograph)

STATE Mississippi	
COUNTY Lowndes	
FOR NPS USE ONLY	
ENTRY NUMBER 71.5.28.0001	DATE 5/6/71

1. NAME

COMMON: Stephen D. Lee House

AND/OR HISTORIC: Blewett-Harrison-Lee House

2. LOCATION

STREET AND NUMBER:

314 North Seventh Street

CITY OR TOWN:

Columbus

STATE:

Mississippi

CODE

28

COUNTY:

Lowndes

CODE

087

3. PHOTO REFERENCE

PHOTO CREDIT: From subject file of the Department of Archives and History

DATE OF PHOTO: ca. 1904

NEGATIVE FILED AT:

Department of Archives and History, Jackson, Mississippi

4. IDENTIFICATION

DESCRIBE VIEW, DIRECTION, ETC.

Front facade of building, and conservatory on south side of the house, looking east.

SEE INSTRUCTIONS



UNITED STATES DEPARTMENT OF THE INTERIOR
NATIONAL PARK SERVICE

NATIONAL REGISTER OF HISTORIC PLACES

PROPERTY PHOTOGRAPH FORM

(Type all entries - attach to or enclose with photograph)

STATE Mississippi	
COUNTY Lowndes	
FOR NPS USE ONLY	
ENTRY NUMBER 715.28.0001	DATE 5/6/71

1. NAME

COMMON: S. D. Lee House

AND/OR HISTORIC: Blewett-Harrison-Lee House

2. LOCATION

STREET AND NUMBER:

314 North Seventh Street

CITY OR TOWN:

Columbus

STATE:

Mississippi

CODE

28

COUNTY:

Lowndes

CODE

087

3. PHOTO REFERENCE

PHOTO CREDIT: Mary Jane Owen

DATE OF PHOTO: September, 1970

NEGATIVE FILED AT:

Mary Jane Owen, 9th Street South, Columbus, Mississippi

4. IDENTIFICATION

DESCRIBE VIEW, DIRECTION, ETC.

Front facade of building looking east.

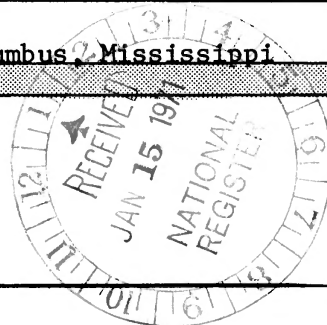

SEE INSTRUCTIONS



UNITED STATES DEPARTMENT OF THE INTERIOR
NATIONAL PARK SERVICE

NATIONAL REGISTER OF HISTORIC PLACES
PROPERTY PHOTOGRAPH FORM

(Type all entries - attach to or enclose with photograph)

STATE

Mississippi

COUNTY

Lowndes

FOR NPS USE ONLY

ENTRY NUMBER

DATE

71.5.28.0001

5/6/71

1. NAME

COMMON: S. D. Lee House

AND/OR HISTORIC: Blewett-Harrison-Lee House

2. LOCATION

STREET AND NUMBER:

314 North Seventh Street

CITY OR TOWN:

Columbus

STATE:

Mississippi

CODE

28

COUNTY:

Lowndes

CODE

087

3. PHOTO REFERENCE

PHOTO CREDIT: Mary Jane Owen

DATE OF PHOTO: September, 1970

NEGATIVE FILED AT:

Mary Jane Owen, 9th Street South, Columbus, Mississippi

4. IDENTIFICATION

DESCRIBE VIEW, DIRECTION, ETC.

Front facade and south side looking northeast.

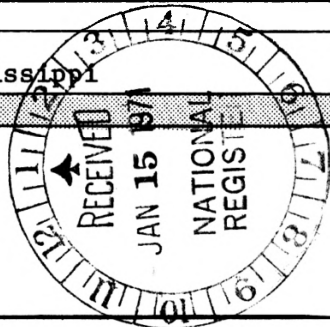

SEE INSTRUCTIONS